

State of Carolina (1785)

Pursuant to the Warrant from John Thomas Esq. Com. of Locations Dated the 30th of April 1785. I have admeasured & laid out unto Richard Childs a tract of three hundred acres situated in 96 District N. side Saluda West of the old Boundary, on the Branches of Lewis Creek of Needy River, bounding E. on Childs Lewis's Land, all other sides Vacant Land and hath such Shape & marks as the above Plat represents. Survey the 3rd May 1785

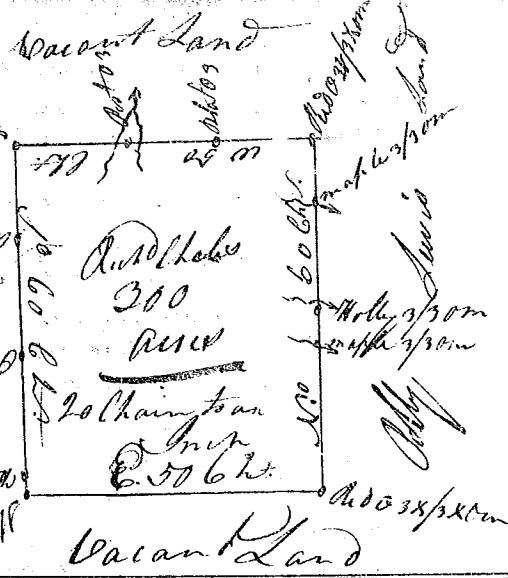

Recorded the 23rd May 1785  
 Det. to Joseph Whitmer  
 Joseph Whitmer Esq.

State of Carolina 96 District, N. of the old boundary line, Pursuant to a warrant from John Thomas Commissioner of Locations dated the 7th April 1785, I have admeasured and laid out unto Levi Casey a tract of one hundred and fourteen acres on the North Side of the S<sup>o</sup> fork of Tugger River joining the mountain bounded N. E. & S. E. by Randolph Casey's land, all other sides Vacant Land, and hath such Shape and Marks as the above plat represents. Survey the 3 May 1785. by Andrew Thomson, D.S.  
 Recorded the 23<sup>rd</sup> May 1785.

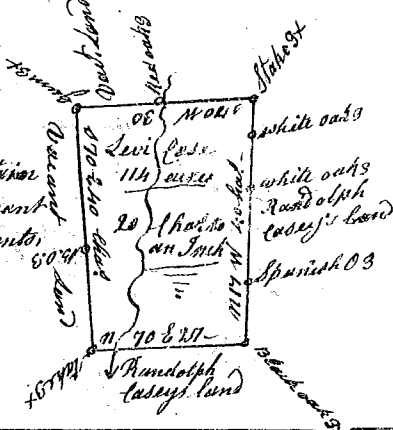

State of Carolina Ninety Six District Pursuant to a warrant from John Thomas Esq. Com. Locations Dated the 9<sup>th</sup> day of April 1785. I have admeasured & laid out unto Thomas Park a tract of Land containing two Hundred & fifty nine acres N. of Saluda. Situated lying and being on Branches of Purbing Creek Waters of Enoree River bounded N. by J. Walker's more & by John Brown's more S. by Andrew Williams & John Wall's and bounded by old lines all other sides Vacant Land. & hath such Shape & marks as the above Plat represents. Survey this 16 May 1785  
 Recorded the 23<sup>rd</sup> May 1785  
 Det. to John Brown  
 James Wofford Esq.

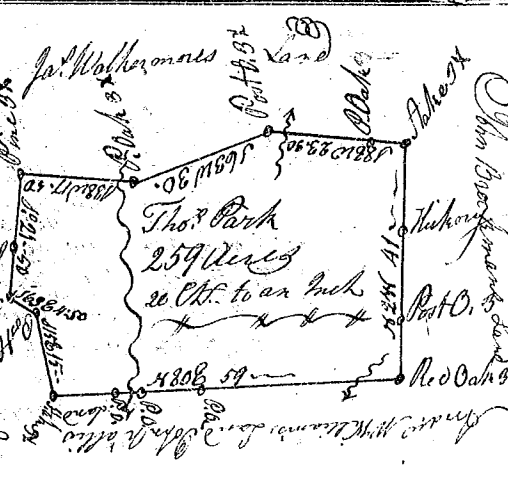

State of South Carolina, Pursuant to a warrant from John Thomas Commissioner of Locations N. of Saluda I have admeasured and laid out unto Daniel Blackwell a tract of two hundred acres of land on the County situated in ninety six district, on the head branches of Enoree, being and bounding, and hath such other shape and marks as the above plat represents. Survey the 22<sup>nd</sup> April 1785.  
 Recorded 23<sup>rd</sup> May 1785.  
 Robert Prince Esq.

