

State of S<sup>c</sup> Carolina, —

125

Pursuant to a warrant from John Thomas Esq.

Commissioner of Locations dated the 14th April 1785, —  
I have admeasured and laid out unto John White a tract of Land containing Two hundred and fifty two acres, situate in Ninety six District on the waters of fairforest &c East of the Indian Boundary line, bounded W & NW by Samuel Clowneys land, N<sup>o</sup> by John Mikes land & by Thos Mays land S.E. by Eugles Land, and hath such shape and Marks as the above Plat represents,

Survey, the 2<sup>o</sup> May 1785 by Jesse Connel Esq.

Recorded 18 May 1785, —

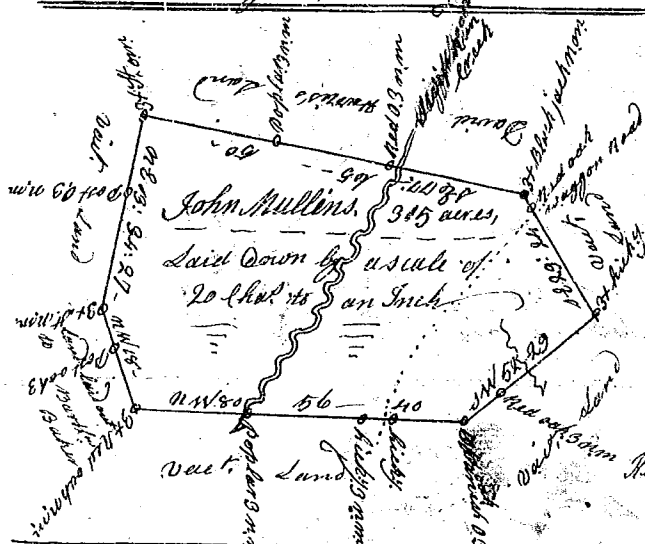

State of S<sup>c</sup> Carolina  
Pursuant to a warrant from John Thomas Esq. Commissioner of Locations, I have admeasured and laid out unto John Mullins a tract of three hundred and fifteen acres of Land, situate in Ninety six District on Swift Run Creek a branch of Tupper Rivers, and hath such shape and Marks, Buildings and bounding as the above Plat represents,  
Survey, the 26<sup>o</sup> April 1785, —

Recorded 18<sup>o</sup> May 1785, — Ber<sup>o</sup> Glenn Esq.

State of S<sup>c</sup> Carolina 96 District East of the 6<sup>o</sup> Boundary

Pursuant to a warrant from John Thomas Commissioner of Locations dated 9 March 1785, I have admeasured and laid out unto Samuel Helles a tract of three hundred and seventeen acres of lands, on both sides of fairforest creek including the Place said Sam<sup>l</sup> Helles liveth on, bounded N<sup>o</sup> by George Story's land, East by John Foster's land & partly by James M<sup>o</sup> Ellicean's land, W & by Joseph Helles's land and Henry Foster's land, and hath such shape and Marks as the above Plat represents

Survey, the 11<sup>o</sup> day of March 1785, —  
Recorded the 18<sup>o</sup> May 1785, — Andrew Thomson Esq.

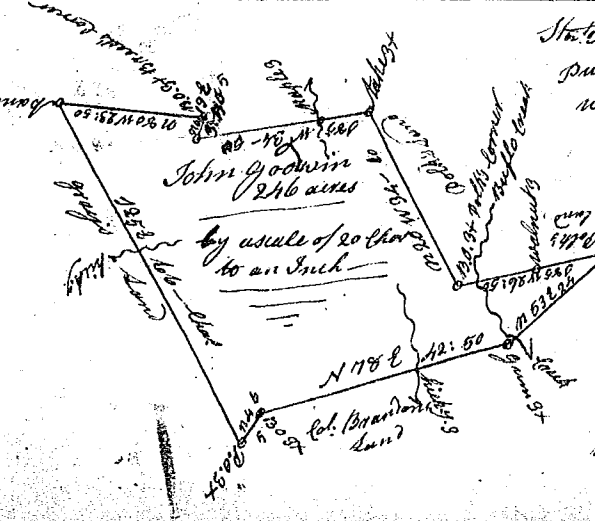
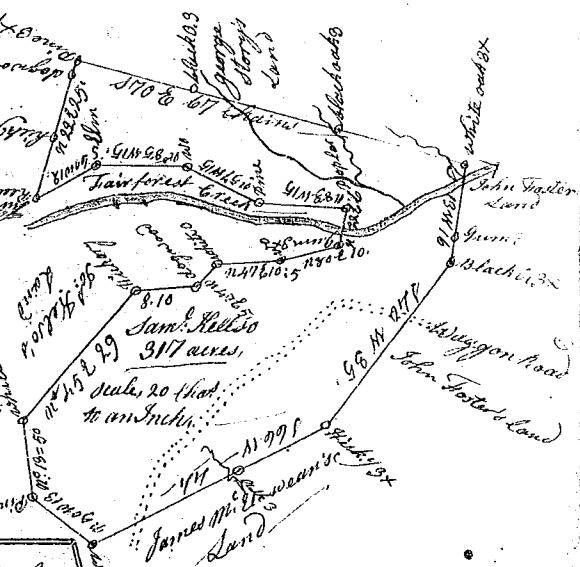

State of S<sup>c</sup> Carolina  
Pursuant to a warrant from John Thomas Commissioner of Locations dated 13 April 1785, I have admeasured and laid out unto John Goodwin a tract of two hundred and forty six acres of Land, in ninety six District, on the waters of fairforest creek, East of the Indian Boundary, bounded N. by Polk, Hartin & Breed's land S.W. by Gray, S.E. by Col. Brandons land, and has such form and Marks as the above Plat represents.

Survey, 14<sup>o</sup> April 1785 by Jesse Connel Esq.  
Recorded 18 May 1785