

State of South Carolina Pursuant to a Warrant from John Thomas Commissioner of Locations, dated the 12th March 1785. I have admeasured and laid out unto William Jameson a tract of two hundred acres of Land situate in Ninety six District, on both sides of old Boundary, and both sides of Mill Creek of Pacolale River, and hath such shape marks Buttings and Boundings as the above plat represents recorded 18th May 1785.

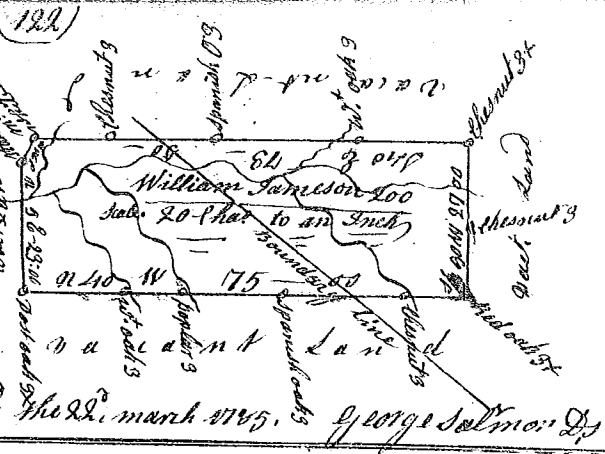

Surveyed the 22<sup>nd</sup> March 1785. by George Salmon D<sup>ty</sup>

State of South Carolina

Pursuant to a warrant from John Thomas Commissioner of Locations. Dated 2<sup>nd</sup> March 1785, I have admeasured and laid out unto John Ballinger a tract of Two hundred and seventy five acres of land situate in ninety six District East of the old Boundary on both sides of a branch of Shoaly Creek of Lawsons fork waters of Pacolale River, and hath such shape, marks, Buttings, and Boundings as the above Plat represents.

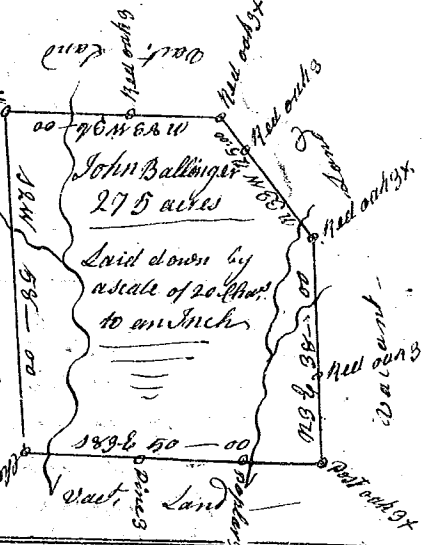

Surveyed 3<sup>rd</sup> March 1785 by George Salmon D<sup>ty</sup>

Recorded the 18<sup>th</sup> May 1785.

State of S<sup>c</sup> Carolina

Pursuant to a Warrant from John Thomas Esq<sup>r</sup> Com<sup>r</sup> of Locations Dated the 21<sup>st</sup> of January 1785. I have admeasured & laid out unto Richard Harrison a Tract of two Hundred and Eight acres of Land situate in Ninety six District East of the Old Boundary, on both sides of Fair Forrest Creek of Tygar River and hath such form marks Buttings and Boundings as the annexed Map Represents. Surveyed the 2<sup>nd</sup> March 1785

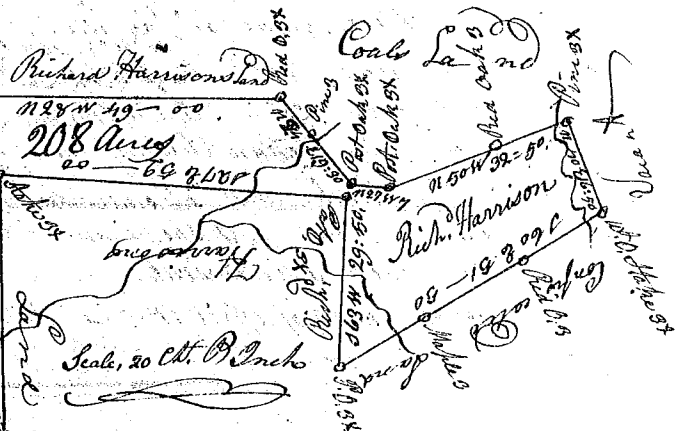

Recorded 18<sup>th</sup> May 1785 by George Salmon D<sup>ty</sup>

State of S<sup>c</sup> Carolina

Pursuant to a Warrant from John Thomas Esq<sup>r</sup> Com<sup>r</sup> Locations Dated the 18<sup>th</sup> Day of March 1785. I have admeasured & laid out unto John Gibby a Tract of Three Hundred acres of Land situate in Ninety six District East of the Old Boundary on both sides of the Bridge fork of such Creek waters of Broad River, & hath such shape marks Buttings & Boundings as the annexed Map Represents

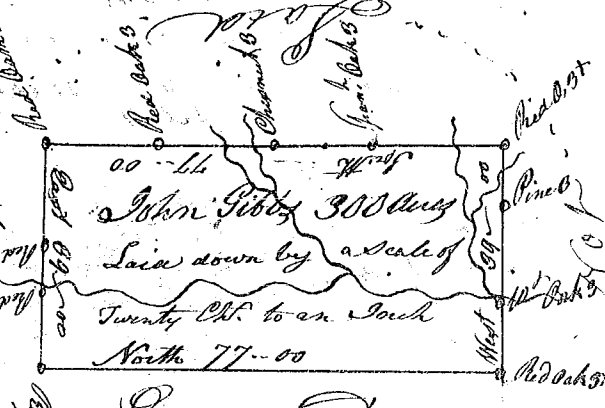

Surveyed the 25<sup>th</sup> March 1785

Recorded 18<sup>th</sup> May 1785 by George Salmon D<sup>ty</sup>

LAND