

State of S^c Carolina 9th District West of the old Boundary,
Pursuant to a warrant from John Thomas Esq^r.

Commissioner of Locations Dated the 25 day
of February 1785, I have admeasured and laid
out unto Sean McJunkin tract of Land con-
taining Two hundred and fifty acres, lying on
both sides of Meelys Creek a branch of saluda River
Bouding N.W. by John Beck's land S.W. by George
Salmon's Land, all other sides Vacant Land, and hath
such shape and Marks as the above Plat Represents,
Survey^d the 25th day of February 1785
Recorded the 16th May 1785. by Andrew Thomson D^s.

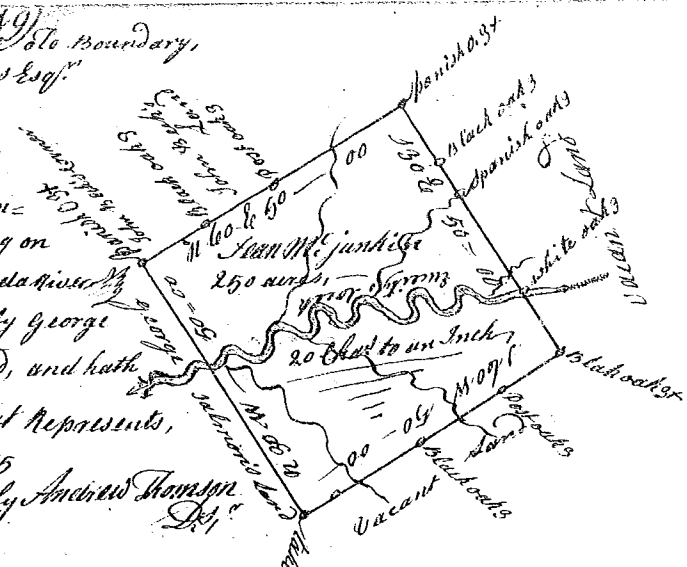

State of S^c Carolina 9th District East side the old Boundary line,
Pursuant to a warrant from John Thomas Esq^r Commissioner
of Locations dated the 7th day of March 1785, I have admeasured and
Laid out unto Alexander Alexander tract of land containing forty seven
acres, lying on a small branch of Jamies Creek, Bounded so by Moses M^c Farley
Land, E. by Jacob Earnest and n^o. by John Lewis's Land, W. by said alexander
Land, and hath such shape and Marks as the above Plat Represents,
Survey^d the 10th March 1785,
Recorded the 16th May 1785, by Andrew Thomson D^s.

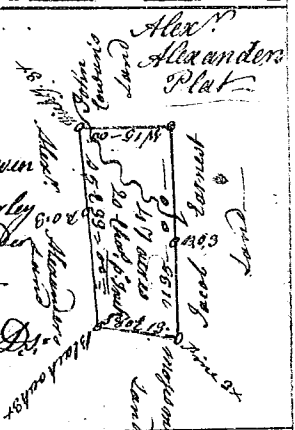

State of S^c Carolina 9th District East of the old Boundary line,
Pursuant to a warrant from John Thomas Commissioner
of Locations dated the 26th Jan^y 1785, I have admeasured
and laid out unto John King tract of Land containing
one Hundred and twenty acres, lying on the small branches
of Jamies Creek, bounded E. by Nicholas Hallig's Land, N.
by said John King's Land S.W. by Sean M^c Clurkin's Land
and Benjamin Bussey's Land, E. by Vac. Land, and hath
such shape and Marks as the above Plat Represents,
Survey^d the 28 Jan^y 1785, by Andrew Thomson D^s.
Recorded 16th May 1785

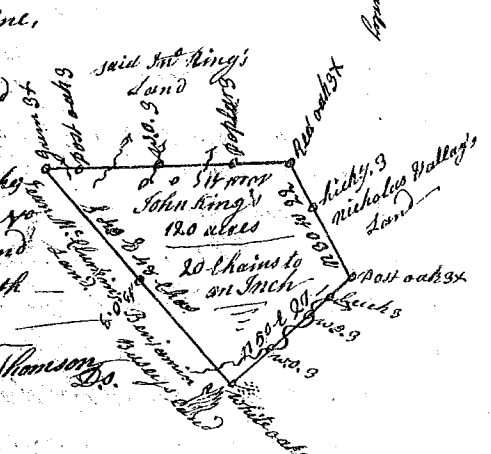

State of S^c Carolina 9th District, East side old Boundary line
Pursuant to a warrant from John Thomas Esq^r Commissioner
of Locations dated the 26th January 1785, I have admeasured
and laid out unto John King tract of Land containing
one Hundred acres, lying on the small branches of
Jamies Creek, bounded W. by David Dunsmore's Land
N^o by an old line E^t by Vacant Land S^o by said John
King's Land; and hath such shape and Marks as the a
bove plat Represents Survey^d 28th Jan^y 1785, by Andrew
Recorded 17th May 1785.

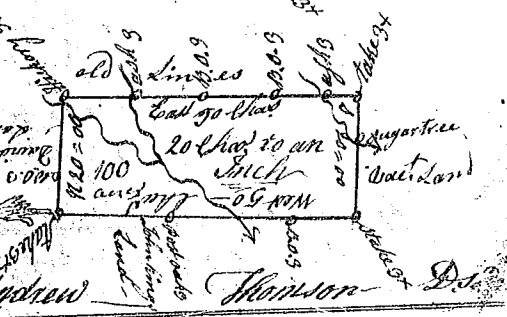

State of S^c Carolina 9th District East of the old Boundary line,
Pursuant to a warrant from John Thomas Esq^r Commissioner of Locations
dated 7th April 1785, I have admeasured and laid out unto Samuel Clowney
tract of Land containing one Hundred and twenty acres, situate on
a small branch of Millchell's Creek a branch of fair forest, bounded
westwardly & Northwardly by Hugh Means's Land, all other sides
vacant Land, and hath such shape and Marks as the above plat
represents, Survey^d the 2^d day of May 1785, by Andrew Thomson D^s.
Recorded the 16th May 1785.

