

State of S^c Carolina Pursuant to a warrant from
 John Thomas Esq. Commissioner of Locations dated 5th April 1785,
 I have admeasured and laid out unto John Partman Jun. a
 Tract of Land containing four hundred and ninety acres
 situate in Ninety six district West of the ancient boundary
 on the S^o fork of Tygar River, bounding S.W. on land
 granted to John Nicoll S.E. to Henry Prince
 S.E. to Tobias Pettite and on all other sides
 on Vacant Land, and hath such shape and
 Marks as the above Plat Represents,
 Survey the 14th April 1785,
 W^m Benson Esq.
 Recorded the 16th May 1785,

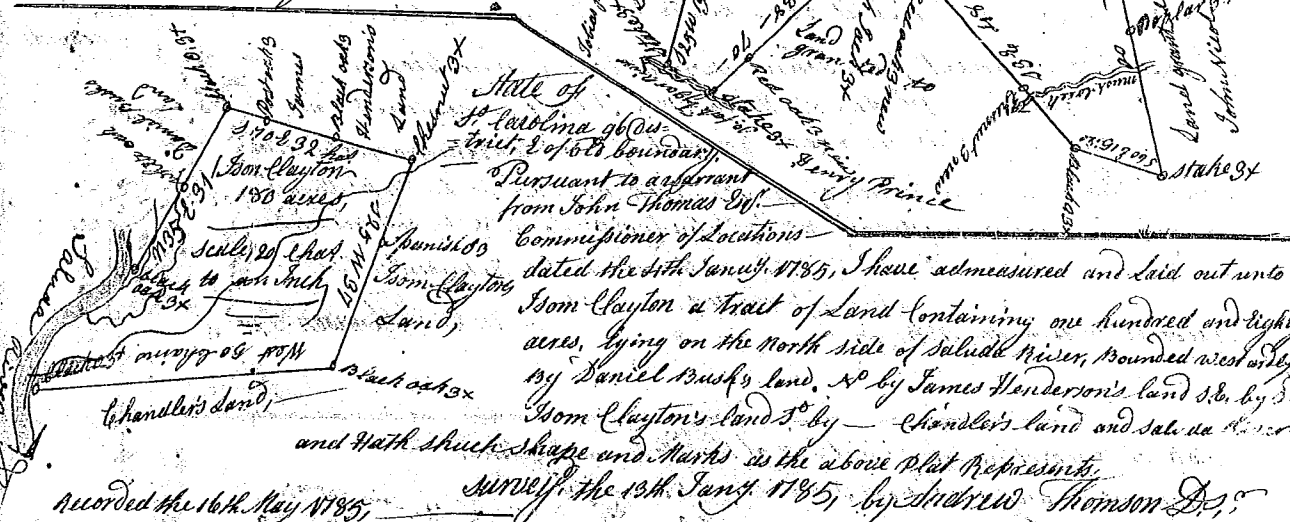

Survey the 14th April 1785,
 W^m Benson Esq.
 Recorded the 16th May 1785,

State of S^c Carolina 96th district East of old boundary
 Pursuant to a warrant from John Thomas Esq.
 Commissioner of Locations dated the 6th January 1785, I have admeasured and laid out unto
 John Clayton a tract of Land containing one hundred and eighty
 acres, lying on the North side of Saluda River, bounded west by
 Daniel Bush's land, N^o by James Henderson's land S.E. by S^c
 John Clayton's land S. by Chandler's land and Saluda River
 and hath such shape and Marks as the above Plat Represents,
 Survey the 13th Jan^y 1785, by Andrew Thomson Esq.
 Recorded the 16th May 1785,



State of S^c Carolina 96th district East of old boundary
 Pursuant to a warrant from John Thomas Esq. Com^r Locations bearing date the
 24th March 1785, I have admeasured
 & laid out unto Thomas Thornton a
 Tract of Land containing two Hundred &
 Thirty six acres lying on Wyles Fork of
 Dutchmans Creek, bounded N.W. by Abn.
 Moores Land Isaac Patton's & William Stirling's
 Land N.E. by Hembree & Thomas Conitons Land
 and hath such shape & marks as the above Plat Represents
 Survey the 5th day of May 1785 by And^r Thomson Esq.
 Recorded 16th May 1785

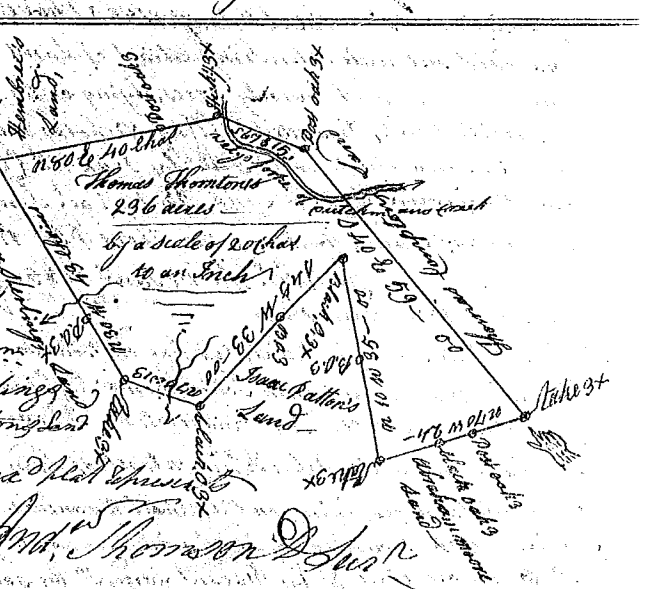

State of S^c Carolina 96th district East of the ancient Boundary line
 Pursuant to a warrant from John Thomas Commissioner of
 Locations dated 10th Jan^y 1785, I have admeasured and laid
 out unto John Burt a tract of Land containing one hundred
 and fifty acres, lying on a branch of Seven holes Creek
 waters of Enoree River, bounded on all sides by Vacant
 Land, and hath such shape and Marks as the above Plat
 Represents, Survey the 10th day of March 1785,
 Recorded 16th May 1785, by And^r Thomson Esq.

