

State of South Carolina, Pursuant to a warrant from John Thomas Esq^r Commissioner of Locations dated the 12th February 1785, I have admeasured and laid out unto George Underwood a tract of Land containing Two hundred and one acres situate in Ninety six district west of the ancient boundary on the branches of Sorrell Creek and branches of Maple Creek of Needy River, bounding to the NW on land laid out to John Watson all other sides on Vacant Land, and hath such shape and Marks as the above Plat Represents

Survey, 23 Feb^y. 1785 by W^m Benson Esq^r
Recorded the 12th May 1785

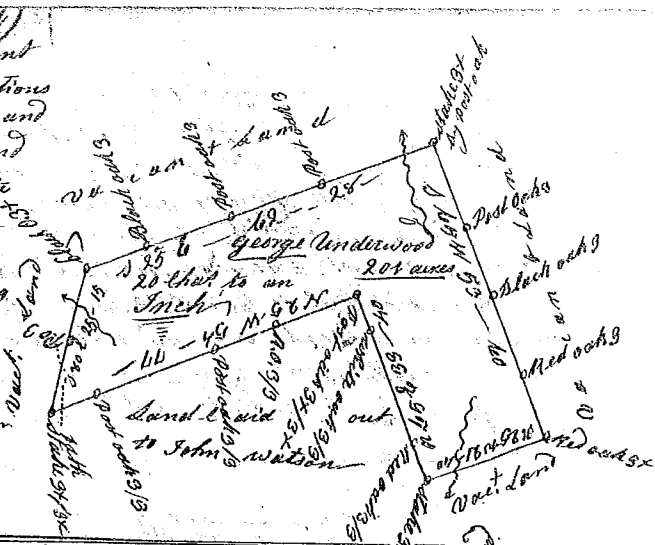

State of South Carolina 96 district East of the old Boundary line Pursuant to a warrant from John Thomas Esq^r Commissioner of Locations, dated 2nd March 1785, I have admeasured and laid out unto John Nicoll a tract of Land containing one hundred and fifty three acres, situate lying and being on both sides of the Middle fork of Tugar River, bounded Eastwardly by John Nicoll's Land SW by William Garrard's Land, all other sides old Line the owners to me unknown, they not residing among us, and hath such shape and Marks as the above Plat Represents

Recorded 12 May 1785 Survey, the 5th March 1785 by Andrew Thomson Esq^r

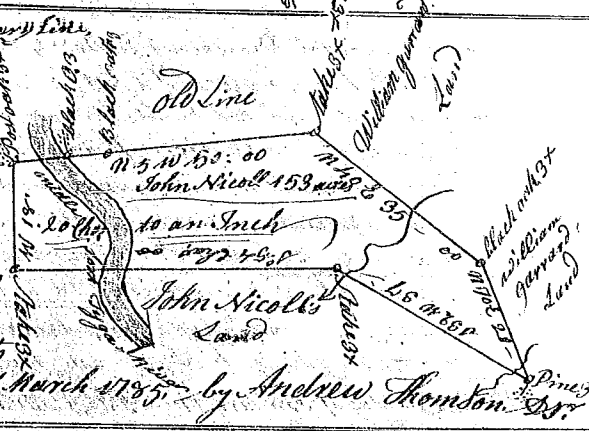

State of South Carolina Ninety six district, west of the ancient Boundary Pursuant to a warrant from John Thomas Esq^r Commissioner of Locations dated the 2nd May 1785, I have admeasured and laid out unto James Nicoll a tract of Land containing one hundred and Twenty six acres situate lying and being on Musk Creek a branch of Tugar River bounded SW by William Poole's Land, all other sides Vacant Land, and hath such shape and Marks as the above Plat Represents

SURVEY, the 4th May 1785 by And^r Thomson Esq^r

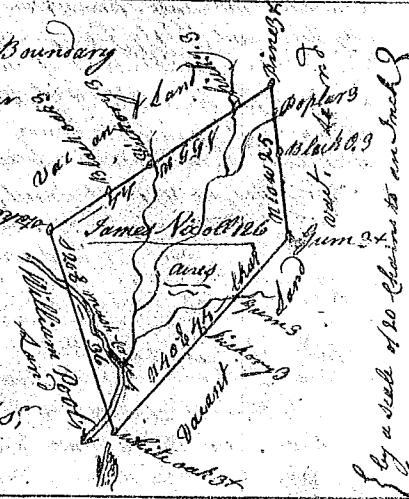

State of South Carolina Pursuant to a warrant from John Thomas Commissioner of Locations dated the 24th January 1785, I have admeasured and laid out unto William Thidell a tract of Land containing Two hundred and thirty eight acres, situate in Ninety six district west of the ancient Boundary on the Needy fork Creek of Needy River, bounding N 89 1/2° on Land Survey, by Tho^s Lewis, all other sides on Vacant Land and hath such shape and Marks as the above Plat Represents

Recorded the 12th May 1785, Survey, the 24th January 1785, Del^d Mr. Baker by W^m Benson Esq^r

