

State of S^c Carolina Pursuant to a Warrant from John Thomas Esq. Com^r of Locations in Ninety six District N^o Saluda River. I have admeasured & laid out unto John Brown a Tract of Land containing one hundred & fifty acres. On a small Branch of Punguan Creek below the Indian Boundary. Bounding E. by an land laid out to Roger Brown and all other sides on vacant Land and hath such shape & marks as the annexed plat represents. Surveyed the 18th March 1785. Recorded the 11th May 1785. Robert Hanna Dep^y Sur^v

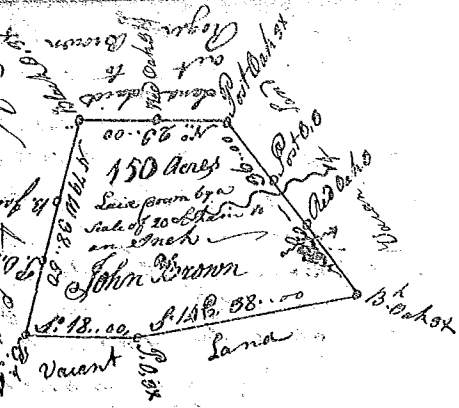

State of South Carolina Pursuant to a warrant from John Thomas Esq. Com^r of Locations in Ninety six District N^o Saluda River. I have admeasured & laid out unto James Saxon a Tract of One Hundred & twenty acres of Land on the Branches of Walnut Creek of Punguan River below the Old Boundary. Bounding E. by W^m Moores NW by Williamsons & other survey Land W on And^r Williamsons Land & all other sides vacant Land & hath such shape & marks as the annexed plat represents. Surveyed the 31st March 1785. Recorded the 11th May 1785. Robert Hanna Dep^y Sur^v

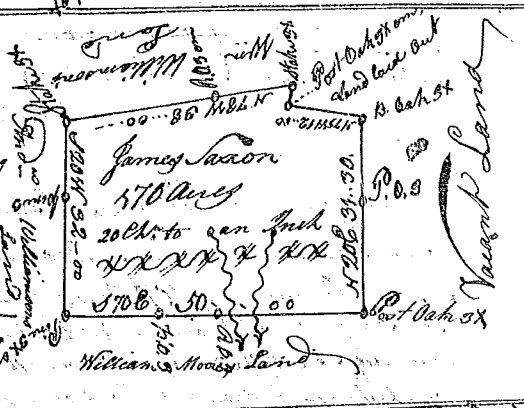

State of S^c Carolina 96 District East of the Old Boundary Pursuant to a warrant from John Thomas Esq. Com^r of Locations dated the 6th day of January 1785. I have admeasured and laid out unto James Bouton a tract of Land containing one Hundred acres, lying on both sides of James Creek, bounded W. by Hambes Land, E. by Benjamin Arnolds Land, N. by an old line & S. by vacant Land, and hath such shape and marks as the above plat represents. Surveyed the 15th Feb^ry 1785 by Andrew Thomason Dep^y Sur^v. Recorded the 11th May 1785.

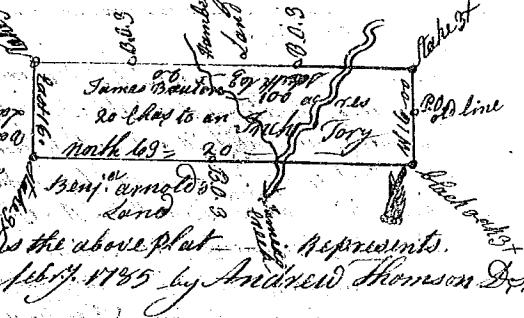

State of South Carolina Pursuant to a warrant from John Thomas Esq. Com^r of Locations in Ninety six District N^o Saluda. I have admeasured and laid out unto William Adington a Tract of Land containing one Hundred & twelve acres on a small Branch of Punguan Creek below the Indian Boundary. Bounding NW by Wm. hanton John Clarks Land & Part of John Cederings Land & East on Ambrose Whitting all other sides on vacant Land & hath such shape and marks as the above plat represents. Surveyed the 22nd of March 1785. Recorded the 11th May 1785. Robert Hanna Dep^y Sur^v



State of South Carolina Pursuant to a warrant from John Thomas Esq. Commissioner of Locations in 96 District N^o of Saluda River. Dated the 11th day of February 1785. I have admeasured & laid out unto Jacob Neel a Tract of Land containing three Hundred & twenty acres of Land below the ancient Boundary line in 96 District. Situate on Branches of Saluda River. Bounding on all sides on vacant Land and hath such form & Marks as the annexed plat represents. Surveyed this 16th of March 1785. Recorded the 11th May 1785. John Bowler Dep^y Sur^v

