

State of South Carolina 96 District West of the ancient boundary line (99)

Pursuant to a warrant from John Thomas Commissioner of locations dated the 2^d day of March 1785, I have admeasured and laid out unto John Snoddy a tract of land containing two hundred and forty acres lying on the right bank, a branch of Tyger River, bounded N by either Thomas's land or by James Nicholls land, all other sides vacant land, and hath such shape and marks as the above Plat Represents,

Survey: 30th April 1785 And: Thomson D
Recorded the 2^d May 1785

Del: John Snoddy

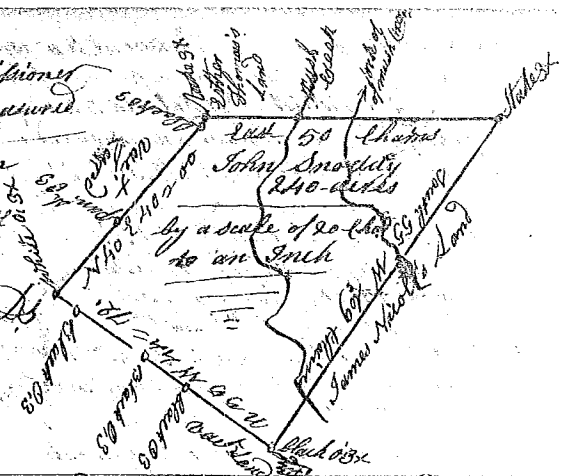

State of S Carolina, 96 District West of the ancient boundary line Pursuant to a warrant from John Thomas Commissioner of locations dated the 2^d March 1785, I have admeasured and laid out unto Samuel Snoddy a tract of land containing one hundred and three acres lying on Follenbergs branch of Tyger River bounded S. by William Linder's Land all other sides vacant land, and hath such shape and marks as the above Plat Represents, Survey: the 30 April 1785, Recorded the 2^d May 1785, by Andrew Thomson, Del: Saml Snoddy



State of S Carolina 96 District East of the ancient boundary Pursuant to a warrant from John Thomas Commissioner of locations dated the 2^d day of March 1785, I have admeasured and laid out unto Samuel Snoddy a tract of land containing 69 acres situate lying and being on the North side of the North fork of Tyger River, on both sides of the cut branch, containing sixty nine acres bounded SW by S. Samuel Snoddy's land and hath such shape and marks as the above Plat Represents, Survey: the 14th March 1785, Recorded the 2^d day May 1785, by Andrew Thomson, Del: Saml Snoddy

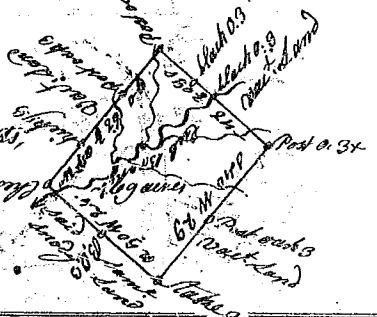

State of S Carolina 96 District at Saluda Pursuant to a warrant dated the 10th day of March 1785, from John Thomas Commissioner of locations, I have admeasured and laid out unto Jacob Chambliss a tract of land containing two hundred acres in Ninety six District, N side of Saluda River, situate lying and being on branches called Williams's Creek the waters of Tyger River. Bounded N. ward by Samuel Hendricks land, bounded S. ward by James Fordens land, all other sides vacant land, and hath such shape and marks as the above Plat Represents, Survey: 19th April 1785, Recorded 2^d May 1785

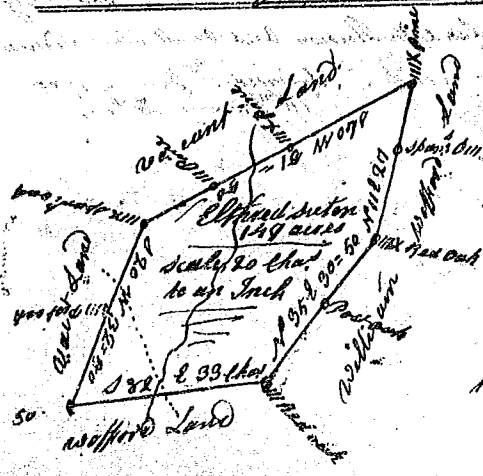
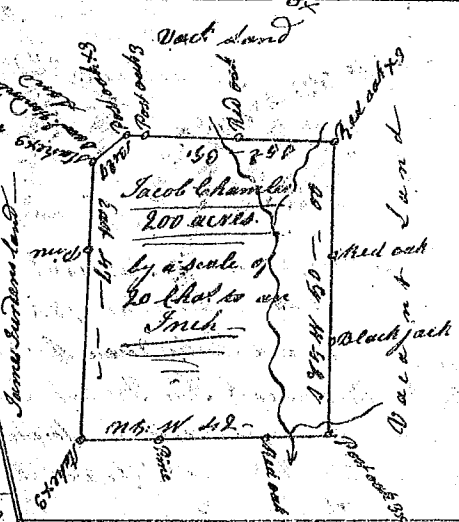

State of S Carolina Pursuant to a warrant from John Thomas Commissioner of locations dated the 2^d of February 1785 I have admeasured and laid out unto Ethedred Sutton a tract of land containing one hundred and forty seven acres, situate on both sides of a branch of Lawson's fork of Puckett River bounding S. on William Wofford's land, N. on 159th vacated land all other sides vacant land, and hath such shape and marks as the above Plat Represents, Survey: 28 April 1785, Recorded 2^d May 1785, Joseph Whitner Del:

Joseph Whitner Del: