

State of South Carolina

99

Pursuant to a warrant from John Thomas Esq^r Commissioner of Locations, dated 3^d day of March 1785, I have admeasured and laid out unto Elizabeth Young tract of three hundred and forty acres of Land, situate in Ninety six District, west of the old boundary line, on the branches of Chocoma River, waters of Saluda River, and hath such shape Marks & boundaries as the annexed Plat Represents, Survey, 18th April 1785.

Recorded the 19th April 1785, George Salmon Esq^r

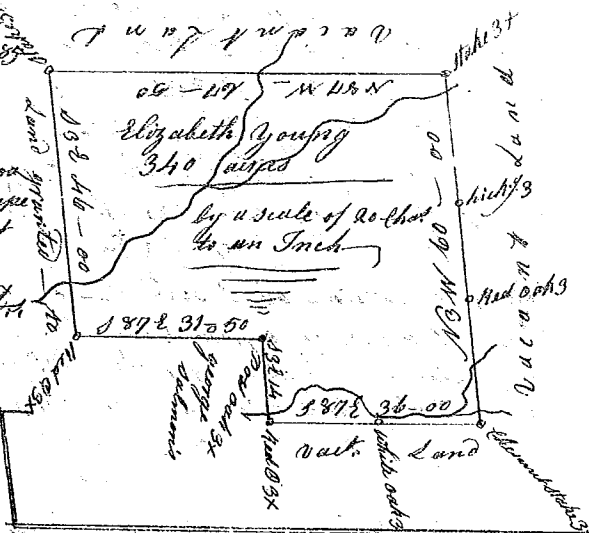

State of S^c Carolina,

Pursuant to a warrant from John Thomas Esq^r Commissioner of Locations Dated the 4th day of April 1785, I have admeasured and laid out unto John Steen Jun^r tract of three hundred and sixty acres of Land, situate in Ninety six District East of the old Boundary on the branches of Minkion's Creek of Chickety Creek and the branches of Gitchey's Creek of Pitts, and hath such shape & marks & boundaries as the above Plat Represents,

Survey, the 18th April 1785.

Recorded 19th April 1785, George Salmon Esq^r

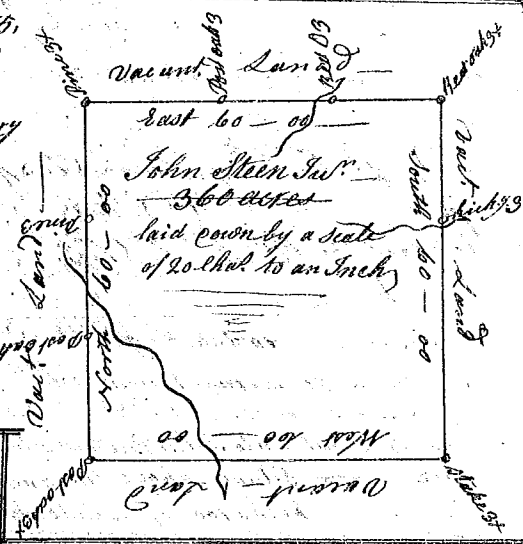

State of S^c Carolina 96 District

Pursuant to a warrant from John Thomas Esq^r Commissioner of Locations, for the Dist^{ct} of the N^o Side of Saluda River, I have surveyed and laid out unto John Tub tract of Land containing 190 acres situate above the ancient boundary line on both sides of Emoree River, bounded westwardly by Robert Princes Land, on all other sides by Vacant Land, and hath such shape and Marks as the above Plat Represents, Survey, 17th Juny 1785.

Recorded the 19th April 1785, Del^o James Tub, James Seaborn Esq^r

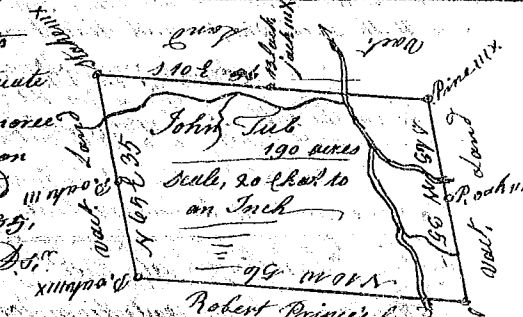

State of S^c Carolina 96 District

Pursuant to a warrant from John Thomas Esq^r Commissioner of Locations for the District of Saluda River, I have surveyed and laid out unto Lewis Turner tract of Land containing 330 acres, situate below the ancient boundary line, on the waters of Lawson's fork of Pacolok River, bounded N^owardly by John Corner's Land, on all other sides by Vacant Land, and hath such shape and Marks as the above Plat Represents,

Survey, the 16th March 1785, by James Seaborn Esq^r Recorded the 19th April 1785

