

(13)

State of S^c Carolina Pursuant to a warrant from John Thomas Esq. Commissioner of Locations dated 3 day Oct. 1784 I have admeasured and laid out unto Francis Clayton tract of Two hundred and four acres of land, situate in Ninety six District West of the ancient Boundary on the branches of Bushes Creek of Saluda River, bounding to the SW of land Survey for Tom Clayton NW to James Hendersons, all other sides on Vacant Land, and hath such shape and marks as the annexed Plat represents MDCCLXXXIV the 13th day of Nov. 1784. W^m Benson D.S.
Recorded 21st Feb^{ry} 1785.

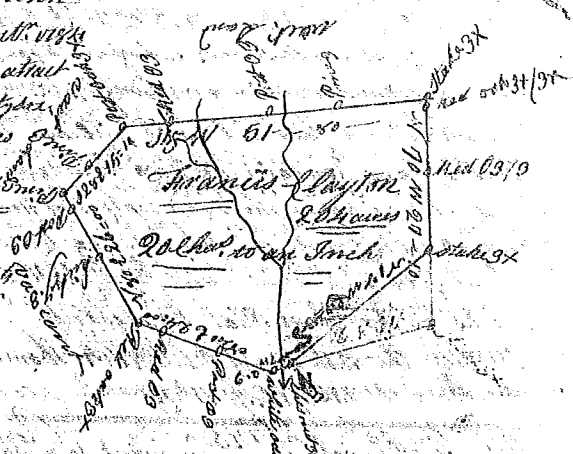

State of S^c Carolina Pursuant to a warrant from John Thomas Esq. Commissioner of Locations dated 1st Nov. 1784, I have admeasured and laid out unto Jacob Light a tract of seventy four acres of land situate in Ninety six District West of the ancient Boundary of Saluda River, bounding Sth and Est river, and on all other sides on Vacant Land, and hath such shape and marks as the annexed Plat represents MDCCLXXXIV the 20th day of Nov. 1784. W^m Benson D.S.
Recorded the 21st day of Feb^{ry} 1785.

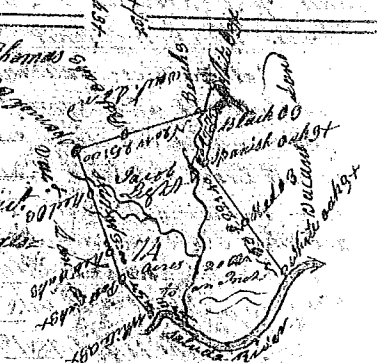

State of South Carolina Pursuant to a warrant from John Thomas Esq. Commissioner of Locations dated The 18th day of December 1784. I have admeasured and laid out unto Joseph Doughty a Tract of one Hundred acres of land situate in Ninety six District West of the ancient Boundary, on the wild Cat branch of the Sth Fork of Tigar River, bounding to the South on lands laid out to John Lucas, and on all other sides on Vacant Land, and hath such shape & marks as the annexed plat represents, Survey this 9th day of January 1785. W^m Benson D.S.
Recorded the 25th Feb^{ry} 1785.

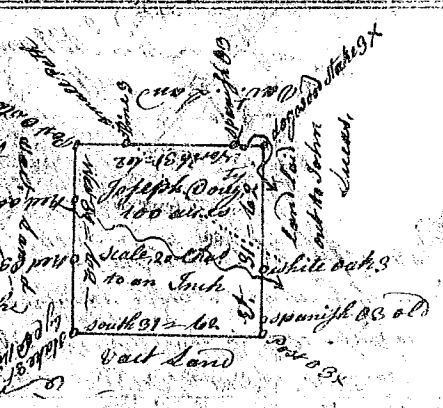

State of S^c Carolina Pursuant to a warrant from John Thomas Esq. Commissioner of Locations dated the 30th Oct. 1784 I have admeasured & laid out unto Thompson, Bustus a Tract of Land containing 400 Acres, situate lying & being on the waters of Horse Creek a branch of Reedy River, bounding on all sides on Vacant Land, & hath such shape & marks as the annexed Plat represents Survey the 1st Nov. 1784. By Thomas Lewis D.S.
Recorded the 24th February 1785.

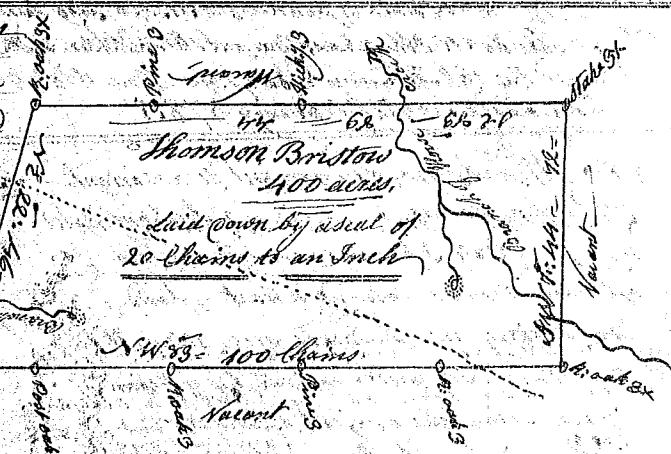

South Carolina Pursuant to a warrant from John Thomas Commissioner of Locations for Ninety six District on the Saluda River. Dated the 9th day of Dec. 1784. I have admeasured & laid out unto William Murphy a Tract of land containing two hundred & two acres, situate lying and being on a small creek of Saluda River below the Indian Boundary, bounding on all sides on Vac Land & hath such shape & marks as the annexed plat represents Survey the 13th day of Dec. 1784. By Thomas Lewis D.S.
Recorded the 20th Feb^{ry} 1785.

