

State of S. Carolina Pursuant to a warrant from  
 John Thomas Commissioner of Locations for ninety six  
 District No Saluda River, dated 18th Oct. 1784. I  
 have admeasured and laid out unto Michael Burts a  
 tract of one hundred and fifty acres of land, situate  
 in Ninety six District N. of Saluda River, below the ancient  
 Boundary on waters of Bush River, bounded S.E. by part  
 on land laid out to Thos. Royal & Part vacant, S.E. part  
 on John Ridgell and Part on Rufus Inman and Part vacant,  
 W. part on said Inman, and Part on John Inman, N.W. part on  
 said Royal and Part on vacant, and hath such shape and Marks  
 as the above Plat represents, Survey. the 20th Oct. 1784, by Phil. Waters Esq.  
 Recorded 19th febr. 1785.

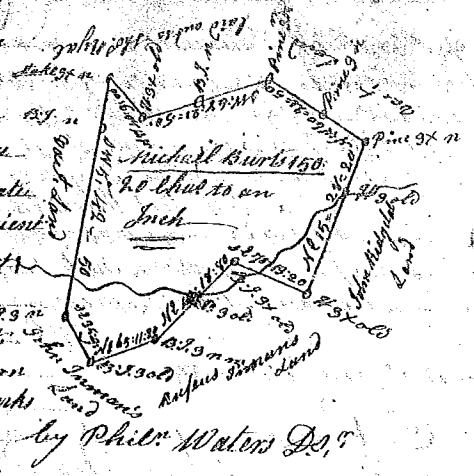

State of S. Carolina Pursuant to a warrant from John Thomas Esq.  
 Commissioner of Locations for Ninety six No side Saluda River  
 dated the 18th Nov. 1784, I have admeasured and laid out  
 unto Ellis Pugh a tract of one hundred acres of land  
 situate in Ninety six District No side Saluda River, below  
 the ancient Boundary on waters of said River, bounded  
 N. by John Smithburn's Land, on the W. by Peter Hurdin's  
 Land, and hath such shape and Marks as the annexed  
 Plat represents, Survey. the 20th Nov. 1784  
 Recorded 19th febr. 1785. Phil. Waters Esq.

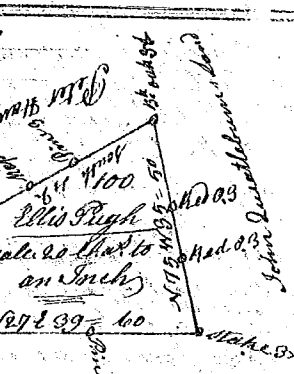

State of S. Carolina Pursuant to a warrant  
 from John Thomas Commissioner of Locations dated the 15th day of Oct. 1784 I have admeasured  
 and laid out unto John Watson a tract of three  
 hundred acres of land situate in Ninety six  
 District West of the ancient Boundary on the  
 branches of Maple Creek of Needy River, bounding  
 on all sides on Vacant land, and hath such  
 shape and Marks as the annexed Plat represents  
 Survey. the 27th Nov. 1784  
 Recorded the 18th febr. 1785. Wm. Benson Esq.

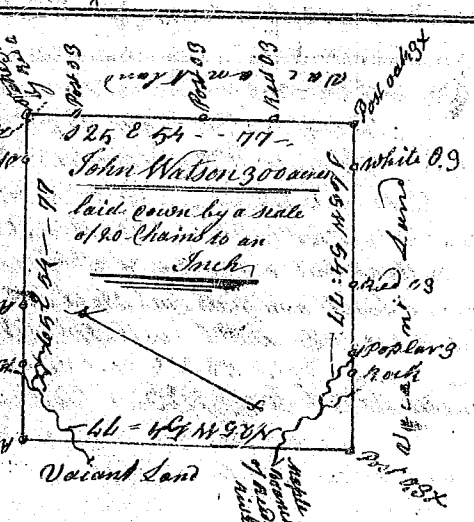

State of S. Carolina Pursuant to a  
 warrant from John Thomas Esq. Commis.  
 of Locations, dated 20th Oct. 1784 I have  
 admeasured and laid out unto Robert  
 Goodgion a tract of four hundred  
 and Ninety one acres of land.  
 Situate in Ninety six District East of  
 the ancient Boundary on the branches  
 of Molloy's Creek, of South Piedmont River  
 bounding N.W. S.E. of Lands laid out to  
 John Clayton, all other sides on Vacant  
 Land, and hath such shape and Marks  
 as the above Plat represents,  
 Survey. the 10th Nov. 1784 Wm. Benson Esq.  
 Recorded the 16th febr. 1785



Delivered to John Mathew