

State of South Carolina Pursuant to a warrant (18)
 from John Thomas Esq. Commissioner of
 Locations in 96 District N. Saluda I have
 Admeasured and laid out unto Robert
 Cunningham a tract of land containing
 one hundred and sixty five acres, one Duncan
 Creek below the Indian Boundary Branch & C
 on land laid out to the S. Robert Cunningham N.E. on long
 land laid out to Anthony Miller N.W. on land laid out to
 John Hunter & Wm. land laid out to the Godon and latter
 such shape and marks as the annexed plat represents
 Surveyed the 31st Oct. 1785, Robert Hanna Esq.
 Recorded the 3rd Feb. 1785 Deben to John Hamm.

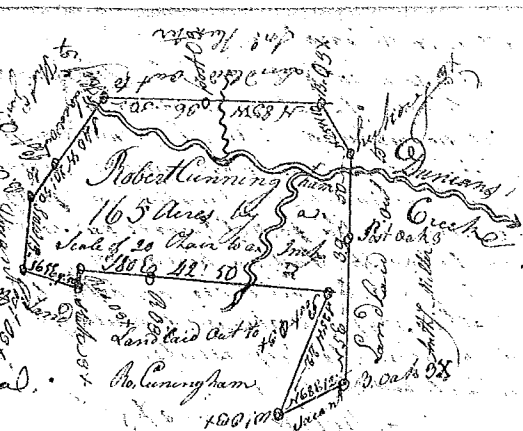

State of South Carolina
 Pursuant to a warrant from John Thomas Esq.
 Commissioner of Locations in 96 District N. Saluda
 River I have Admeasured and laid out unto James
 Puckett a tract of land containing one hundred
 and fifty acres on Cain Creek Waters of Saluda below
 the boundary bounded on all sides on vacant Land and
 and hath such shape and Marks as the above
 as the above plat represents
 Surveyed the 14th Dec. 1784
 Robert Hanna Esq. Surveyor Del. Jas Puckett

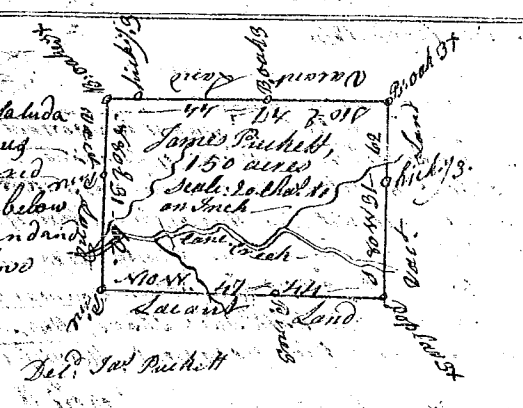

State of South Carolina Ninety six district on
 the last side of the ancient boundary line,
 Pursuant from John Thomas Esq. Commissioner
 of Locations North Saluda, dated 4th Nov. 1784
 I have admeasured and laid out unto James
 Oliphant, a tract of land containing three hundred
 and six acres lying on Cowden's Branch waters
 of Tugger Millers, bounded S.E. on said Oliphant's
 Land, all other sides Vacant Land, and hath
 such shape and Marks as the annexed Plat
 represents, Surveyed 4th Nov. 1784
 by Andrew Thompson Esq.
 Recorded 3rd Feb. 1785.



State of South Carolina Pursuant to a warrant from
 John Thomas Commissioner of Locations N. Saluda River
 I have admeasured and laid out unto Eleanor Craig a tract
 of land containing one hundred and fifty acres on the dividing
 ridge between Shores River and Dunden's Creek below the
 Indian Boundary, bounding on all sides by Vacant Land
 and hath such shape and Marks as the above Plat represents
 Surveyed the 1st of Nov. 1784
 Recorded the 3rd February 1785, by Robert Hanna Esq.



State of South Carolina Pursuant to a warrant
 from John Thomas Esq. Com. Locations in 96 District
 N. Saluda River. I have Admeasured and laid out
 unto Wm. Murray a Tract of Land containing thirty seven
 On the Hitting fork a branch of Indian Creek Below
 the Indian Boundary, the part on land laid out to
 Wm. Murray & part on land laid out to Robt. May, & on
 Land laid out to Pearce Nolan and all other sides on
 Vacant Land & hath such shape and marks as the above
 Plat represents. Surveyed the 20th Oct. 1784
 Recorded the 3rd Feb. 1785 Robert Hanna Esq.
 Del. Maj. Dogan

