

State of South Carolina Pursuant to a warrant for John Thomas Esq. Commissioner of locations in Ninety six District No. Saluda River, I have admeasured and laid out unto Thomas M. Crary a tract of Land containing one hundred and thirty five acres on a small branch of Duncan's Creek, below the Indian boundary Bounded N. E. W. on land laid out to Andrew M. Crary & son Thomas M. Crary SW on an old survey and NE on Vacant Land and hath such shape and Marks as the above Plat represents
 Survey 17th Sept. 1784 by Robt Hanna
 Recorded 29 Jan'y 1785 by Robt Hanna D.



State of South Carolina Pursuant to a warrant from John Thomas Esq. Commissioner of locations in Ninety six District No. Saluda River, I have admeasured and laid out unto Thomas Foster a tract of Land containing two hundred and fifty acres on the branches of Dove Creek of Saluda below the Indian boundary and on the road leading to Swansey ferry Bounding N. E. on land claimed by William Caldwell N. W. on Patrick Cunningham's & 400 90 Land, and land the corner with more 515 50 on land laid out to Jas. McGill and vacant Land, and hath such shape and Marks as the above Plat represents
 Survey 17th Decr 1784 by Robert Hanna D.
 Recorded the 28 Jan'y 1785 by Robt Hanna D.



State of South Carolina Pursuant to a warrant from John Thomas Esq. Commissioner of locations in Ninety six District No. Saluda River, I have admeasured and laid out unto William M. Calore a tract of Land containing one hundred acres on a small branch of Enoree River below the Indian line in said District, bounded on all sides on Vacant Land, and hath such shape and Marks as the above Plat represents, Survey 5th Oct. 1784
 Recorded 24 Jan'y 1785 by Robert Hanna D.



State of South Carolina Pursuant to a warrant from John Thomas Esq. Commissioner of locations in Ninety six District North Saluda River, I have admeasured and laid out unto James Duncan a tract of Land containing one hundred and fifty acres on the Deviling Ridge between Enoree River and Duncan's Creek below the Indian boundary, bounded on all sides on Vacant Land, and hath such shape and Marks as the above Plat represents, Survey 21 Oct. 1784
 Recorded 28 Jan'y 1785 by Robert Hanna D.

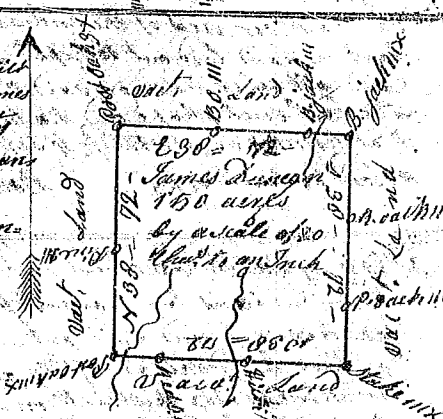

State of South Carolina Pursuant to a warrant from John Thomas Esq. Commissioner of locations in Ninety six District No. Saluda River, I have admeasured and laid out unto Edmond Rogers a tract of Land containing one hundred and forty four acres on a small branch of Duncan's Creek below the Indian boundary, bounded N. W. on William Taylor's land N. E. on land laid out to Robt Hutchinson, all other sides on Vacant Land, and hath such shape and Marks as the above Plat represents, Survey 22 Day of Sept. 1784
 Recorded 28th Jan'y 1785 by Robert Hanna D.

