

State of South Carolina

Pursuant to a warrant from John Thomas Esq<sup>r</sup> Commissioner of Locations in Ninety Six District North side Saluda River, I have admeasured and laid out unto James Puckett a tract of Land containing one hundred acres on the North side Saluda River below the Indian Boundary, bounded SW by said River James Beards and Vacant land, NE by land held by said James Puckett, all other sides by Vacant land and hath such shape and Marks as the above Plat represents, Surveyed the 14th Oct<sup>r</sup> 1784, by Rob<sup>t</sup>. Hanna D<sup>r</sup>, Recorded the 27th Jan<sup>y</sup> 1785. D<sup>r</sup>. J. Puckett

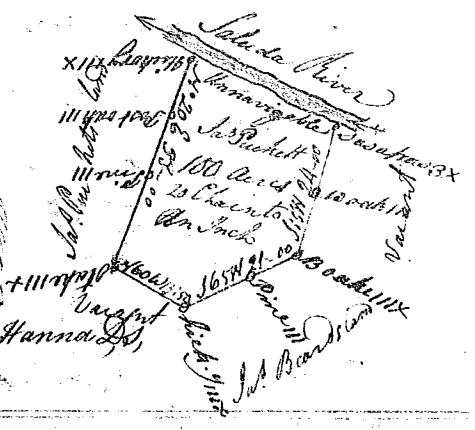

State of South Carolina

Pursuant to a warrant from John Thomas Esq<sup>r</sup> Commissioner of Locations in Ninety Six District North side Saluda River, I have admeasured and laid out unto Jonathan Simard a tract of Land containing two hundred and fifty acres on a small branch of Sugar River below the Indian Boundary, bounding N.E. & S.E. on land laid out the owner unknown, all other sides on Vacant land, and hath such shape and Marks as the annexed Plat represents, Surveyed the 14th Sept<sup>r</sup> 1784, Recorded 27th Jan<sup>y</sup> 1785. Rob<sup>t</sup>. Hanna D<sup>r</sup>.

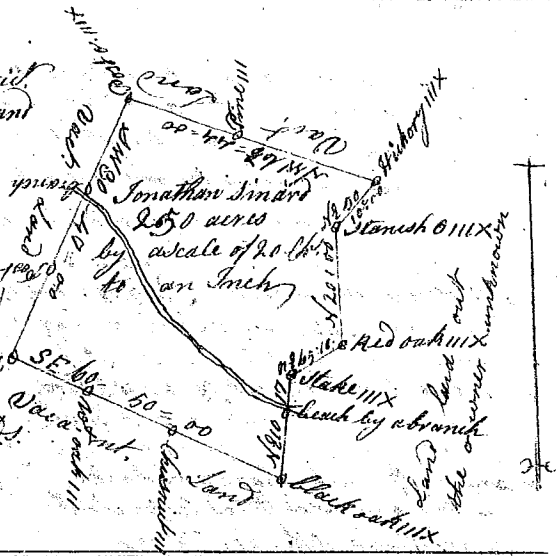

State of South Carolina

Pursuant to a warrant from John Thomas Esq<sup>r</sup> Commissioner of Locations in Ninety Six District N. Saluda River, I have admeasured and laid out unto Bowling Bishop a tract of Land containing one hundred acres on the NE side of Needy River below the Indian Boundary, bounded SW by said Needy River, NE by William Brown Land, all other sides on Vacant Land, and hath such shape and Marks as the annexed Plat represents, Surveyed the 22<sup>d</sup> Sept<sup>r</sup> 1784, Recorded 27th Jan<sup>y</sup> 1785 Rob<sup>t</sup>. Hanna D<sup>r</sup>.

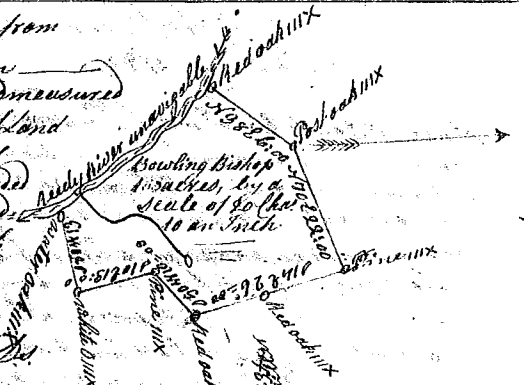

State of South Carolina

Pursuant to a warrant from John Thomas Esq<sup>r</sup> Commissioner of Locations in Ninety Six District N. Saluda River, I have admeasured and laid out unto Bowling Bishop a tract of Land containing seventy seven acres, on Duncan's Creek below the Indian line, bounded SW on land laid out to Rob<sup>t</sup>. Cunningham N.E. & S.E. on Land laid out to Anthony Miller and John Brown, and on all other sides on Land laid out to John Brown, and hath such shape and Marks as the above Plat represents, Surveyed the 16 Oct<sup>r</sup> 1784, by Rob<sup>t</sup>. Hanna D<sup>r</sup>, Recorded the 27th day Jan<sup>y</sup> 1785.



State of South Carolina

Pursuant to a warrant from John Thomas Esq<sup>r</sup> Commissioner of Locations in Ninety Six District North side Saluda River, I have admeasured and laid out unto Isaac Edwards a tract of Land containing 50 acres on the S. side of Enoree River below the Indian Boundary, bounded S.W. by said River, all other sides on Vacant land, and hath such shape and Marks as the above Plat represents, Surveyed the 2<sup>d</sup> day of Oct<sup>r</sup> 1784, by Rob<sup>t</sup>. Hanna D<sup>r</sup>, Recorded the 28 Jan<sup>y</sup> 1785.

