

State of South Carolina

(9)

Pursuant to a warrant from John Thomas Esq. Commissioner of Locations in 96 District N. Saluda River, I have admeasured and laid out unto John Thomas Esq. a tract of land containing one hundred acres on a small branch of Lane creek of Saluda River below the Indian Boundary in S. District, bounded SW on Christopher Rayson's & vacant land NW on Wm Lewis land, and on all other sides on vacant land. And hath such shape and marks as the annexed plat represents. Survey Oct. 15. 1784

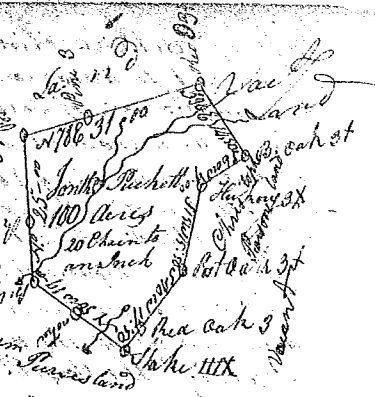

By Robert Gorman Esq. Deput. Sur. Packet

Recorded the 26th day of Jan^y 1785

Pursuant to a warrant from John Thomas Esq. Commissioner of Locations in Ninety six District N. Saluda River I have admeasured and laid out unto John Biggs a tract of land containing eighty acres on both sides of Enoree River below the Indian Boundary bounding S. by a part of S. River No. on land laid to John Smith NW on land claim'd by John Martin Dale and said Enoree River, all other sides vacant & hath such shape and marks as the annexed plat represents. Survey the 12th Nov^r 1784

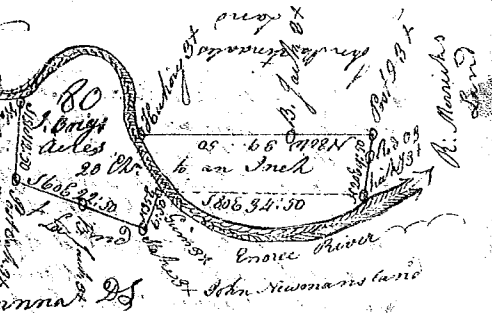

By Robert Gorman Esq. Deput. Sur. Packet

Recorded the 26th Jan^y 1785

Pursuant to a warrant from John Thomas Esq. Commissioner of Locations in 96 District N. Saluda River I have admeasured and laid out unto John Robinson a tract of land containing one hundred acres on both sides of Enoree River below the Indian Boundary bounding N. on Wells land & vacant land, all other sides on vacant land, and hath such shape and marks as the annexed plat represents. Survey the 16th Nov^r 1784



By Robert Gorman Esq. Deput. Sur. Packet

Recorded the 26th Jan^y 1785

Pursuant to a warrant from John Thomas Esq. Commissioner of Locations I have admeasured and laid out unto Nicholas Jesper a tract of two hundred acres of land situate in Ninety six district on the waters of Pacolite River bounding N. E. on John Jesper's land all other sides on lands laid out and vacant land, and hath such shape and marks as the annexed Plat represents. Survey the 26th Day of Oct^r 1784

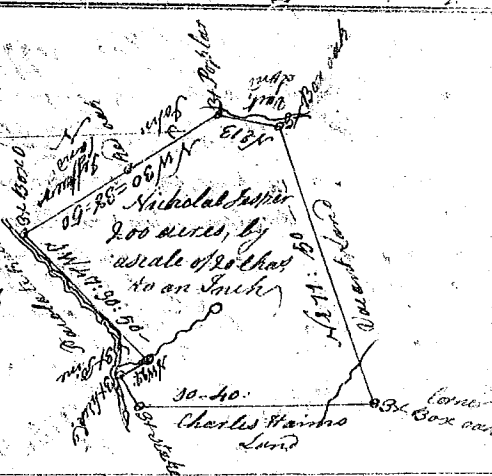

Recorded the 26th Jan^y 1785 David Hopkins Esq.

Deliv^d. Nicholas Jesper

State of South Carolina

Pursuant to a warrant from John Thomas Esq. Commissioner of Locations, I have admeasured and laid out unto John Portman a tract of two hundred acres of land situate in Ninety six District on the waters of Little Sandy Run of Pacolite River bounding NW by Charles Wainms Land all other sides on vacant land and laid out and hath such shape and marks as the annexed Plat represents. Survey the 26th Oct^r 1784

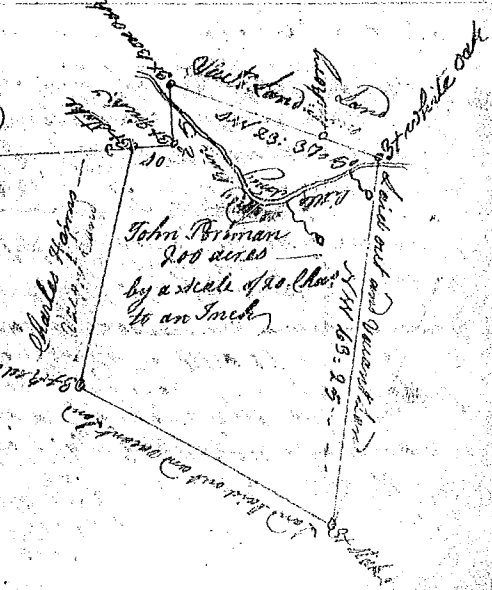

Recorded the 26th Jan^y 1785 David Hopkins Esq.

Deliv^d. Nicholas Jesper