

State of Carolina (977)

Pursuant to a warrant from John Thomas Esq. Com. L. S. dated the 11th Oct. 1784 I have admeasured & laid out unto Hugh O Neal a Tract of land containing 270 acres Situated in Ninety six District on the Branches of Rayburns Creek below the line Bounded S^o on Marys Creek & W^o on McDonalds Run N^o on 46^o 22^o 44^o Choice N^o E by Patrick Pugh East by Robert Sims N^o E by James M. Mansour all other sides Vacant Land and hath the said corners as the annexed plat represents Survey^d this 13th Dec^r 1784 by Smith Downs D^r Recorded the 12th January 1785 John to Tho. Daniel

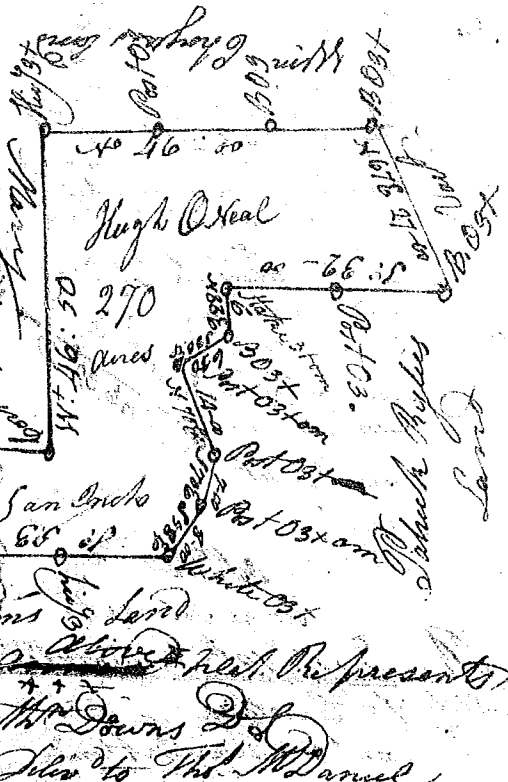

State of Carolina

Pursuant to a Warrant from John Thomas Esq. Commissioner of Locations dated the 20th day of Sept^r 1784. I have admeasured and laid out unto David Robinson a Tract of land containing Three Hundred Sixty Acres Situated in 96^o District East of the Old Boundary on the Branches of Minhoms creek & Gibbays creek of the North Waters of Broad River Bounding on all sides on Vacant Land and hath the said corners and marks as the annexed plat represents Survey^d this 15th Dec^r 1784 Recorded the 10th Jan^y 1785 Geo. Salmon D^r



State of Carolina

Pursuant to a warrant from Esq. Thomas Esq. Com. L. S. dated the 24th of Sept^r 1784. I have admeasured and laid out unto James Ferrell a Tract of land containing 100 acres Situated in Ninety six District East of the Old Boundary on the Branches of the North Waters of Broad River Bounding N^o on John Thompson and Wrights land N^o E on W. Wilkins Land all other sides Vacant. Hath the said corners and marks as the annexed Plat represents Survey^d this 15th Oct^r 1784 Recorded the 10th Jan^y 1785



George Salmon D^r