

State of South Carolina

Pursuant to a warrant from

John Thomas Esq. Commissioner of Locations in 96 District No. 114  
I have admeasured & laid out unto Mary Flanagan a Tract of Land containing two Hundred & Twenty five acres on a branch of Dubins Creek below the Indian Boundary Bounding N. on Matthias Armstrongs Land E. on Richard Fowlers Land all other sides on Vacant Land, & hath such State Shape Corners as the Annexed Plat Represents, Survey the 25<sup>th</sup> Sept 1785

Recorded the 4<sup>th</sup> Jan. 1785.

Robert Hannan Esq.



State of South Carolina

Pursuant to a warrant from John Thomas Esq. Commissioner of Locations dated the 31<sup>st</sup> of Dec. 1784. I have admeasured & laid out unto Joseph Kellat a Tract of Land containing four Hundred & Twenty three acres, Situate in 96 District on a Branch of Chesley River called Keybars Creek below the ancient Boundary. Bounded W. on S. Line N. on Cornelius Mahons Land E. on land laid out unknown, S. & S. E. on Mary McDaniels and Patrick Neelys Lands and hath such Shape & mark as the Annexed Plat Represents.

Survey this 9<sup>th</sup> day of Jan. 1785 by South Downs of laid out unto his own  
Recorded the 2<sup>nd</sup> Jan. 1785 Delivered to John Currier on 11

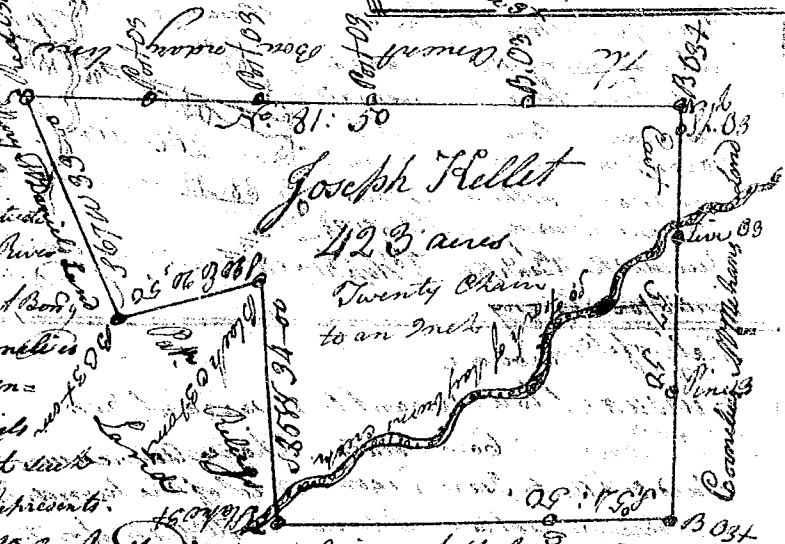

State of South Carolina

Pursuant to a warrant from John Thomas Esq. Commissioner of Locations dated I have admeasured and laid out unto John Gregory a Tract of three Hundred acres of Land Situated in Ninety six District on the Waters of Browns Creek Bounded S. W. on Bell Henrys Land all other sides on land laid out and Vacant Land, and hath such Shape & mark as the above plat Represents.

Survey the 31<sup>st</sup> day of Dec. 1784

David Hopkins Esq.



Recorded this 4<sup>th</sup> Day of January 1785 Delivered to Mr. Gregory

148