

State of S^c Carolina
 Pursuant to a warrant from
 John Thomas Esq. Com^r of Locations
 dated the 29th Nov. 1784. I have admeasured
 and laid out unto John Henderson a
 Tract of 221 acres of land situate in
 Ninety Six District East of the remnant of
 Boundary on the Branches of Little
 creek & Broad River Bounding
 to the W of Coleman's line S 85° W
 10^m Henderson S 6^m to Jesse Nabrey
 N 6 to Spinaul N 6 to Little
 N W to Hodges land & with such
 and marks as the annexed
 plat represents, Survey this 20th Dec^r 1784
 Recorded the 31st Dec^r 1784
 Delivered to Wm Benson Esq.

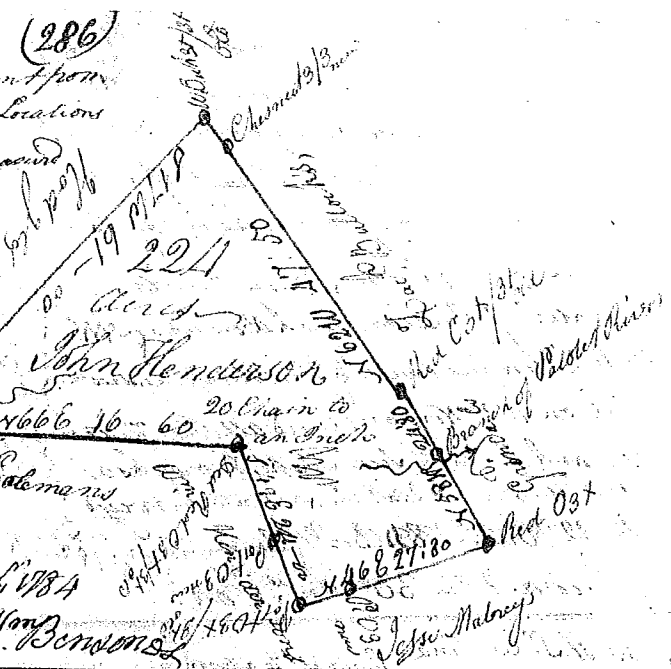

State of S^c Carolina
 Pursuant to a warrant from
 John Thomas Esq. Com^r of Locations
 dated the 27th Aug^t 1784 I have admeasured
 and laid out unto John Carle Jun^r
 a Tract of two Hundred acres of land
 Situate in 96 District East of ancient Boundary
 on Henry Wolf's Creek Bounded by the
 River Bounding to the N^e of the S^c Carolina
 Boundary, all other sides on Vacant Land
 and hath such shape & marks as the
 above plat represents, Survey this 26th Oct^r 1784
 Recorded the 31st of Oct^r 1784
 Delivered to Wm Benson Esq.

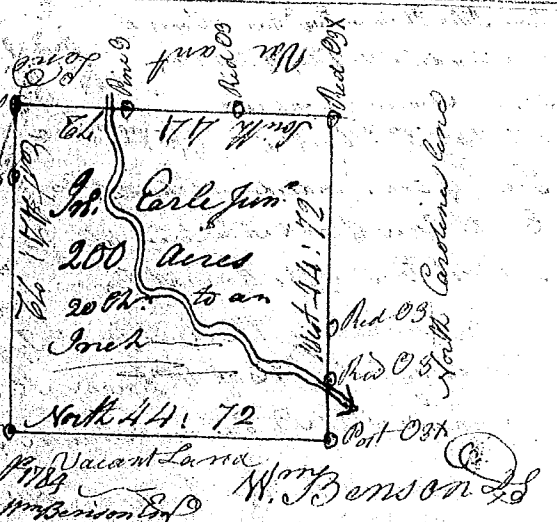

State of S^c Carolina
 Pursuant to a warrant from
 John Thomas Esq. Com^r Locations
 in 96 District N^e of Saluda River
 I have admeasured & laid out unto
 Mordicai Moore a Tract of land
 Containing 325 acres Situate
 on the N^e fork of Surber's creek
 Below the Indian
 Boundary and
 hath such shape
 marks & boundaries
 as the annexed
 Represents, Survey
 The 19th Aug^t 1784
 Robert Hanna Esq.

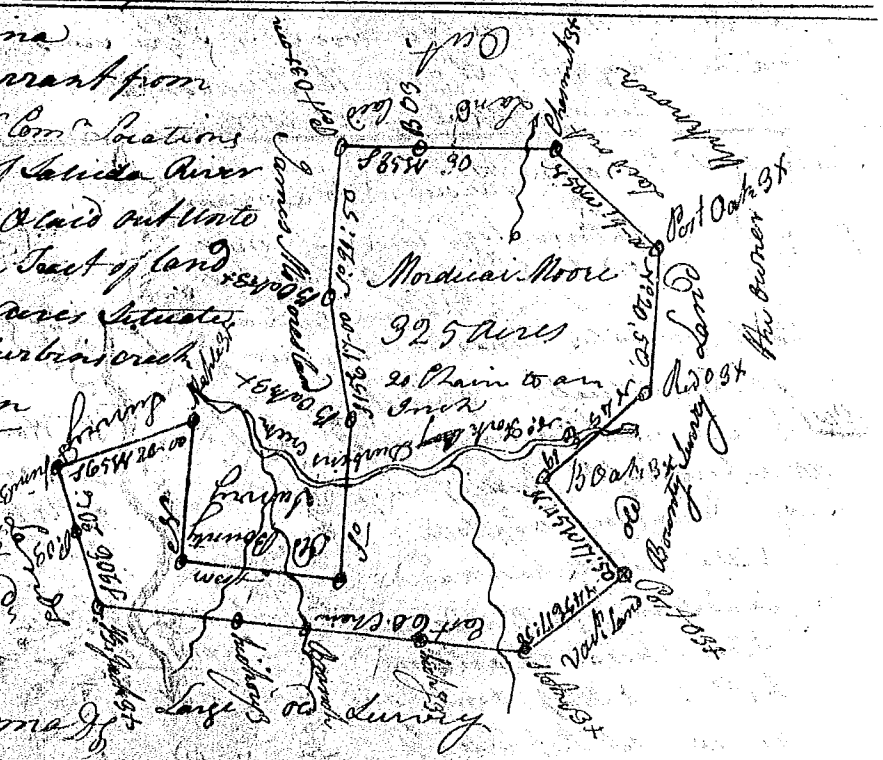

Recorded the 31st Dec^r 1784 Delivered to Mordicai Moore