

State of S^c Carolina Pursuant to a
 Warrant from John Thomas Esq^r Com^r
 of Locations I have admeasured & laid
 out unto Eliza Rhodes a Tract of two
 Hundred & Twenty seven acres of land
 Situation of it Des^{rs} being the old boundary
 on Waters of Indian Creek Boundary SW
 on Wm Nimons land NE on Henry Hendricks
 & N on Wm Nimons land all other sides
 Vacant & hath such shape & marks as
 the annexed plat represents surveyed
 the 22nd Oct^r 1784 Ben^g Benson surveyor
 Recorded the 30th Dec^r 1784

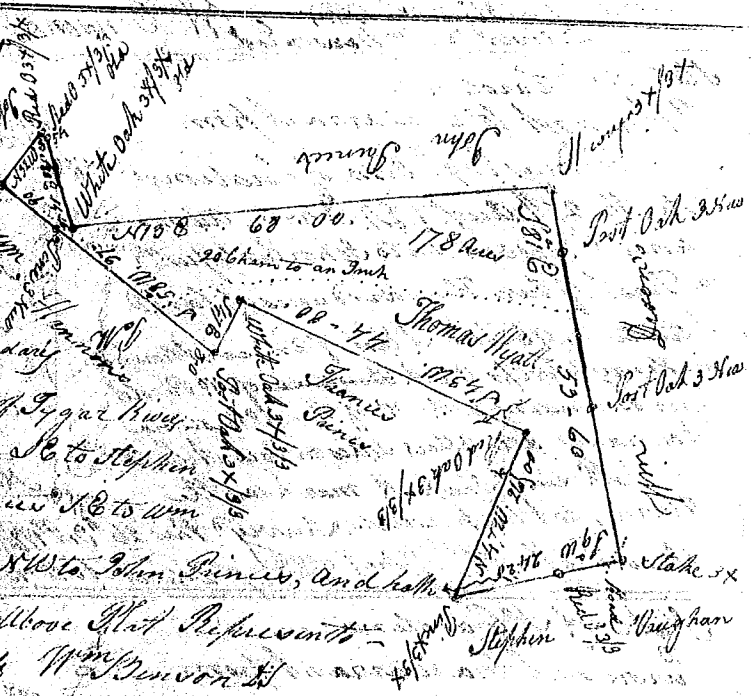

State of S^c Carolina Pursuant to a warrant
 from John Thomas Esq^r Commissioner of
 Locations dated the 5th day of July 1784
 I have admeasured and laid
 out unto Tho^s Wyatt a
 Tract of one hundred and eighty
 eight acres of land situated in 96th
 District East of the ancient Boundary
 on the Branch of the North fork of Sugar
 Bounding to the SE of Wm Dixon SE to Stephen
 Vaughan SW to Francis Pinner NE to Wm
 Hanmons SW to John Finney NE to John Pinner, and hath
 such shape and marks as the above plat represents
 Surveyed the 25th day of August 1784 Wm Benson
 Recorded the 31st Dec^r 1784



State of S^c Carolina Pursuant to a warrant
 from John Thomas Esq^r Commissioner
 of Locations dated the 5th day of July 1784
 I have admeasured & laid out unto
 a Tract of land two hundred & sixty four
 acres of land situated in 96th District
 West of the ancient Boundary on the
 Little fork creek of the Rocky fork of
 Peady River Bounding to the
 SSW & NW on land unknown and
 SW on land surveyed for Bonds and
 on all other sides on vacant land
 and hath such shape & marks as
 the annexed plat represents
 Surveyed this 19th of Aug^r 1784
 Recorded the 31st Dec^r 1784

