

State of Carolina (245)
 Pursuant to a warrant from John Thomas Esq. Commissioner of Locations for Ninety Six District North of Saluda River dated the 9th day of Oct. 1784 I have Admeasured & laid out unto Catherine Jones a tract of Two Hundred & Ninety four acres of land Situate in 96 District on the No. side of Saluda River below the Ancient Boundary on Waters of Broad River Bounded on the N. by Johnsons lands all other sides by land laid out. And hath such shape & marks as the annexed plat Represents Survey this 22nd Oct. 1784
 Recorded the 14th Dec. 1784
 P. Waters Esq.

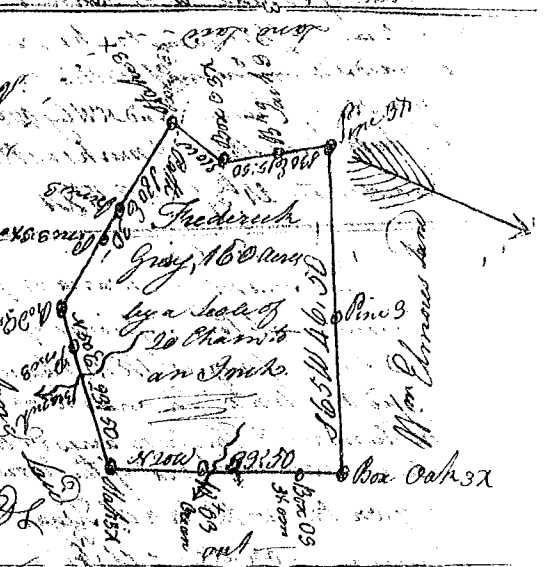

State of South Carolina
 Pursuant to a warrant from John Thomas Esq. Commissioner of Locations for Ninety Six District North of Saluda River dated the 10th Sept. 1784 I have Admeasured & laid out unto Frederick Gray a tract of One hundred & sixty acres of land Situate in Ninety Six District Northward below the Ancient Boundary on Waters of Cammons Creek Bounded NW by Williams Elmer's land all other sides by land laid out. And hath such shape & marks as the annexed plat Represents a Survey this 25th Sept. 1784
 Recorded the 14th Dec. 1784
 P. Waters Esq.



State of South Carolina
 Pursuant to a Warrant from John Thomas Esq. Commissioner of Locations for 96 Dist. N. of Saluda River dated the 10th Sept. 1784 I have Admeasured & laid out unto Frederick Gray a tract of 137 acres of land Situate in 96 Dist. on the N. side of Saluda below the Ancient boundary on Waters of Broad River Bounded NW by David Edwards land W & S by Rivers land & land laid out N.E. by Marpols land & hath such shape & marks as the annexed plat Represents a Survey this 27th Sept. 1784
 Recorded the 14th Dec. 1784
 P. Waters Esq.

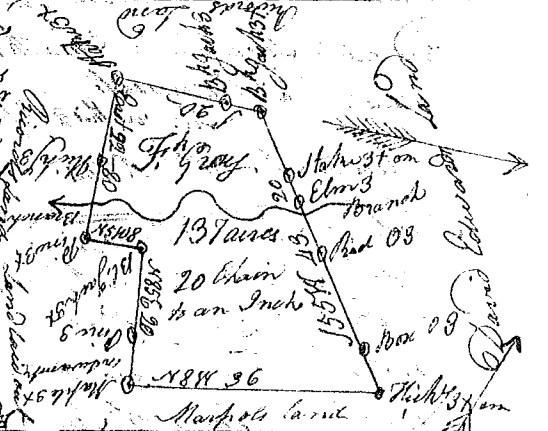

State of South Carolina
 Pursuant to a warrant from John Thomas Esq. Com. of Loc. for 96 Dist. N. of Saluda River dated the 10th Sept. 1784 I have Admeasured & laid out to Frederick Gray a tract of 94 acres of land Situate in 96 Dist. on the North side of Saluda River below the Ancient Boundary on Waters of Cammons Creek Waters of Broad River Bounded N.E. by David Glorms land NW by Geo. Gasp. & Gopher Peters land S.W. by land unknown and hath such shape and marks as the annexed plat Represents a Survey this 27th day of Oct. 1784
 Recorded the 14th Dec. 1784
 P. Waters Esq.

