

State of South Carolina (212)

Pursuant to a warrant from John Thomas Esq. Com. of Locations in Ninety Six District South of Saluda River dated the 23rd of Sept. 1784

I have measured & laid out unto **Hammond Johnston** a Tract of Land containing two Hundred & 50 Acres, on a small Branch of Guibor creek of the River below the long Rivered Ken Benjamin's by Henry & other Tracts Vacant, and I have such Stake & marks as the Annex^d plat Represents. Surveyed this day of 1784

Recorded the 19th Dec. 1784 - **Henry G. Moore** (Delivered to John Miller the same day it was recorded)

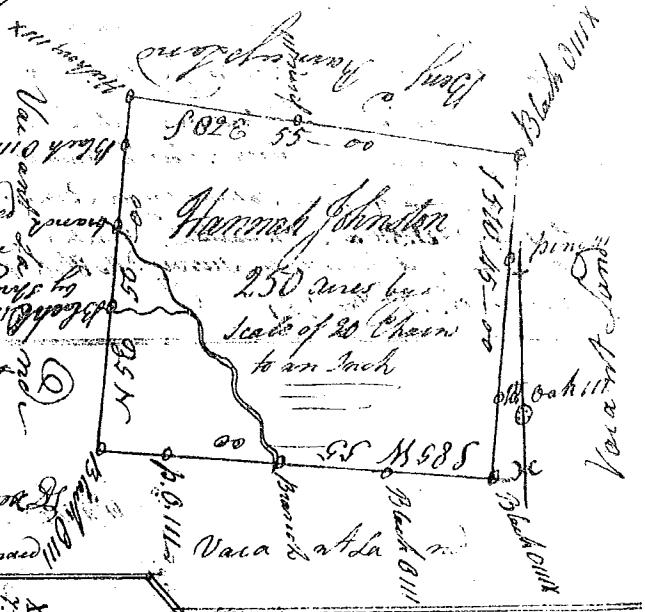

State of S. Carolina

Ninety Six District

Pursuant to a warrant to me Directed by John Thomas Esq. Commissioner of Locations for the District of the north side of Saluda River: I have Surveyed and laid out unto

William Wood a Tract of Land containing 440 acres. Situated being and being below the ancient Boundary on the first Boundary S.W. by William Wood's Land, all other sides Vacant. I have such Stake & marks as the Annex^d plat Represents. Surveyed the 24th of Oct. 1784

Recorded this 19th Dec. 1784

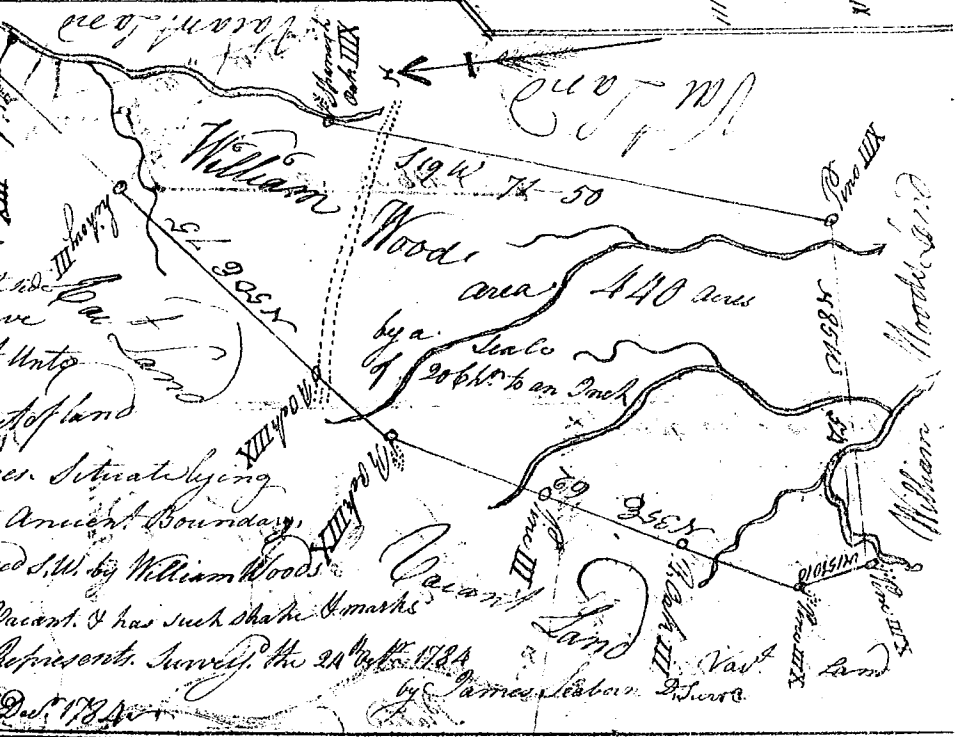

State of S. Carolina

Ninety Six District

Pursuant to a warrant to me Directed by John Thomas Esq. Commissioner of Locations for the District of the north side of Saluda River: I have Surveyed and laid out unto

John Cass a Tract of Land containing four hundred acres, situated being and being below the ancient Boundary on the sides of Duck Creek of the River. Including the Improvement of said John Cass and Allen Hamilton bounded on all sides by Vacant Land. and such Stake & marks as the above plat Represents. Surveyed the 8th day of Oct. 1784

