

South Carolina Pursuant to a Warrant directed by John Thomas Esq. of Locations for 90 Dis. No. of Situations in date the 20th July 1784. I have admirably and laid out unto John Tate, a Tract of land containing one thousand acres, Situated lying on Moccasin creek a branch of Enoree River on the South Side, bounding 1/4 on land laid out to Robert Maffee, all other sides on vacant Land, and hath such shape form & marks as the annexed Represents. Surveyed the 30th July 1784. By Thomas Lewis. Recorded the 10th Dec. 1784.

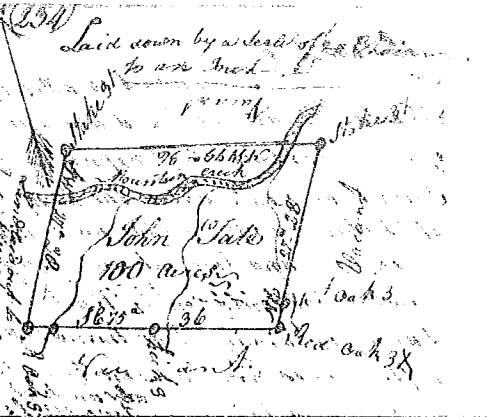

South Carolina Pursuant to a warrant directed by John Thomas Esq. of Locations for 90 Dis. No. of Situations in date the 13th day of August 1784. I have admirably surveyed and laid out unto Eli Norman a Tract of land containing one thousand acres, Situated lying and being on both sides of a branch of Enoree River on the South Side, bounding 1/4 on land laid out to all other sides vacant, and hath such form & marks as the above plat Represents. Surveyed the 4th of Sept. 1784. Recorded the 16th Dec. 1784. Delivered to Eli Norman by Thomas Lewis Esq.

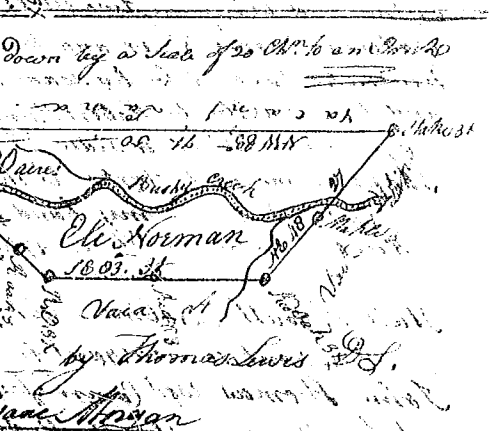

State of South Carolina Pursuant to a warrant from John Thomas Esq. of Locations dated 1st day of Sept. 1784. I have admirably & laid out unto John McLeary a Tract of one thousand acres of land Situated in Ninety six District West of the ancient boundary on Mill Creek of South Carolina River. Bounding on all sides by vacant Land & hath such shape form & marks as the annexed Represents. Surveyed this 2nd of Sept. 1784. Recorded the 10th Dec. 1784. Wm. Benson.

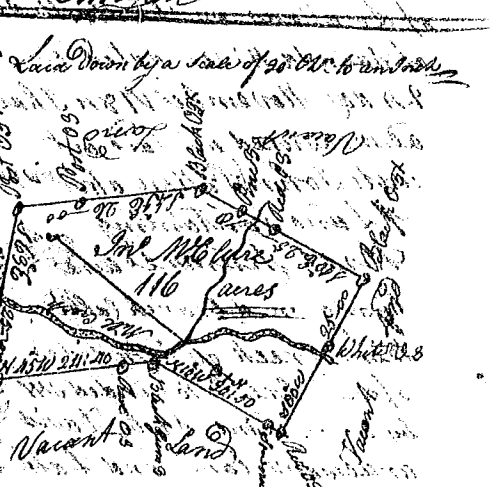

State of South Carolina Pursuant to a Warrant from John Thomas Esq. of Locations dated 2nd of August 1784. I have admirably surveyed and laid out unto Thomas Crowder a Tract of Land Three Thousand & Eighty seven acres of land, Situated in Ninety six District East of the ancient boundary on the left side of North Tyeon River Bounding to the N of Stephen Vaughan N.W. of Francis Prince & W. of Wm. Gannonts - all other sides Vacant Land, and hath such shape form and marks as the annexed Represents. Surveyed this 15th of Sept. 1784. Recorded the 10th Dec. 1784. Wm. Benson.

