

State of South Carolina  
 Pursuant to a warrant from John Thomas Esq. Commissioner of Locations I have measured & laid out unto Benj. Crownover, a tract of two hundred acres of land situated in Ninety six District, on the waters of Shness Creek & Little Sandy Run. Bounding on the North of Shness River, Bounding on the East on land laid out to Peter Howard, all other sides on vacant land, and hath such shape and marks as the annexed plat represents.  
 Surveyed the 8<sup>th</sup> day of Nov<sup>r</sup> 1784  
 Ben. Glenn  
 Recorded the 17<sup>th</sup> Nov<sup>r</sup> 1784

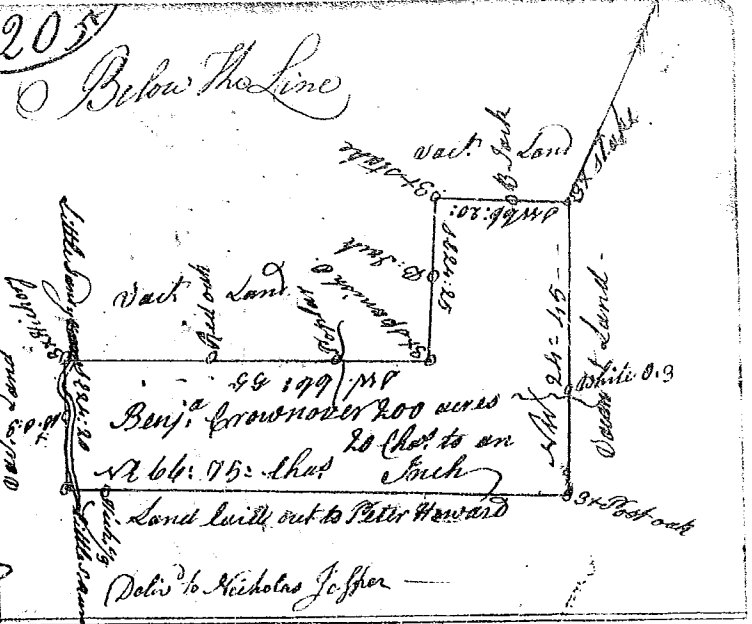

State of South Carolina  
 Pursuant to a warrant from John Thomas Esq. Com<sup>r</sup> Locations I have a measured and laid out unto Benjamin Crownover a tract of sixty nine acres of land situated in Ninety six District on the waters of Pawlato River bounding Eastwardly on land laid out to Charles Brandon Westwardly on Robert M. Whetter all other sides on vacant land and hath such shape and marks as the above Plat Represents.  
 Surveyed the 6<sup>th</sup> day of Nov<sup>r</sup> 1784  
 Ben. Glenn D. S.  
 Recorded the 11<sup>th</sup> day of Nov<sup>r</sup> 1784 Deliv<sup>d</sup> to Nicholas Jeffers

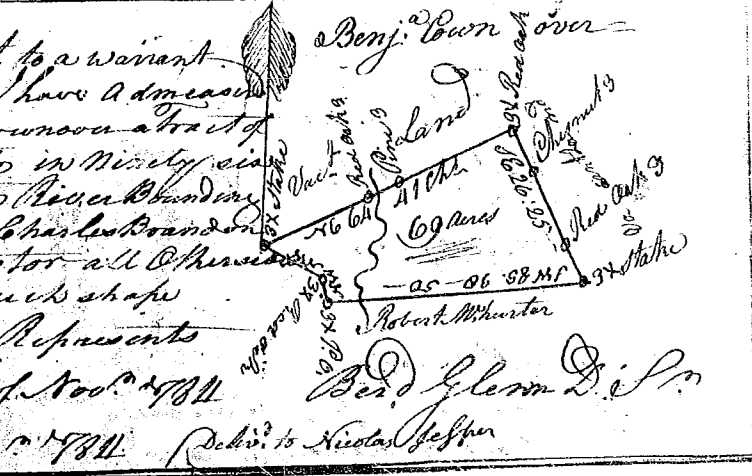

State of South Carolina  
 Pursuant to a warrant from John Thomas Esq. Commissioner of Locations in Ninety six District. Measured & laid out unto Matthew M. Cory a tract of land containing one hundred and sixty four acres on a branch of location called and known by the name of Harold's Creek below the Indian boundary bounding on John M. Cory's land on the North on land laid out for John Coulter S. C. on land laid out for William Layton, all other sides on vacant land and hath such shape and marks as the annexed Plat Represents, Surveyed the 14<sup>th</sup> Sept<sup>r</sup> 1784  
 Recorded the 18<sup>th</sup> Nov<sup>r</sup> 1784



State of South Carolina. Pursuant to a Warrant from John Thomas Esq. Commissioner of Locations, I have measured & laid out unto Ferdinand Hopking a tract of one hundred & eighty nine acres of land situated in 96 District on the waters of Sugar River & Enoree River, Bounding on land laid out & vacant Land & hath such shape & marks as the annexed plat Represents, Surveyed the 31<sup>st</sup> day of Sept<sup>r</sup> 1784  
 Recorded the 18<sup>th</sup> Nov<sup>r</sup> 1784

