

State of South Carolina
Pursuant to a warrant from John Thomas Esq. Commissioner of Locations

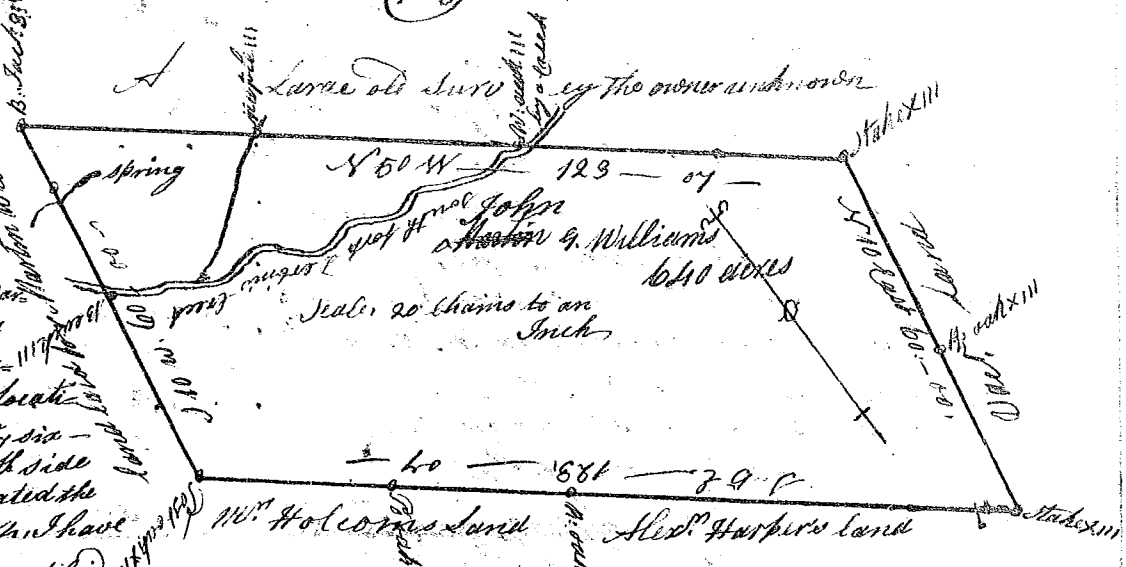

Commissioner of Locations in Ninety six District north side of Saluda dated the 16th June 1784. I have admeasured and laid out unto ~~Martin Williams~~ John Williams a tract of land containing

Six Hundred and forty acres on the south forke of Derbins Creek below the Indian Boundary Bounding NE on Harpers land SE on land laid out to Martin Williams SW on a large old survey NW on Vacant Land, and hath such shape and Marks as the above Plat Represents. Surveyed 23 June 1784 Robt Hanna D. S. Delid. Martin G. Williams

State of South Carolina Ninety six District East of the ancient Boundary line Pursuant to a warrant from John Thomas Esq. Commissioner of Locations on the NE side of Saluda River Dated the 31st of July 1784 I have admeasured and laid out unto Daniel Hail a tract of land containing one hundred & twelve acres lying on Dutchmans creek bounded NE by Williams Smiths Land E. by Vacant Land and Willifords Land SW by Ralph Whites Esq. Land and Sarah Ebers Land and hath such shape and marks as the annexed plat represents Surveyed 12 August 1784

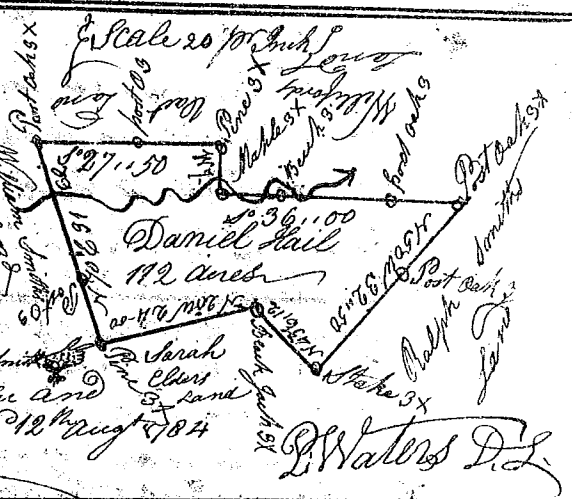

State of South Carolina Ninety six District East of the ancient Boundary line Pursuant to a warrant from John Thomas Esq. Commissioner of Locations Dated the 9th day of July 1784 I have admeasured and laid out unto James Proff a tract of land containing two hundred acres lying on the S^e side of Rowlet River bounded N by Rowlet River West by Jacob Homig, all other sides Vacant & hath such shape and marks as the annexed plat Represents Surveyed the 9th of July 1784 J. P. Waters D. S. Recorded 30th Sept 1784

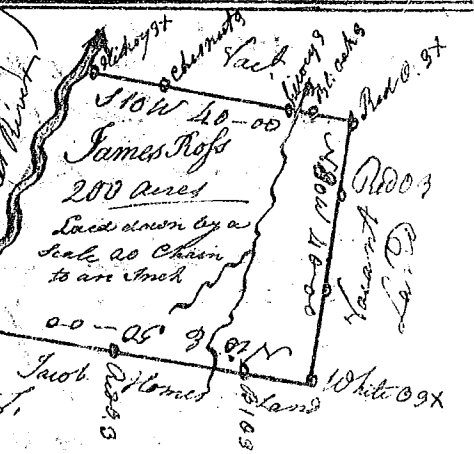

State of South Carolina 96 District East of the ancient Boundary Pursuant to a warrant from John Thomas Esq. Commissioner of Locations dated the north side of Saluda River dated 5 June 1784 I have admeasured and laid out unto Richard Nally a tract of land containing fifty acres lying near Sugar River bounded on every side by Vacant Land and hath such shape and marks as the annexed plat Represents Surveyed 26 June 1784 L. Waters D. S. Recorded the 30th Sept. 1784

