

State of South Carolina (134) Ninety Six District
 On the side of the ancient Boundary line
 Pursuant to a warrant from John Thomas Esq.
 Commissioner of Locations Dated the 12th July 1784
 I have measured and laid out unto Philemon
 Waters sen. a tract of land containing one hundred
 acres. Lying on the Nth side of Saluda River -
 Bounded to the south by Sth River N.W. by Edward
 Musgroves Land N.E. by the Sth Musgroves Land West Land
 S.E. by Abr^m Caridens Land. It hath such shape and marks
 as the annex^d plat Represents. Survey^d 25th Augth 1784

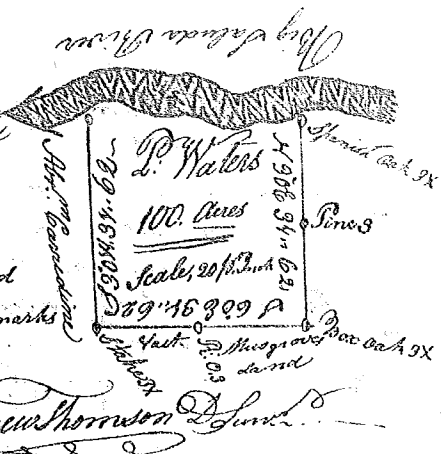

Recorded the 25th Sept^r 1784

Andrew Thomson Esq.

State of Sth Carolina 96 District
 Pursuant to a warrant to me Directed
 By John Thomas Esq^r Commissioner of Locations for
 the District of the north side of Saluda River - I have
 Survey^d and laid out unto Henry Wells a tract of land
 containing 320 acres situated lying and
 below the ancient Boundary line
 on both sides of Beaverdam erected for
 a forest bounded N.E. by Rich^d Harrisons
 Land S.W. by the Road from Nicolls Mill
 to the Iron Works all other sides vacant
 and has such shape and marks as the
 annex^d plat Represents. Survey^d
 by me the 4th Augth 1784 James Seaborn Esq.

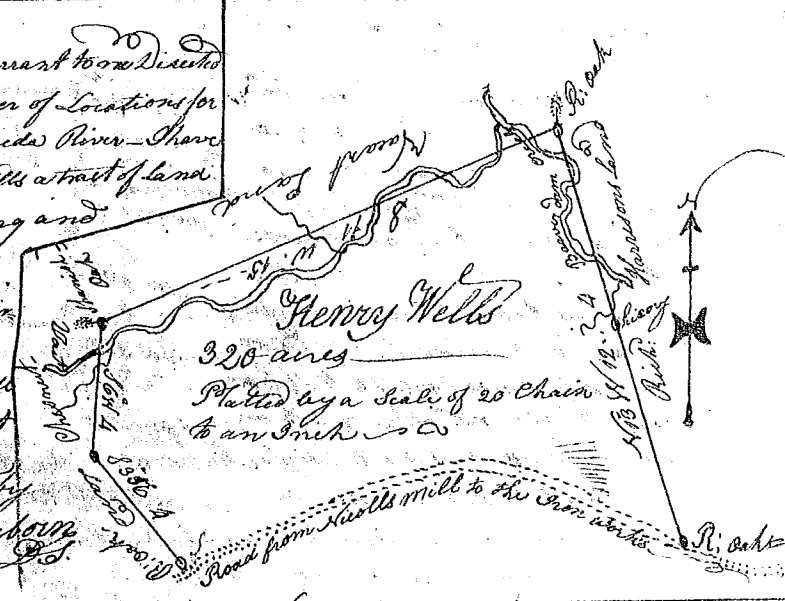

Recorded the 25th Sept^r 1784

State of Sth Carolina Ninety Six District
 Pursuant to a warrant to me Directed by
 John Thomas Esq^r Commissioner of Locations for the
 Dist^{ct} of the North side of Saluda River I have mea-
 -sured and laid out unto Robert Rembrals a tract of
 Land containing 200 acres. & situated lying and be-
 -ing below the ancient Boundary line on both sides
 of Lawson's fork of Pacolet, bounded N.E. by Maria Harpers Land
 and S.W. by Edmond Bishop's Land E. by Peter Lewis's Land
 all other sides vacant, and has such shape and
 marks as the annex^d plat Represents. Survey^d
 by me the 20th Sept^r 1784 J^{as} Seaborn Esq.

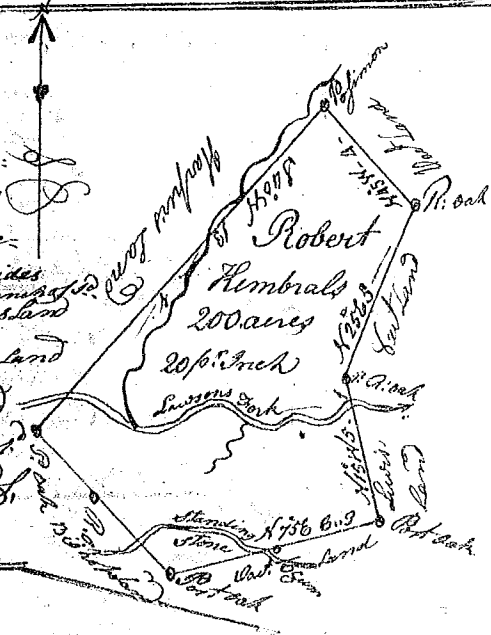

Recorded the 25th Sept^r 1784