

South Carolina

Pursuant to a warrant Directed under the hand and seal of John Thomas Esq. Commissioner of Locations for Ninety six district North of Saluda River dated the 27th day of August 1784 I have admeasured and laid out unto John Huger a tract of land containing six hundred and forty acres, situate lying and being on the branches of Saluda Riv. and the head branches of the Golden Grove Creek a branch of said Riv. Bounding on all sides by Vacant Land, and hath such shape form and Marks as the above Plat represents.

Surveyed the 31 day of August 1784
 Thomas Lewis Esq.
 Recorded 10th day of Sept. 1784

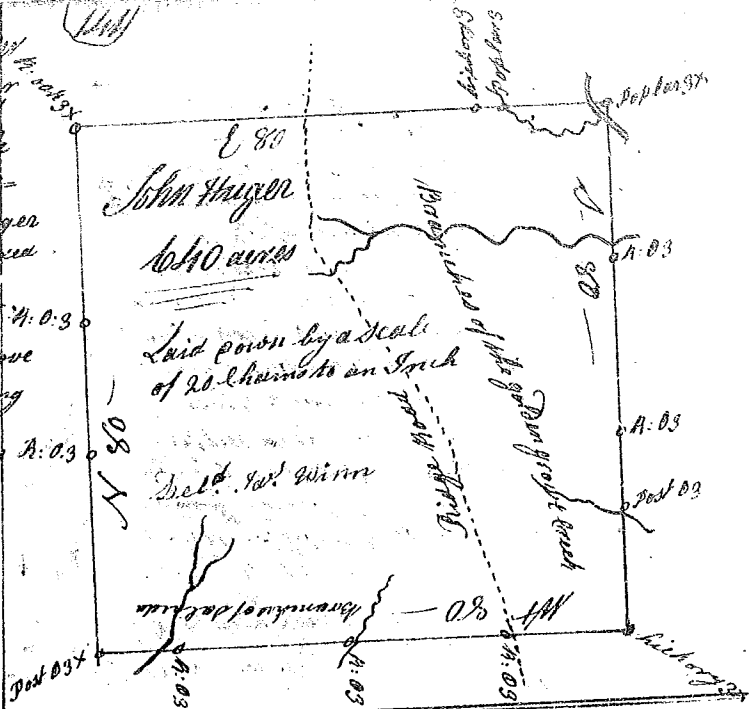

South Carolina.

Pursuant to a warrant Directed by John Thomas Commissioner of Locations for Ninety six district North of Saluda River dated the 27th day of August 1784 I have admeasured and laid out unto Mary Huger a tract lying of land containing six hundred and forty acres situate lying and being above the Indian old boundary line on Flat Rock Creek and Cornwells fork, branches of horse creek of Treedy River Bounding on the NW on land laid out to Thomas Lewis on the SW on land laid out to Sophia Sexton and Vacant Land, all other sides on Vacant land and hath such shape form and Marks as the annexed Plat represents.

Surveyed the 1st day Sept. 1784
 Thomas Lewis Esq.
 Recorded 10th Sept. 1784

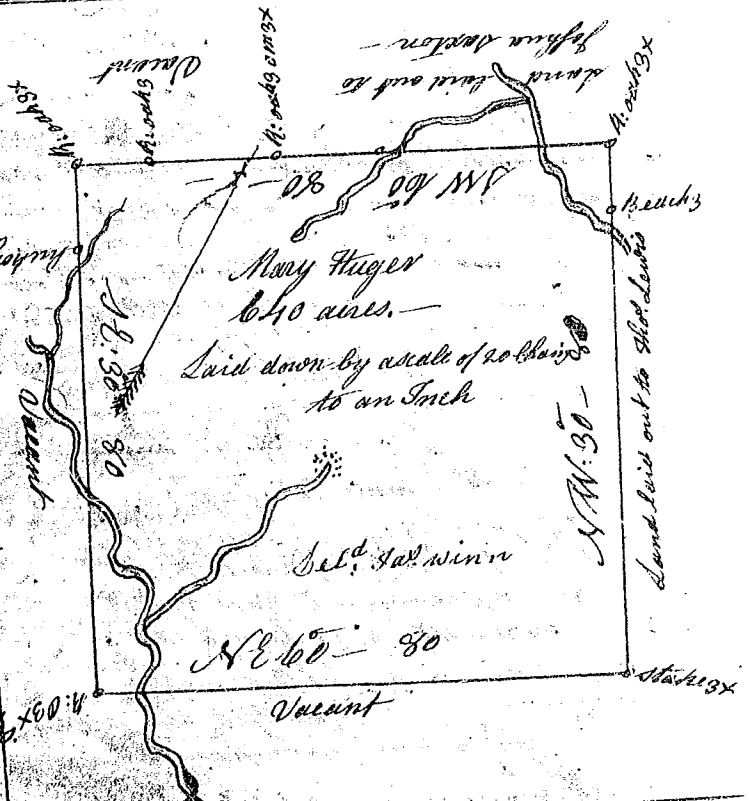

State of South Carolina Ninety six district East side ancient boundary line Pursuant to a warrant forth under the hand and seal of John Thomas Esq. Commissioner of Locations North side Saluda River bearing date the 5th July 1784 I have admeasured and laid out unto Philimon waters a tract of land containing forty acres lying on the North side Saluda River bounded to the South by said Riv. to the NW by said Philimon waters and to the SE by Prepinet's land and hath such shape and Marks as the annexed Plat represents, - Surveyed 25 Aug. 1784

Recorded 23 Sept. 1784.

Andrew Thomson Esq.

