

State of South Carolina 96 District.

(132)

Pursuant to a warrant to me Directed by John Thomas Esq. Commissioner of Locations for the District of North side of Saluda River. I have surveyed and laid out unto John Smith a tract of Land containing two Hundred Acres Situate lying and being below the Ancient Boundary line, on the North east Branch of Lawsons fork of Pisquet River Bounded N. Eastwardly by John Connors Land all other sides Vacant, and has such shape and marks as the Annexed plat Represents.

Surveyed by me the 5th of Sept. 1784

Recorded the 11th Sept. 1784

Del. to Mr. Johnston, J. Seaborn D.S.

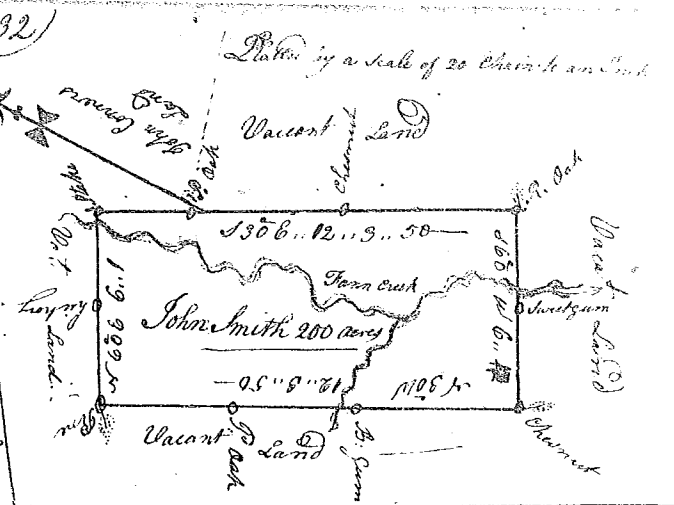

State of South Carolina 96 District.

Pursuant to a warrant to me Directed by John Thomas Esq. Commissioner of Locations in the District of the North side of Saluda River. I have surveyed and laid out unto John Wallace a tract of Land containing 75 Acres, Situate lying and being above the Ancient boundary line, on the north side of the South fork of Saluda River. Near the upper end of Wallaces Improvement Bounded N. E. by the River all other sides Vacant and has such shape and marks as the Annexed plat Represents.

Surveyed by me the 24th of June 1784

Recorded the 11th Sept. 1784

Del. to Mr. Johnston, J. Seaborn D.S.

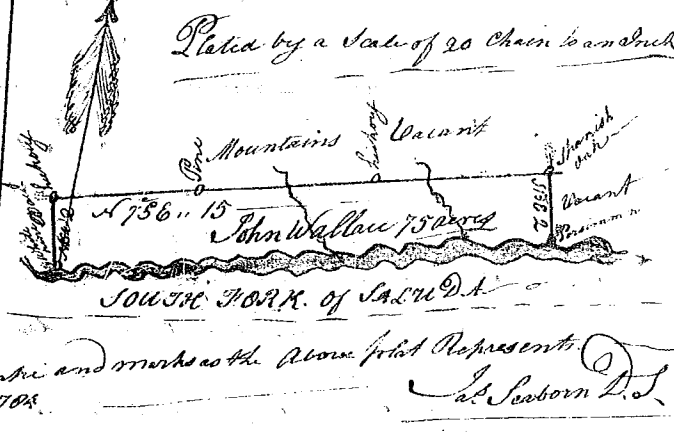

State of South Carolina 96 Dist.

Pursuant to a warrant to me Directed by John Thomas Esq. Commissioner of Locations for the District of the north side of Saluda River. I have surveyed and laid out unto John Johnson a tract of Land containing two Hundred acres, Situate lying and being below the Ancient Boundary line on the waters of S. Pisquet River. Bounded N. E. by John Connors Land N. E. by Great Kings Land all other sides Vacant, and has such shape and marks as the Annexed plat Represents.

Surveyed by me the 5th of August 1784

Recorded the 11th Sept. 1784

Del. to Mr. Johnston, J. Seaborn D.S.

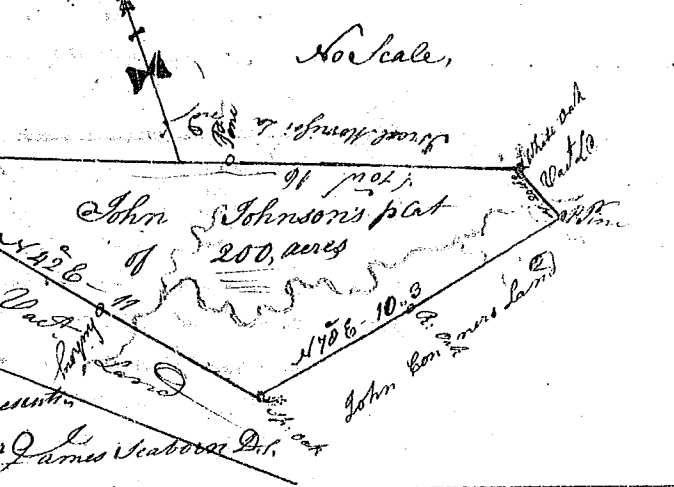

State of South Carolina Pursuant to a warrant

to me Directed by John Thomas Esq. Commissioner of Locations for the District of the North side of Saluda River. I have surveyed and laid out unto Thomas Woods a tract of Land containing three Hundred Acres, Situate lying and being above the Old Indian boundary on both sides of Muckley branch a Branch of Reddy River. Vacant land on every side and has such shape and marks as the Annexed plat Represents.

Surveyed by me the 2^d of June 1784

Recorded the 11th Sept. 1784

Del. to Mr. Johnston, J. Seaborn D.S.

