

State of South Carolina

(130)

Pursuant to a warrant from John Thomas Esq. Commissioner of Locations, I have Admeasured and laid out unto James Savage a tract of Two hundred and Twenty four acres & a half of Land, & situate in Kinetyler District on the waters of Broad River, Bounding N.W. on Jonathan Potts land S.W. on Richard Addison and E. on Capt. Hughs, and all other sides on Vacant Land. And hath such shape and marks as the Annexed plat Represents, Surveyed the 26<sup>th</sup> day of Aug<sup>r</sup> 1784  
 Recorded the 10<sup>th</sup> Sept<sup>r</sup> 1784  
 David Hopkins D<sup>r</sup>

Plotted by a scale of 20 Chains to an Inch

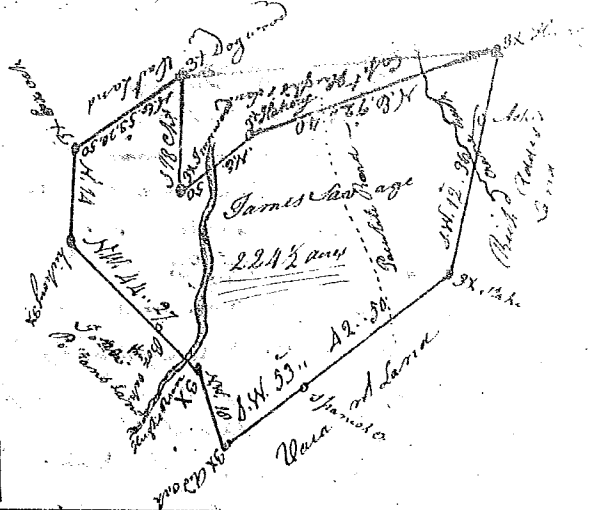

State of South Carolina

Pursuant to a warrant from John Thomas Esq. Commissioner of Locations, I have Admeasured and laid out unto Joseph Hughs a tract of one hundred and fifty acres of Land, & situate in Kinetyler District on the waters of Broad River, Bounding N.E. on Vacant Land and Broad River S.W. on Land laid out to Hugh Nelson & Vacant Land, and hath such shape and marks as the Annexed plat Represents, Surveyed the 26<sup>th</sup> Aug<sup>r</sup> 1784  
 Recorded the 10<sup>th</sup> Sept<sup>r</sup> 1784  
 David Hopkins D<sup>r</sup>

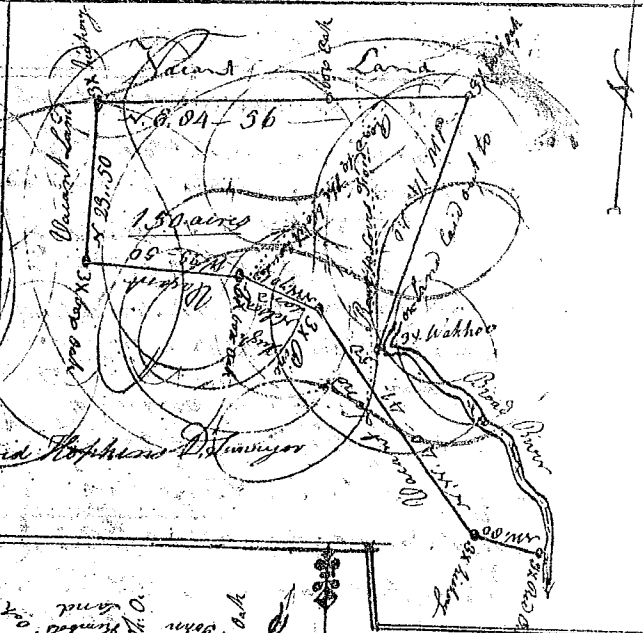

State of South Carolina 96 Dist<sup>ct</sup>

Pursuant to a warrant to me Directed by John Thomas Esq. Commissioner of Locations, for the Dist<sup>ct</sup> of the North Side of Saluda River, I have Surveyed and laid out unto Joseph Vennable a tract of Land containing two Hundred acres, Situate lying and being below the Ancient Boundary line on Thomsons Creek of South Carol<sup>a</sup>. In part by said Vennable, Bounded N.W. by John Himbols Land, all other sides Vacant and has such shape and marks as the Annexed plat Represents, Surveyed by me the 16<sup>th</sup> July 1784  
 Recorded the 10<sup>th</sup> Sept<sup>r</sup> 1784  
 James Seaborn D<sup>r</sup>

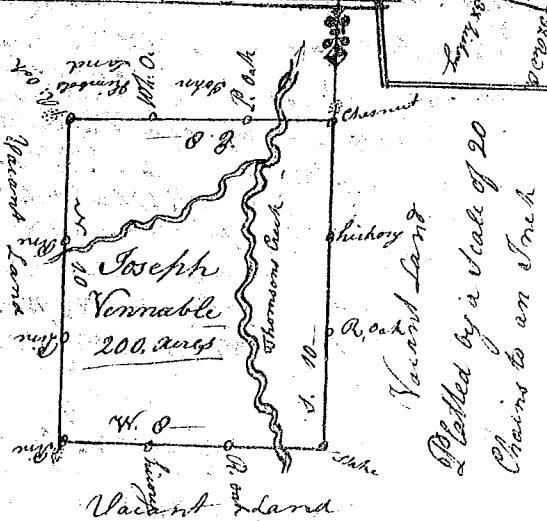

State of South Carolina 96 District

Pursuant to a warrant to me Directed by John Thomas Esq. Commissioner of Locations for the Dist<sup>ct</sup> of the North Side of Saluda River, I have Surveyed and laid out unto John Himbol a tract of Land containing One hundred acres, Situate lying and being below the Ancient Boundary, on Thomsons Creek of South Carol<sup>a</sup>, Bounded N.W. by Thomas Bunnet & E. by Joseph Vennable and the other sides Vacant, and has such shape and marks as the Annexed plat Represents, Surveyed by me the 16<sup>th</sup> July 1784  
 Recorded the 10<sup>th</sup> day of Sept<sup>r</sup> 1784  
 James Seaborn D<sup>r</sup>

