

State of South Carolina 96 District

Pursuant to a Warrant to me Directed by John Thomas Esq. Commissioner of Locations for the District of the north side of Saluda river I have Surveyed and laid out unto John Poff a tract containing 224 Acres Situate Lying and Being above the Ancient Boundary Line on Enrice River. Bounded N.E. by Henry Bensons Land and S.E. by Isaac Morgans land the Other sides Vacant and hath shape and marks as the above plat Represents. Surveyed by me the 20th Day of June 1784 Recorded the 10th of Aug. 1784 James Seaborn D.

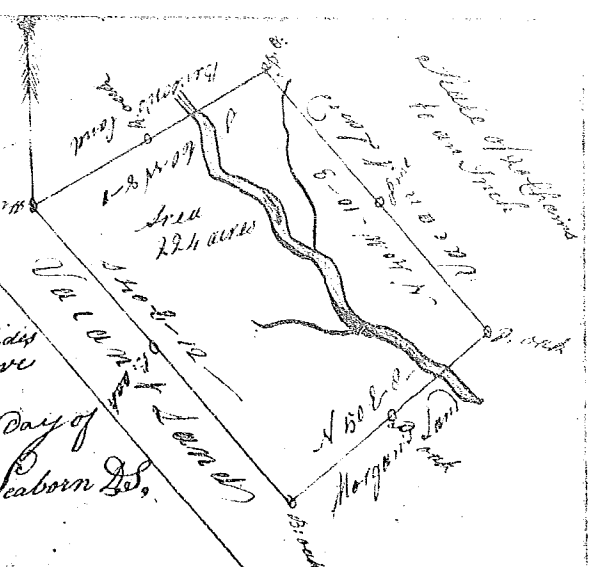

State of South Carolina 96 District
 Pursuant to me Directed by John Thomas Esq. Commissioner of Locations for the District of the north side of Saluda. I have Surveyed and laid out unto Tho. Woods tract of land containing 145 acres Situate lying and Being above the Ancient Boundary line on Camp Creek a branch of the Middle fork of Saluda Bounded on the West by John Brannons Land and on Every other side Vacant and hath such shape and marks as the above plat Represents. Surveyed by me the 19th of July 1784 Recorded the 16th Day of August 1784 James Seaborn D.

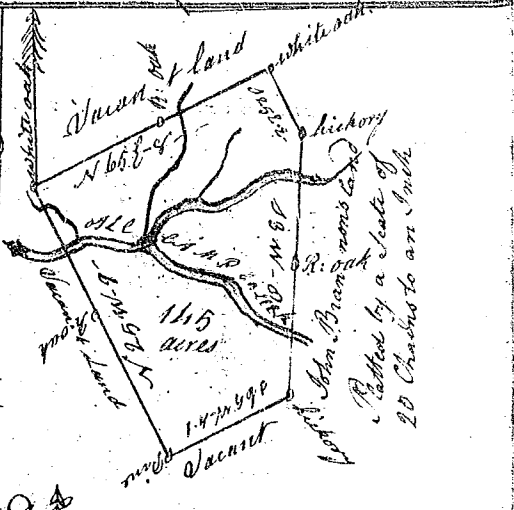

State of South Carolina 96 District
 Pursuant to a Warrant to me Directed by John Thomas Esq. Commissioner of Locations for the District of North side of Saluda I have Surveyed and laid out unto Isaac Brown a Tract of Land containing 500 Acres Situate Lying and being above the Ancient Boundary Line on Saluda River, and Checharoa River. First Surveyed by Brown. Bounded on the East by Saluda River on all other sides Vacant and hath such shape and marks as the above plat Represents. Surveyed by me the 24th Day of May 1784 Recorded the 10th Day of Augt. 1784 James Seaborn D.

