

State of South Carolina (80)

Pursuant to a warrant from John Thomas Esq: dated the 21st day of May 1784 I have admeasured and laid out unto Abraham Hill a tract of Three hundred Acres Land situate in Ninety Six district on Carrel's Branch waters of Greedy River Bounding on all sides by Vacant Land and hath such shape and Marks as the above plat represents

Surveyed the 15th day of June 1784  
 Wm. Benson Esq:  
 Recorded the 7th day August 1784

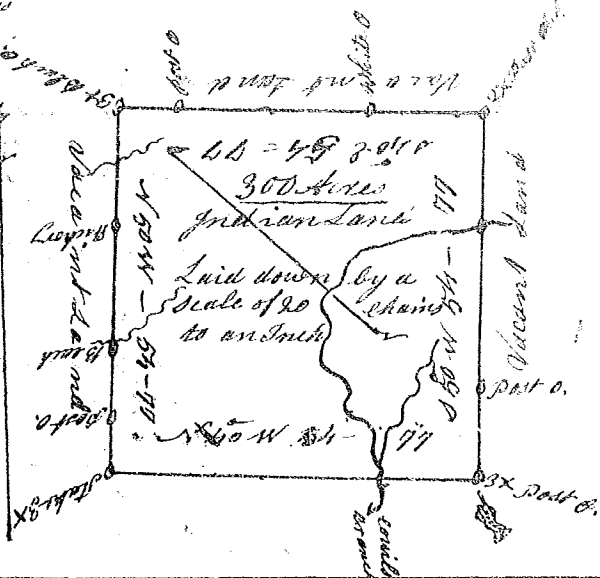

State of South Carolina

Pursuant to a warrant from John Thomas Esq: Commissioner of Locations dated the 6th day of June 1784 I have admeasured and laid out unto Samuel Pader a tract of Two hundred Acres Land situate in Ninety Six district on Rabans Creech Bounded on one side of Land laid out to Samuel Pader and on all other sides on Vacant Land, and hath such shape and Marks as the above plat represents

Surveyed the 15th day of June 1784  
 Wm. Benson Esq:  
 Recorded the 7th day of August 1784

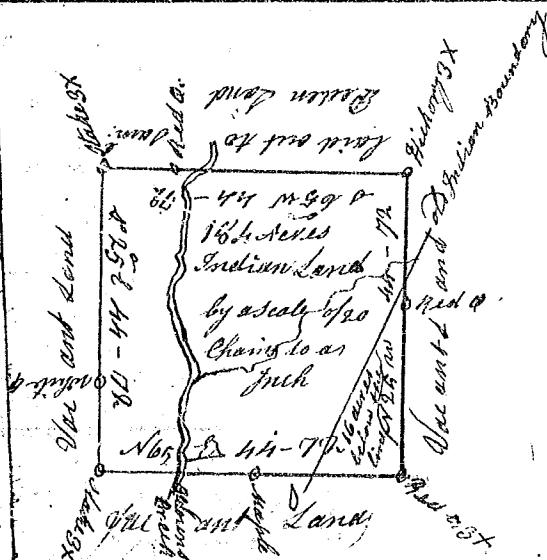

State of South Carolina

Pursuant to a warrant from John Thomas Esq: Commissioner of Locations dated the 21 day of May 1784 I have admeasured and laid out unto Charles Benson a tract of four hundred and eighty three Acres of land situate in Ninety Six district on both sides of Greedy River Bounding on all sides by Vacant Land, and hath such shape and Marks as the above plat represents

Surveyed the 31st day of May 1784  
 Wm. Benson Esq:  
 Recorded the 7th day of August 1784

