

The sales area consists of approximately 220 acres of the above described tract and is located in the northern portion of the tract off of Highway S-23-116. The sales area is more particularly shown on the below sketch by Jack Sherrill and Associates, Inc.

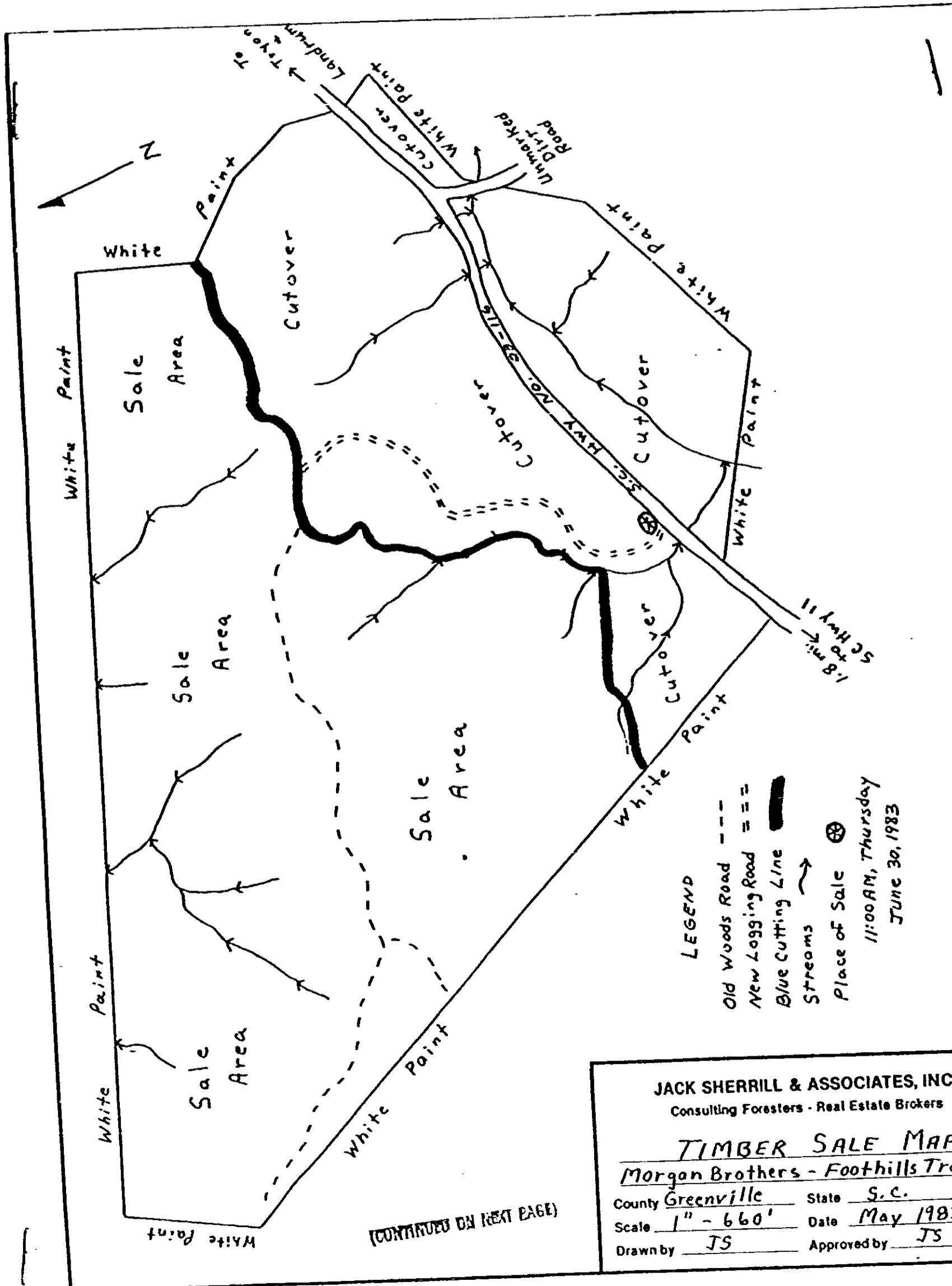

LEGEND
 Old Woods Road ---
 New Logging Road ===
 Blue Cutting Line [thick blue line]
 Streams ~~~~~
 Place of Sale ⊗
 11:00 AM, Thursday
 June 30, 1983

JACK SHERRILL & ASSOCIATES, INC.
 Consulting Foresters - Real Estate Brokers

TIMBER SALE MAP
 Morgan Brothers - Foothills Tract

County Greenville State S.C.
 Scale 1" = 660' Date May 1983
 Drawn by JS Approved by JS

(CONTINUED ON NEXT PAGE)

0052

4328-11-21