

15250

Vol 1188 Page 526

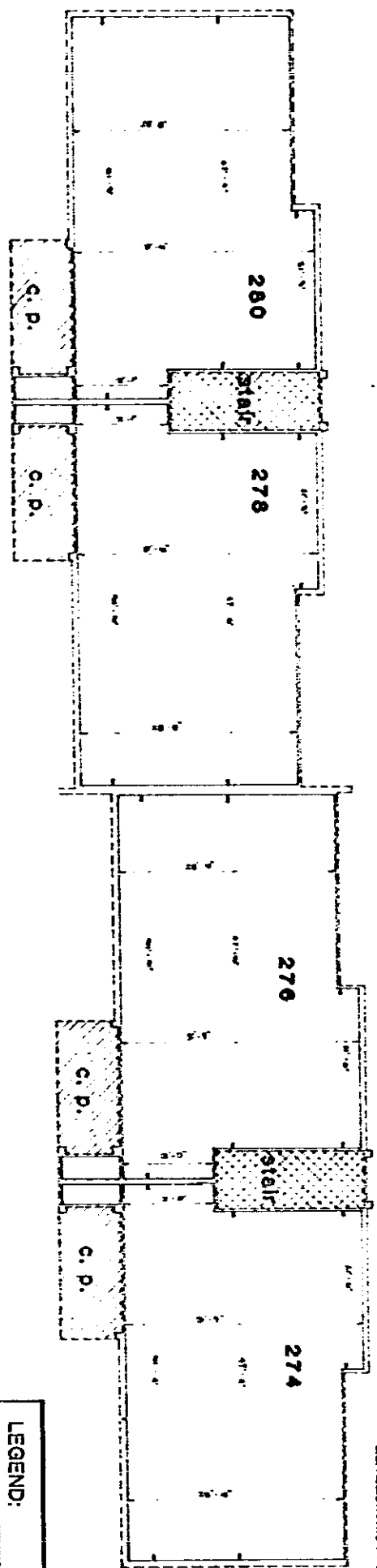
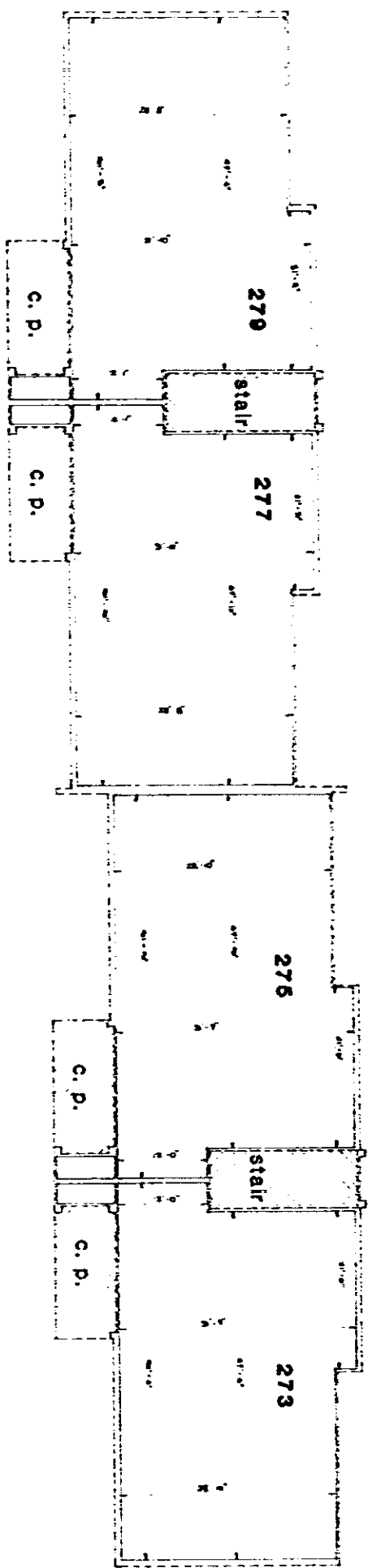

I, ORVILLE V. PLAYER, IN HEREBY CERTIFY THAT THE SE DRAWINGS COMPARE THIS EXHIBIT AND CORRECT ON THE BASIS OF THE SURVEY OF W.H. WILLIAMS, JR. AND THAT THE AS BUILT ARCHITECTURAL DRAWINGS OF MILLER/PLAYER AND ASSOCIATES, ARCHITECTS ARE AVERAGE DIMENSIONS AND SHOULD NOT BE TAKEN AS EXACT MEASUREMENTS.

Orville V. Player, II
 ORVILLE V. PLAYER, II
 S.D. REGISTRATION #1086

LEGEND:

- EXTERIOR WALL LINE
- UNIT BOUNDARY
- GENERAL COMMON ELEMENTS
- LIMITED COMMON ELEMENTS
- C.P. DENOTES CONCRETE PORCH

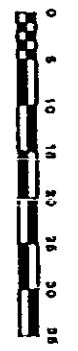

DATE	DESCRIPTION

MILLER/PLAYER & ASSOCIATES
 ARCHITECTS AND PLANNERS, LTD.
 1010 east north street, greenville, s.c.

James B. Miller, A.S.A. / Orville V. Player, II / Robert C. Cochran



15250