

280

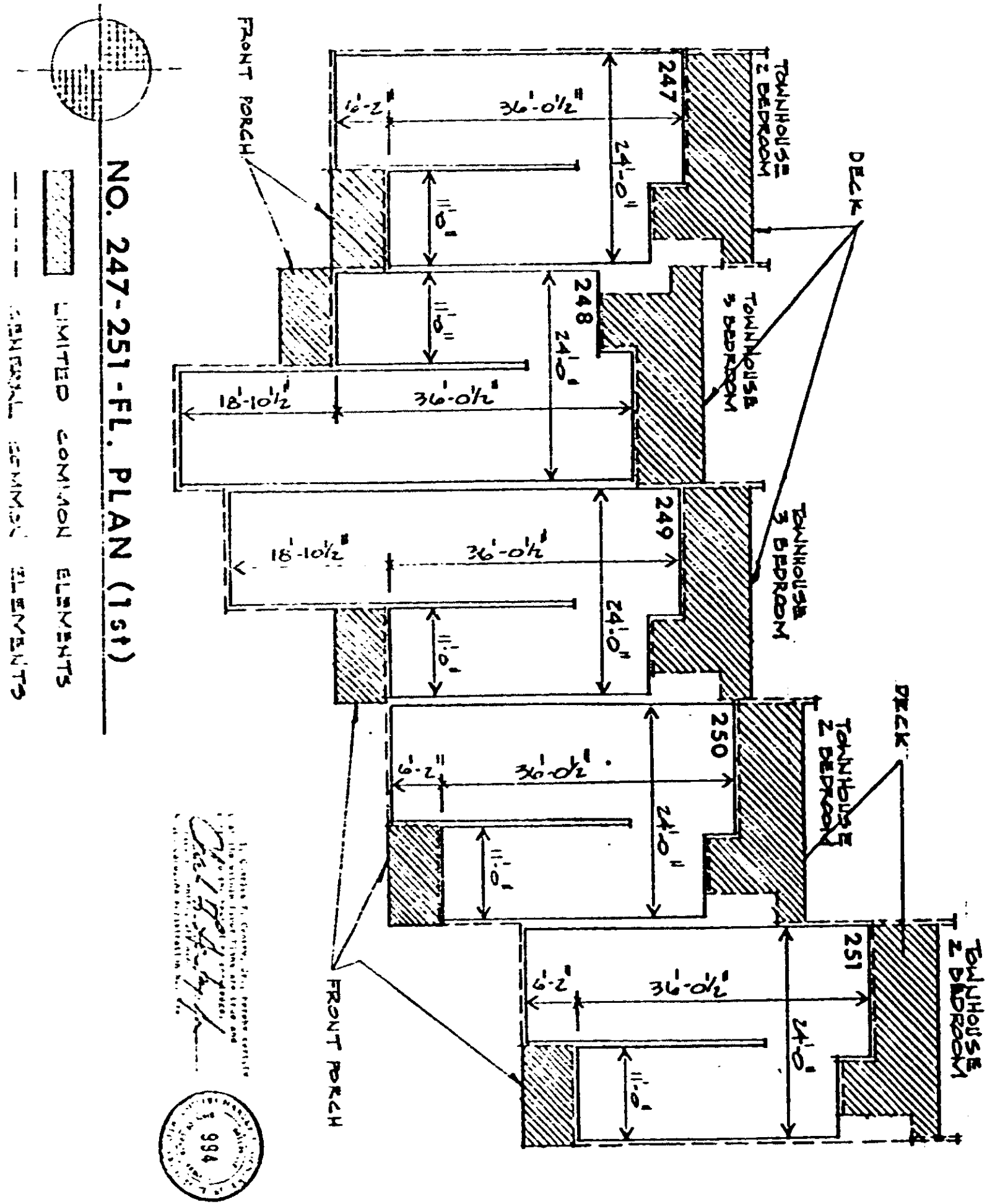

NO. 247-251 - FL. PLAN (1st)

LIMITED COMMON ELEMENTS  
CENTRAL COMMON ELEMENTS

I, CHARLES F. GENTRY, ARCHITECT, REGISTERED PROFESSIONAL ARCHITECT, STATE OF SOUTH CAROLINA, LICENSE NO. 10000, DO HEREBY CERTIFY THAT THE ABOVE IS A TRUE AND CORRECT COPY OF THE ORIGINAL AS SUBMITTED TO THE ARCHITECTURAL BOARD OF THE STATE OF SOUTH CAROLINA.  
 Charles F. Gentry  
 ARCHITECT  
 984

**INGLESIDE HORIZONTAL PROPERTY REGIME**  
**CHARLES F. GENTRY A.I.A. ARCHITECT**  
 GREENVILLE SOUTH CAROLINA

2

1-13-83

4328 RV-21