



TRUST SURVEY  
**PIEDMONT PLAZA**  
FOR  
WESPAC INVESTORS TRUST  
LIMITED PARTNERSHIP  
GREENVILLE COUNTY, SOUTH CAROLINA  
SCALE: 1" = 80'-0"  
MARCH 8 1982

**CONVEYANCE**  
TO THE TRUSTEES OF THE  
WESPAC INVESTORS TRUST  
LIMITED PARTNERSHIP  
FROM THE  
SOUTH CAROLINA TRUST COMPANY  
AS TRUSTEE  
OF THE  
WESPAC INVESTORS TRUST  
LIMITED PARTNERSHIP  
BY  
[Signature]

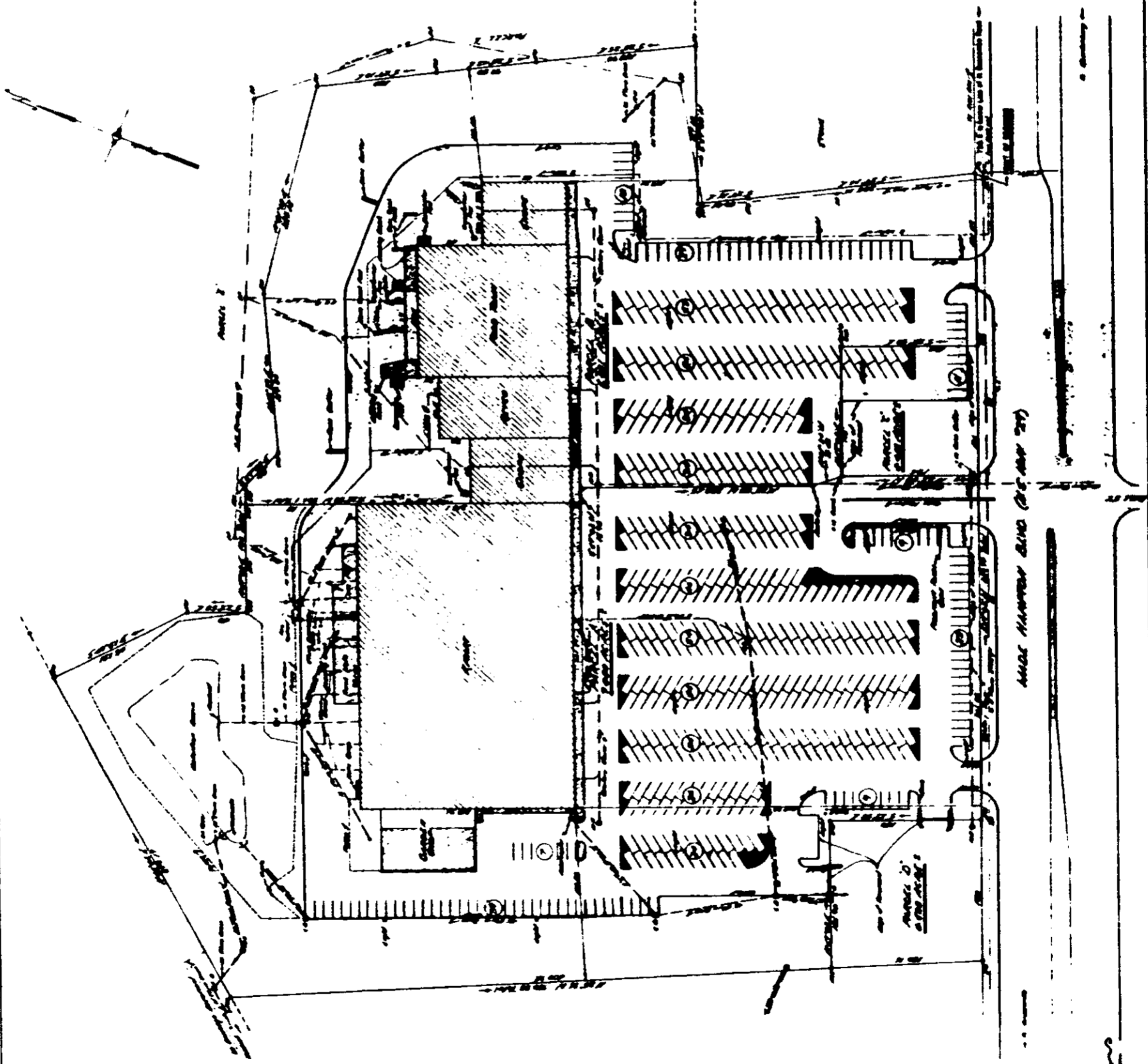

EXHIBIT "A"

[Signature]

PIEDMONT PLAZA  
RECORDED SEP 30 1982 at 12:17 P.M.

7550

819

4328 RV-2