

CORPORATION
72-A

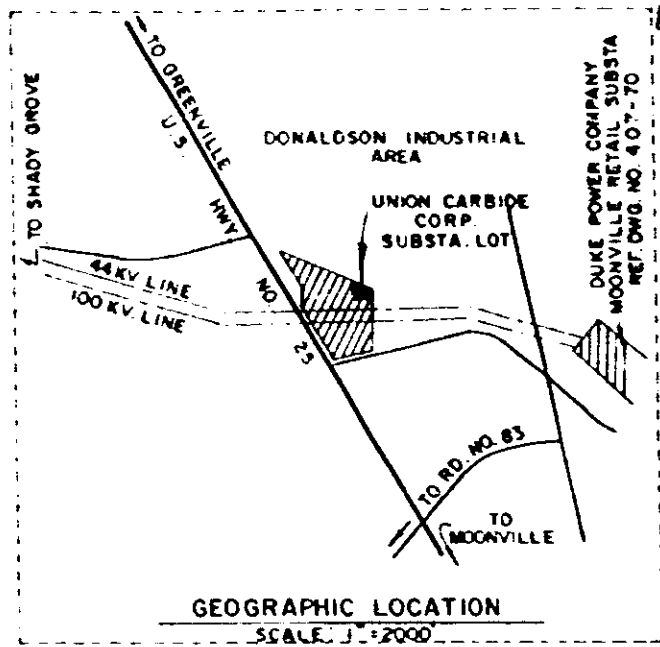

BOOK 1163 PAGE 843

DISTRIBUTION LINE
(TO BE REMOVED)
IKE

CONC. MON.
(f)

UNION CARBIDE
CORPORATION
REF. DWG. NO. 34-15-A

CAREY R. HARRIS, ET AL.
REF. DWG. NO. 35-72-A

S17°16'W - 136.2'

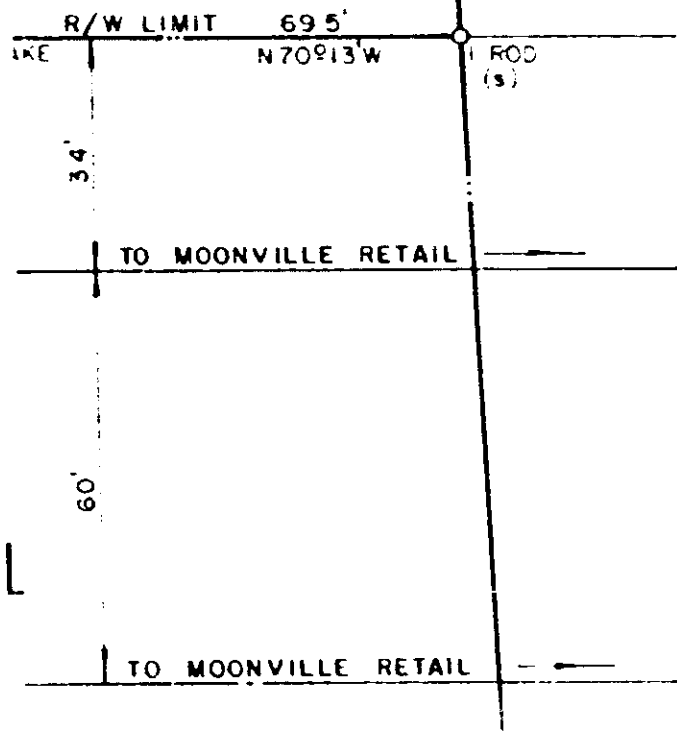

20429

DUKE POWER COMPANY
SUBSTATION LOT
AND
TRANSMISSION LINE
TO SERVE
UNION CARBIDE CORPORATION
"GREENVILLE WORKS PLANT"
GREENVILLE, S.C.
GREENVILLE COUNTY

SCALE 1" = 30'
BOOK NO. 1543

RECORDED
MAR 12 1982
at 10:30 A.M.

NOVEMBER 12, 1981
FILE NO. 161102

0841

4328 RV-2