

E 290

2-23 RV-2

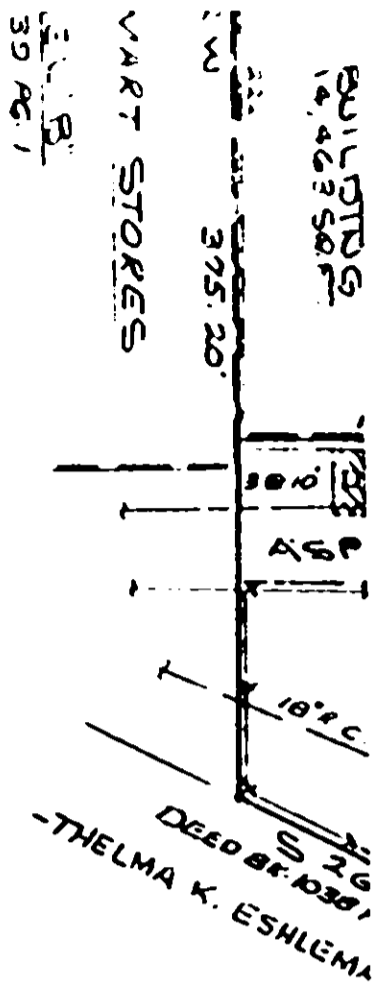

- LEGEND**
- CONC PLANTER w/WALL
 - CONC BENCH
 - PLAY AREA EQUIPMENT
 - CONC. PAD FOR TRANSFORMER
 - CONC. STEPS
 - ROW OF WATER METERS
 - WATER VALVE
 - OUTSIDE LIGHTING
 - FLAG POLE
 - MANHOLE
 - CATCH BASIN
 - CONCRETE

THIS PLAT IS NOT A SUBDIVISION
 AS DEFINED BY THE GREENVILLE
 COUNTY SUBDIVISION REGULATIONS.
 9/25/1979
John B. Gault
 Chairman, Executive Director of
 Planning,
 Greenville County Planning Commission

NOTE: THE STRUCTURES SHOWN ON THIS
 PLAT ARE NOT IN A FLOOD HAZARD AREA
 ACCORDING TO FLOOD HAZARD BOUNDARY
 MAP 4-C1-65 COMMUNITY NO. 4500 69
 PAGE 36 DEPARTMENT OF HOUSING AND
 URBAN DEPARTMENT.

SURVEY FOR
 OR U.S.A. INC.
 GREENVILLE CO. S.C.
 SCALE 7-3-79 - REV. 9-25-79
 ENGINEERS - ARCHITECTS & PLANNERS
 GREENVILLE, S.C.

I JAMES D. CRAIG HEREBY CERTIFY THAT THIS
 PLAT REPRESENTS A SURVEY MADE ON THE
 GROUND UNDER MY SUPERVISION ON JULY 9,
 1979 AND AT THE TIME OF THIS SURVEY THERE
 WERE NO ENCROACHMENTS OTHER THAN
 SHOWN.
James D. Craig
 JAMES D. CRAIG R.L.S. NO. 3720

NOV 26 1979
 17637
 7-9-57

FILED
 GREENVILLE CO. S.C.
 NOV 26 2 43 PM '79
 DONNIE J. JANKERSLEY
 R.M.C.

GREENVILLE CO. S.C. 1 NC2779 422 5.00CI

MICROFILM