

VILLAGE COURT  
WATER & SEWER IN ST. 2/1

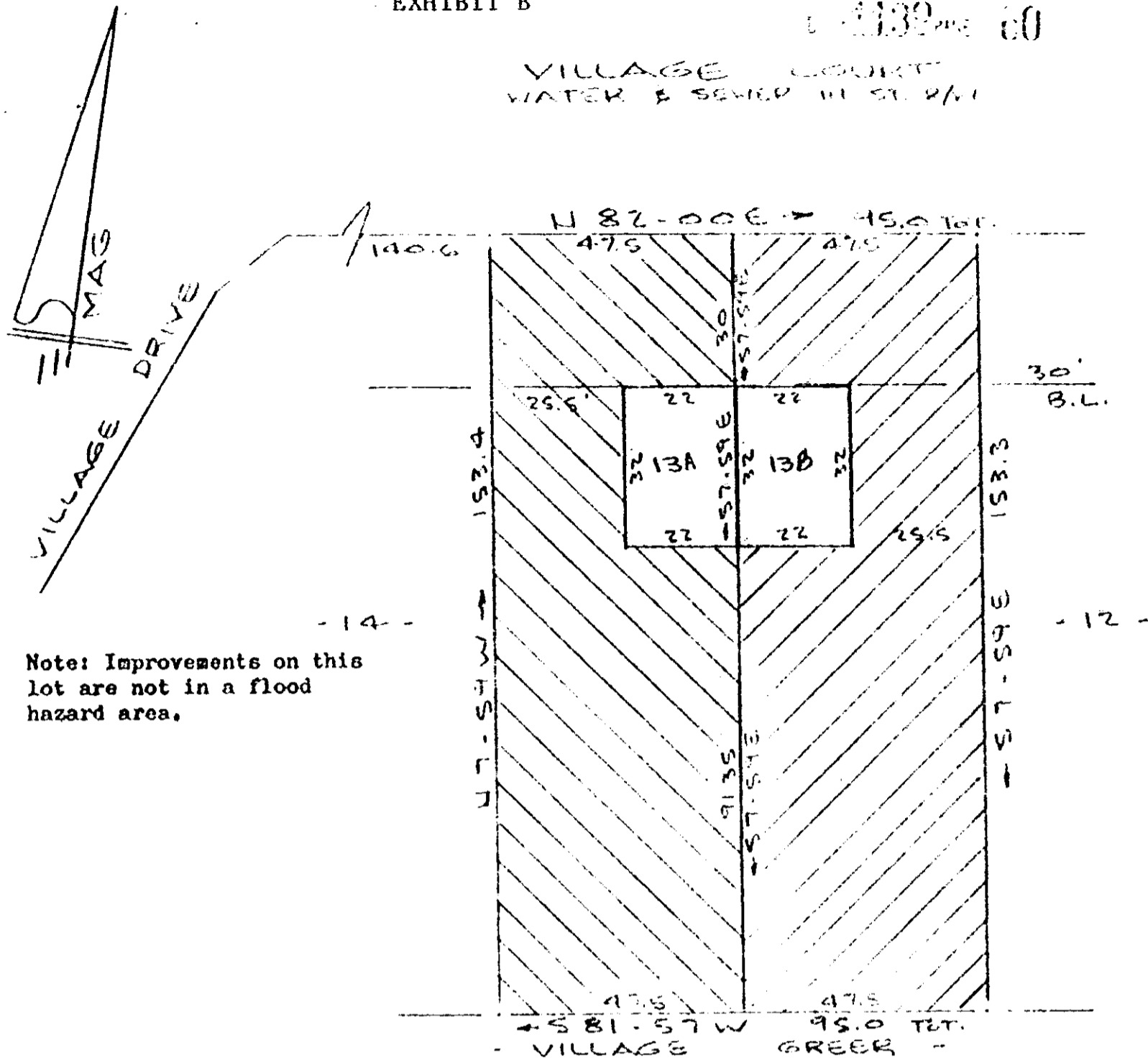

Note: Improvements on this lot are not in a flood hazard area.

- 14 -

- 12 -

LEGEND:  
BOUNDARY OF UNIT ———  
LIMITED COMMON ELEMENTS

PLOT PLAN  
HORIZONTAL PROPERTY REGIMES  
THE VILLAGE TOWNHOUSES NO 13  
GREER, S. C.  
SCALE: 1" = 30' 15 DEC 1980

This is to certify that on the 15th day of December, 1980, I surveyed the property shown on this plat, being known as lot 13 on plat of VILLAGE GREER and recorded in the RMC Office Greenville County, S. C., in Plat Book \_\_\_\_\_ at Page \_\_\_\_\_; and that the property lines, walls and buildings are as shown hereon, and that the walls and buildings located on said lot do not encroach or project on adjacent street or property, and that no adjacent walls or buildings encroach or project on said premises, and no power lines cross this property except as shown hereon.

*R. B. Bruce*  
R. B. Bruce, RLS #1952

CAROLINA SURVEYING CO.  
112 Manly St.  
Greenville, S. C.

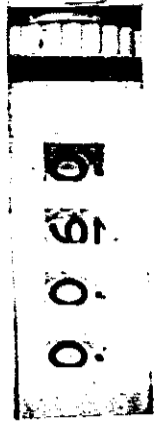

4328 RV-2