

4328 RW-2

5209

RECORDED
AUG 27 1980
at 4:37 P.M.

T. P. WOOD
REF. DWG. NO. 6-612

TO BLUE RIDGE E. M. C.
DEL. NO. 16
N81°25'0"E
397+32.0
34204 RT.

N69°10'W-514.7'
STAKE
S88°50'W-138.3'
ANGLE
IRON
E. 395+070

AREA WITHIN R/W.
LIMITS=1.6 ACRES.

GEORGE M. COOLEY
35.70 AC. TR.

AREA WITHIN R/W.
LIMITS=1.0 ACRE.

HENRY C. ESKEW
REF. DWG. NO. 6-608

Ronald H. Linn
S.C., R.L.S. No. 5387
Duke Power Co.
Charlotte, NC

A. W. PERRY
REF. DWG. NO. 6-607

DUKE POWER COMPANY
TIGERVILLE SUBSTA.
REF. DWG. NO. 34-124 B
156-145

N. M. TINGLE
REF. DWG. NO. 6-606

NOTE
NAME CHANGED 6-5-80

NOTE:
TOTAL AREA WITHIN RIGHT OF WAY
LIMITS = 2.6 ACRES.

DUKE POWER COMPANY
BLUE RIDGE E. M. C. DEL. NO. 16
TRANSMISSION LINE
CROSSING PROPERTY OF
GEORGE M. COOLEY
NEAR TIGERVILLE, S. C.
HIGHLAND TOWNSHIP
GREENVILLE COUNTY

SCALE: 1" = 300'
BOOK NO. 1626
JANUARY 28, 1980
FILE NO. 6-610

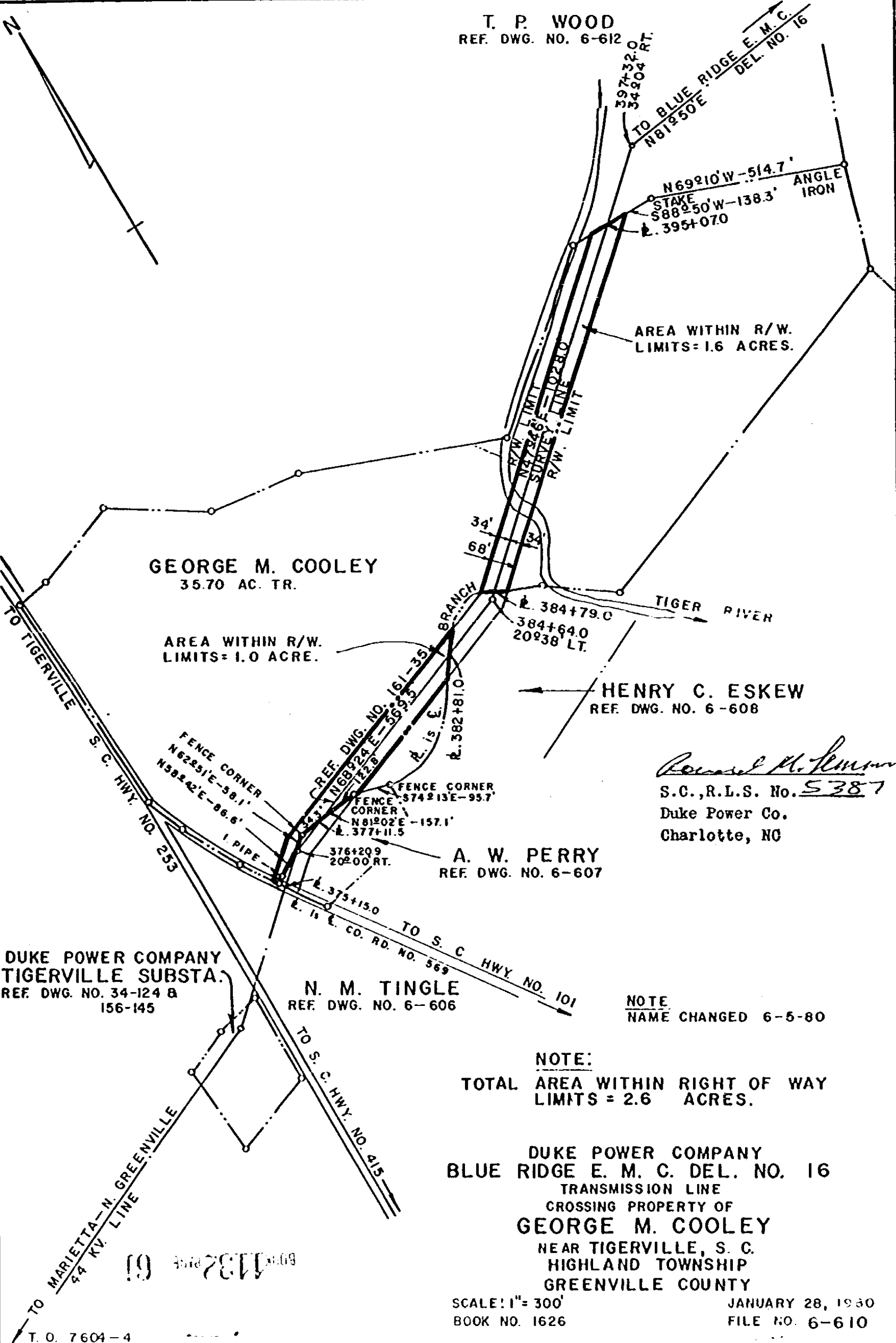

0061

T. O. 7604-4