

MAR 1 3 49 PM '78

DONNIE S. TANNERSLEY  
R.M.C.

RIGHT-OF-WAY EASEMENT

In consideration of the sum of money hereinafter set out and other good and valuable consideration, the adequacy and receipt of which is hereby acknowledged from the Southern Bell Telephone and Telegraph Company, the undersigned, owner(s) of the premises described below, do hereby grant to the Southern Bell Telephone and Telegraph Company its licensees, agents, successors, assigns, and allied and associated companies, a right of way easement to construct, operate, maintain, add or remove such lines or systems of communications or related services as the grantee may require, consisting of:

- (1) poles, guys, anchors, aerial cables and wires;
- (2) buried cables and wires, cable terminals, markers, splicing boxes and pedestals;
- (3) conduits, manholes, markers, underground cables and wires;
- (4) and other amplifiers, boxes, appurtenances or devices

upon over and under a strip of land \_\_\_\_\_ feet wide across the following lands in GREENVILLE County, State of South Carolina generally described as follows:

THE PARCEL OF LAND BOUNDED ON THE NORTH BY PROPERTIES OWNED BY ELLIE H. FREEMAN AND ON THE EAST AND SOUTH BY PROPERTIES OWNED BY KIMBROUGH-KAVENAUUGH & ASSOC. INC. THIS PARCEL IS DESCRIBED ON THE GREENVILLE COUNTY TAX MAPS # 547.2, BLOCK 1 LOT 16.2

and, to the fullest extent the undersigned has the power to grant, if at all, over, along and under the roads, streets or highways adjoining or through said property.

The following rights are also granted: to allow any other person or company to attach wires or lay cable or conduit within the right of way for communications or electric power transmission or distribution; ingress and egress to said premises at all times; to clear the land and keep it cleared of all trees, undergrowth or other obstructions within the easement area; to trim and cut and keep trimmed and cut all dead, weak, leaning or dangerous trees or limbs outside of the easement area which might interfere with or fall upon the lines or systems of communications or power transmission or distribution.

The receipt of ONE and NO /10/ dollars (\$ 1.00 ) is hereby acknowledged by the undersigned.

To have and to hold the above granted easement unto Southern Bell Telephone and Telegraph Company, its successors and assigns forever.

IN WITNESS WHEREOF, the undersigned has \_\_\_\_\_ signed and sealed this document caused this instrument to be executed by its duly authorized agent

Aug 10, 1977  
Signed, sealed and delivered  
in the presence of:

Hinda L. Drumheller  
Witness

Robert D. McCraw

\_\_\_\_\_ L.S.

\_\_\_\_\_ L.S.

Relex Mountain APARTMENTS LTD  
Name of Corporation

1239  
\_\_\_\_\_  
Corporate Officer

By: Billy P. Madwick, Sr.  
Title: PARTNER

6610  
304  
178  
1239  
2:00CT

Name and File No. \_\_\_\_\_  
Post Office Address of Grantor: ROPER MOUNTAIN APARTMENTS  
P.O. Box 1030  
THOMASVILLE, NORTH CAROLINA 27360

Toll Line \_\_\_\_\_ (Name)  
or Exchange Line: GREENVILLE, SOUTH CAROLINA  
tributary to: \_\_\_\_\_ (Exchange)

The Property is bounded where the line enters and leaves this property by the property of:

ELLIE H. FREEMAN on the NORTH  
and Kimbrough-Kavanaugh & Assoc. on the EAST AND SOUTH

Authority: P-43328 Classification: 45-C

Area: GREENVILLE, SOUTH CAROLINA

Approved: \_\_\_\_\_

Title: \_\_\_\_\_

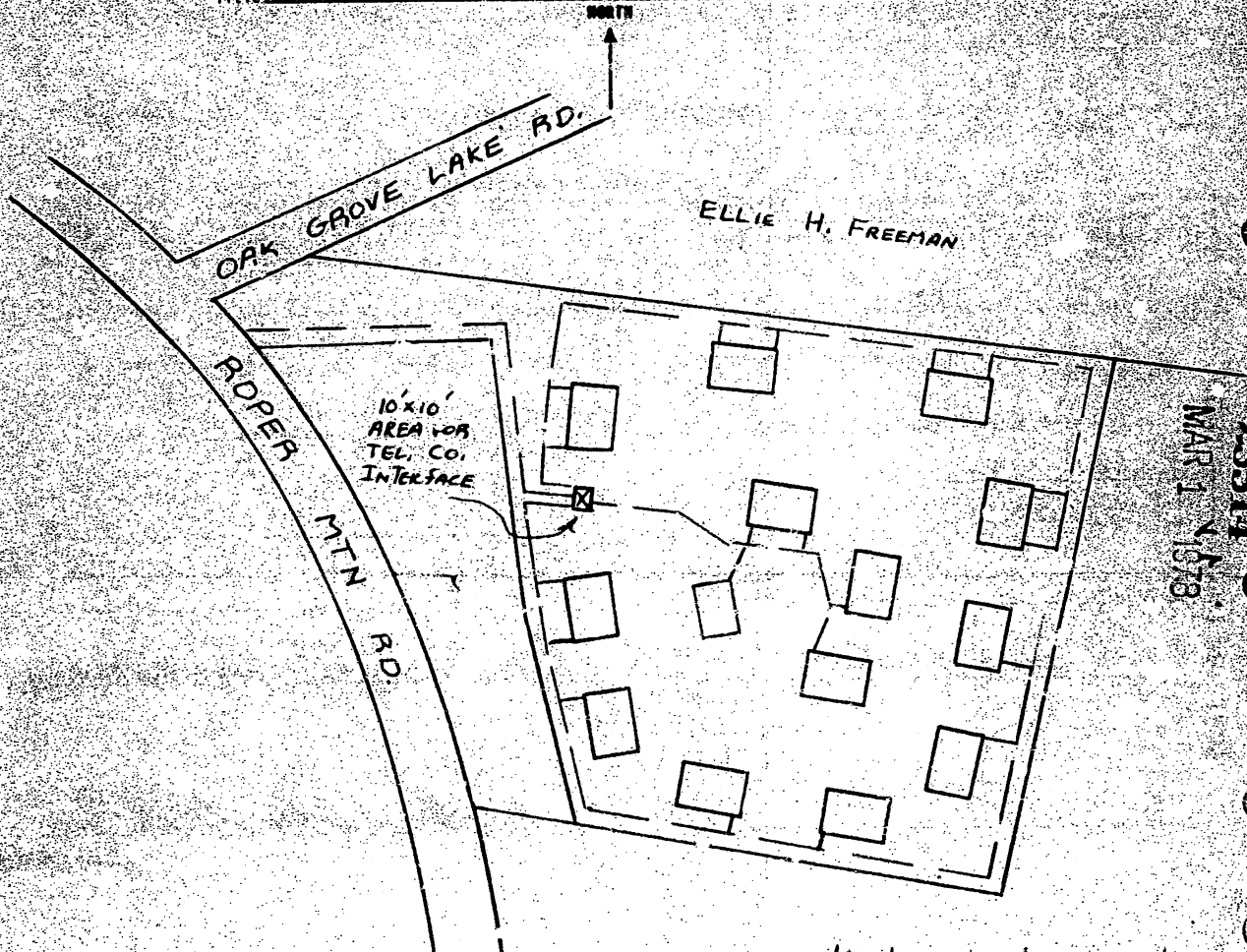

25514  
MAR 1 1978

Kimbrough - KAVENAUgh  
& Assoc. INC.

CORPORATION FORM

STATE OF South Carolina  
COUNTY OF GREENVILLE

VOL 1074 PAGE 576

Personally appeared before me Robert D. McCraw, who, being duly sworn,  
says that he saw Billy P. Shadrick of Roper Mountain  
ApTs, LTD., a corporation, sign and seal the foregoing instrument, and that he, with  
Linda L. Drumheller witnessed the execution and delivery thereof as the act and deed  
of said corporation.

Robert D. McCraw  
Affiant

Sworn to and subscribed before me this 2<sup>d</sup> day of Sept

B. H. H. H.  
Notary Public

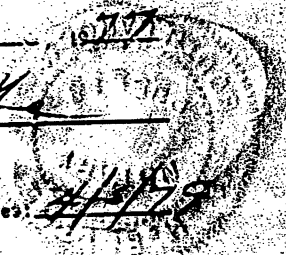

My Commission Expires: 11/1/78

RECORDED MAR 1 1978 At 3:49 P.M.

25511