

THE PEOPLES NATIONAL BANK  
REF DWG NO 53-174-A

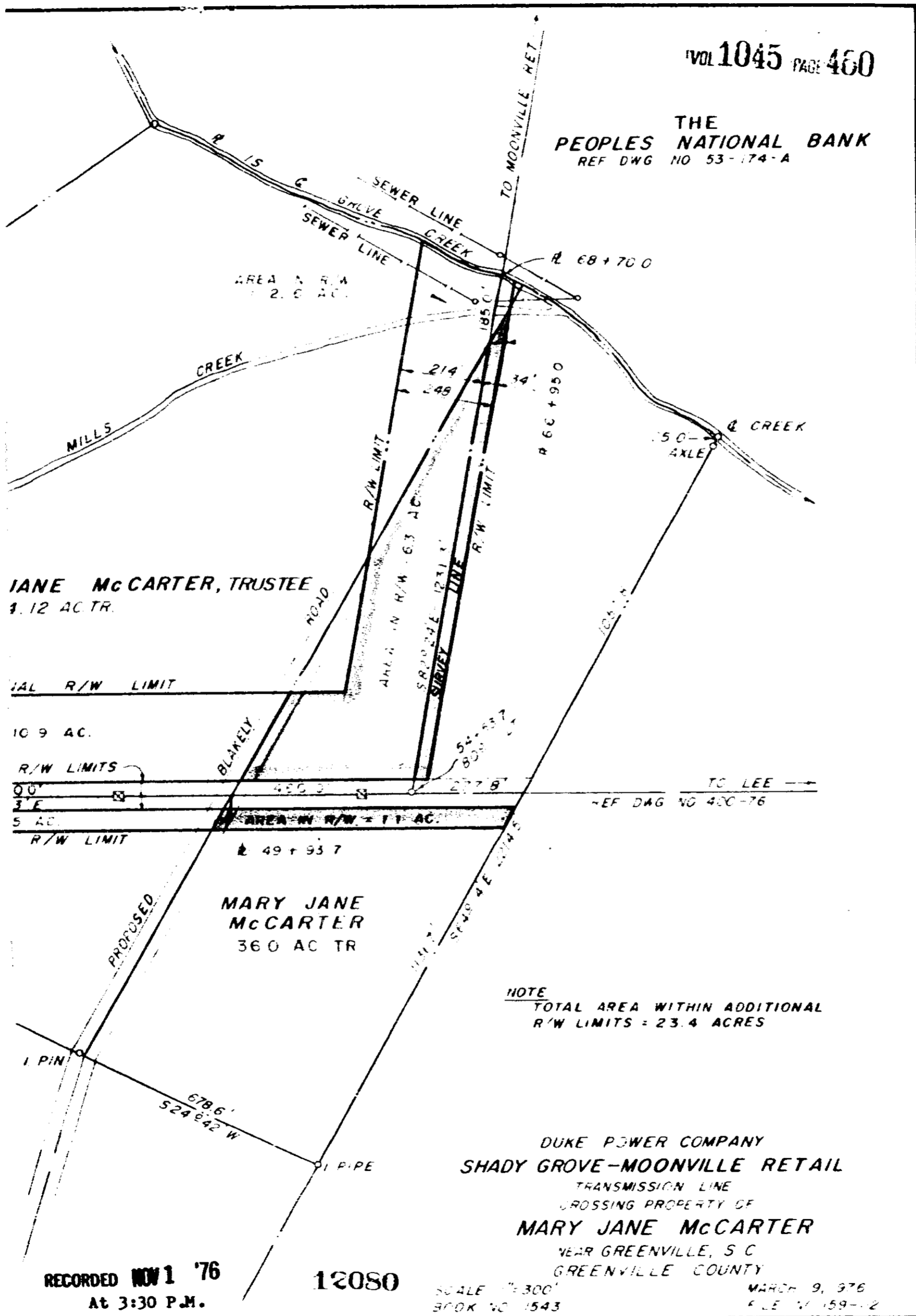

NOTE  
TOTAL AREA WITHIN ADDITIONAL  
R/W LIMITS = 23.4 ACRES

DUKE POWER COMPANY  
SHADY GROVE-MOONVILLE RETAIL  
TRANSMISSION LINE  
CROSSING PROPERTY OF  
MARY JANE McCARTER  
NEAR GREENVILLE, S C  
GREENVILLE COUNTY

RECORDED NOV 1 '76  
At 3:30 P.M.

12080

SCALE 1"=300'  
BOOK NO 1543

MARCH 9, 1976  
FILE NO 159-2

4328 W-2