

VEL 1028 PAGE 390

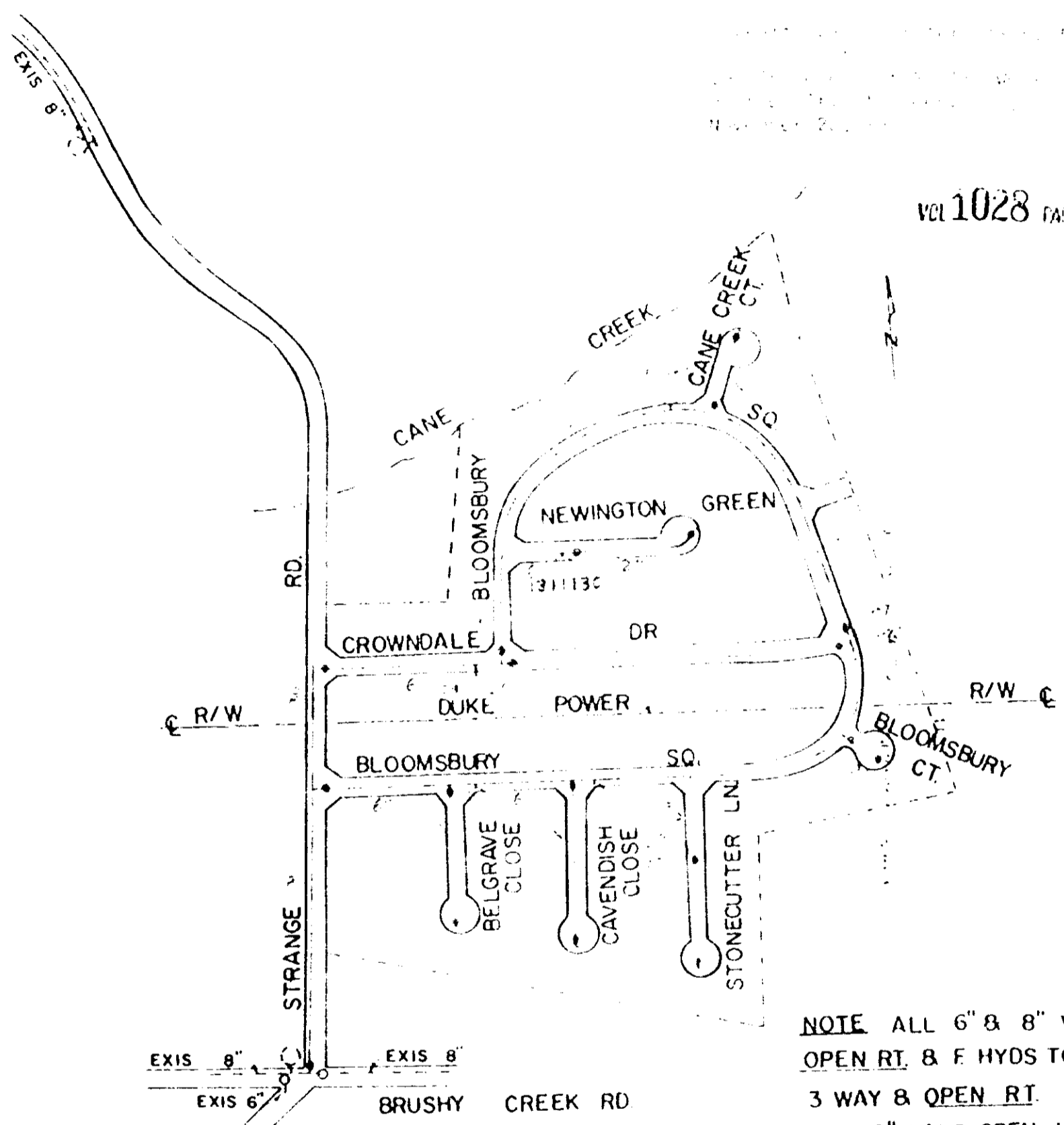

NOTE ALL 6" & 8" VALS.  
 OPEN RT. & F HYDS TO BE  
 3 WAY & OPEN RT.  
 ALL 2" VALS OPEN LT.

MATERIAL USE:

24" Galv. Pipe	1,140.00
6" Galv. Pipe	4,000.00
2" Galv. Pipe	3,000.00
4" Gate Val.	1
6" Gate Val.	1
Pipe Hydrants	11
2" Gate Valve	11

**GREY FOX RUN**  
 APRIL, 1975 SCALE 1" = 400'  
 BLK B 538.4-I-15

RECORDED DEC 9 '75 at 4:08 P.M. 14980

4328 RW-2