

GRADY E.
REESE

MARION W. FORE, JR.
111 AC. TR.

ANNE B. MCGREGOR, ET AL
183 AC. TR.

657.2-1-13

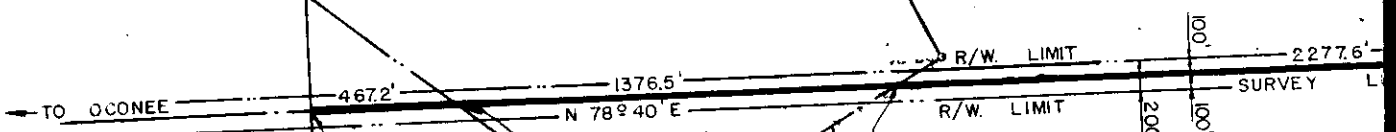

G. W.
JOHNSON

N 89° 24' W
2047+353

GEORGE A. BARTON
128.5 AC. TR.

651.1-1-19

N 2052+02.5
619 50 W

N 48° 33' E

2065+79.0

27.75

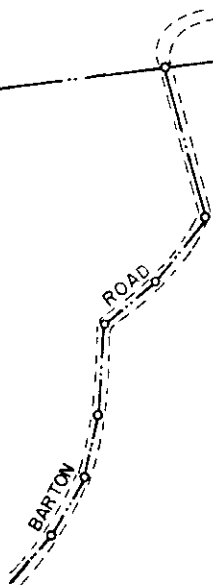

T.O. 7080-138A, 138B, 138C

(Continued on next page)