

GRACE CHARLES MARTIN &
GRACE M. PHILLIPS
CO EXECUTRICES

BERTHA P.
SMITH
REF. DWG. NO.43-105

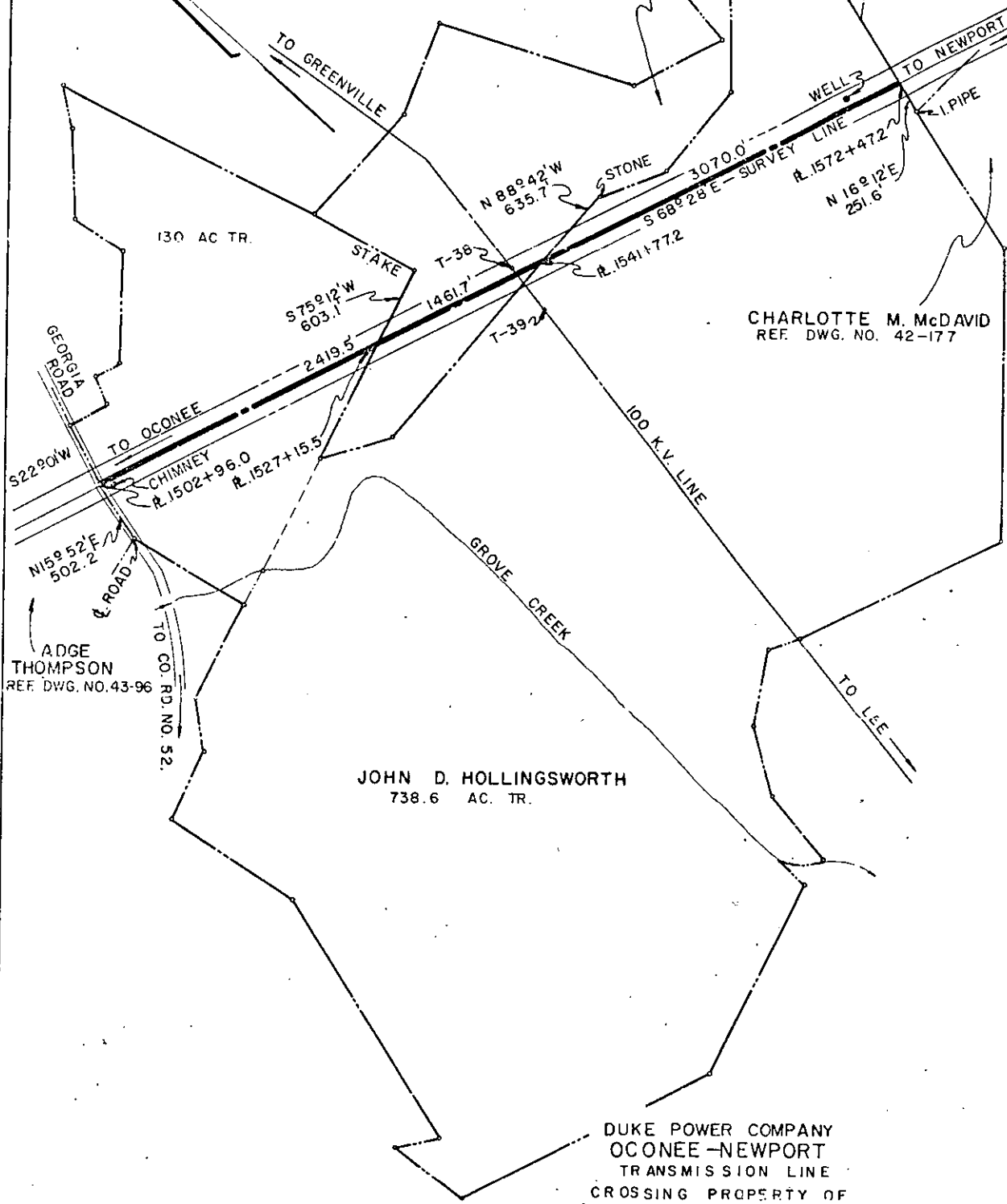

CHARLOTTE M. McDAVID
REF. DWG. NO. 42-177

JOHN D. HOLLINGSWORTH
738.6 AC. TR.

DUKE POWER COMPANY
OCONEE-NEWPORT
TRANSMISSION LINE
CROSSING PROPERTY OF
JOHN D. HOLLINGSWORTH
and
GRACE CHARLES MARTIN &
GRACE M. PHILLIPS CO-EXECUTRICES
NEAR WOODVILLE, S. C.
OAKLAWN TOWNSHIP
GREENVILLE COUNTY

T. O. 7075-122
T. O. 7075-123
T. O. 7075-124

Recorded August 27, 1969 At
3:16 P.M. # 4942

SCALE 1"=1000'
BOOK NO. 1080

APRIL 2, 1969
FILE NO 43-123