

TOM S. BRUCE &
HENRY STEVENS

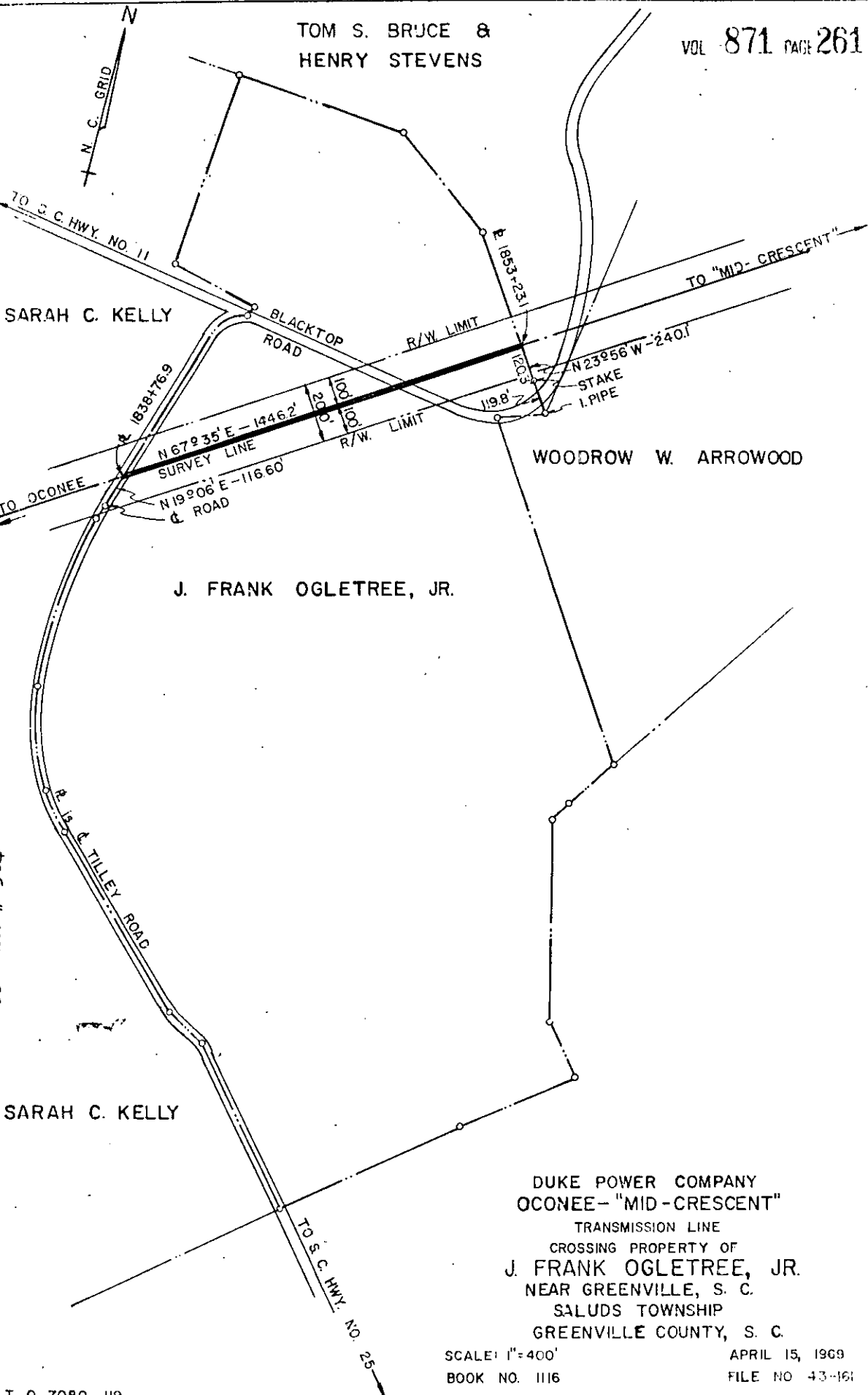

Recorded July 7, 1969 at 11:53 A.M. # 384

DUKE POWER COMPANY
 OCONEE - "MID-CRESCENT"
 TRANSMISSION LINE
 CROSSING PROPERTY OF
 J. FRANK OGLETREE, JR.
 NEAR GREENVILLE, S. C.
 SALUDS TOWNSHIP
 GREENVILLE COUNTY, S. C.

SCALE: 1" = 400'
 BOOK NO. 1116

APRIL 15, 1969
 FILE NO. 43-161