

G.P. WADE ET AL.
REF. DWG. NO. 29-182-D

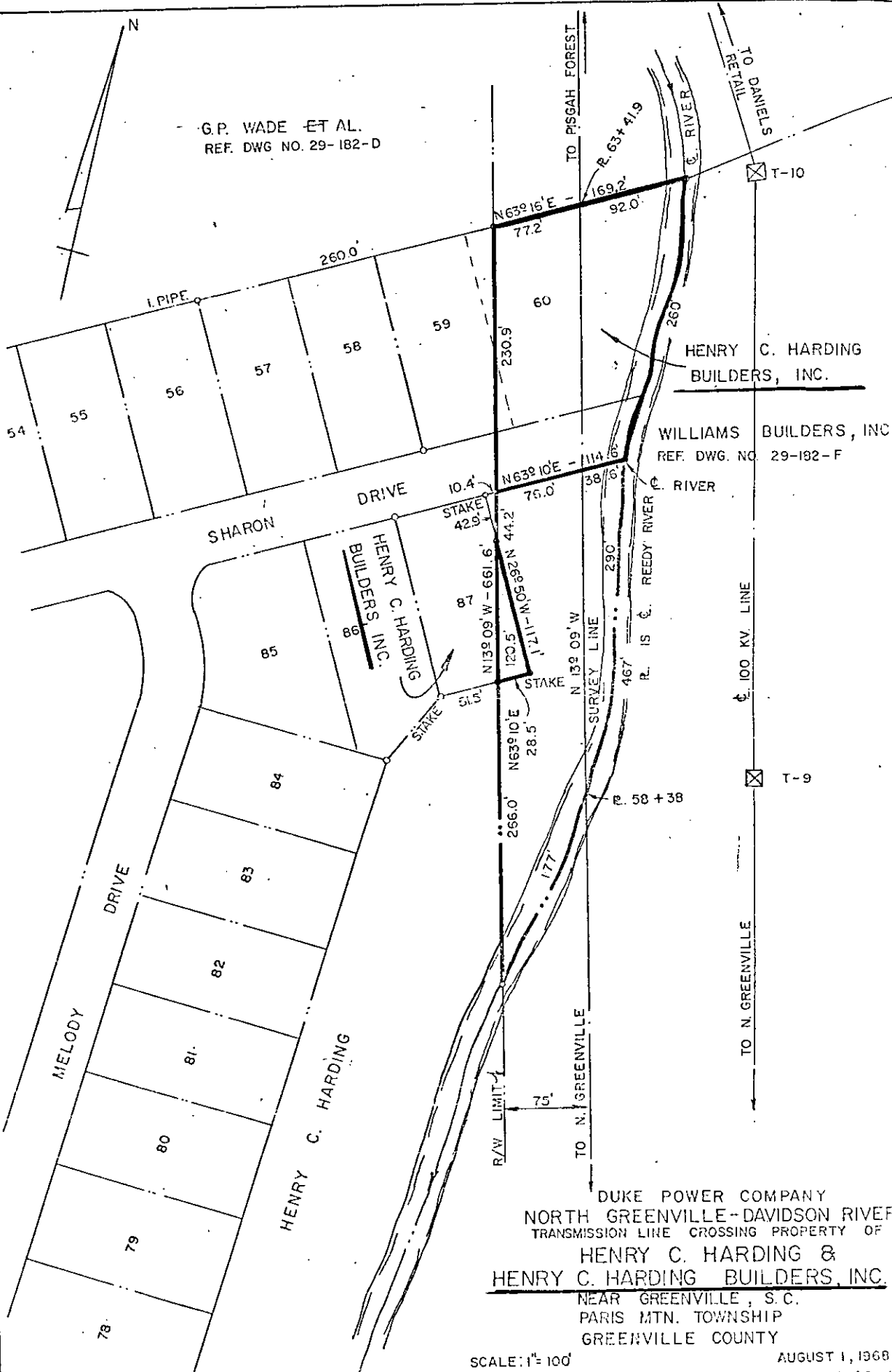

DUKE POWER COMPANY
 NORTH GREENVILLE-DAVIDSON RIVER
 TRANSMISSION LINE CROSSING PROPERTY OF
**HENRY C. HARDING &
 HENRY C. HARDING BUILDERS, INC.**
 NEAR GREENVILLE, S. C.
 PARIS MTN. TOWNSHIP
 GREENVILLE COUNTY

SCALE: 1" = 100'
 BOOK NO. 1015

AUGUST 1, 1968
 FILE NO. 32-117

Recorded Aug. 8, 1968 At 3:56 P.M. #3378