

CENTRAL REALTY CO. AND  
TIMMONS AND PATRICK PROPERTY

12 (2) 26

BOOK 846 PAGE 170

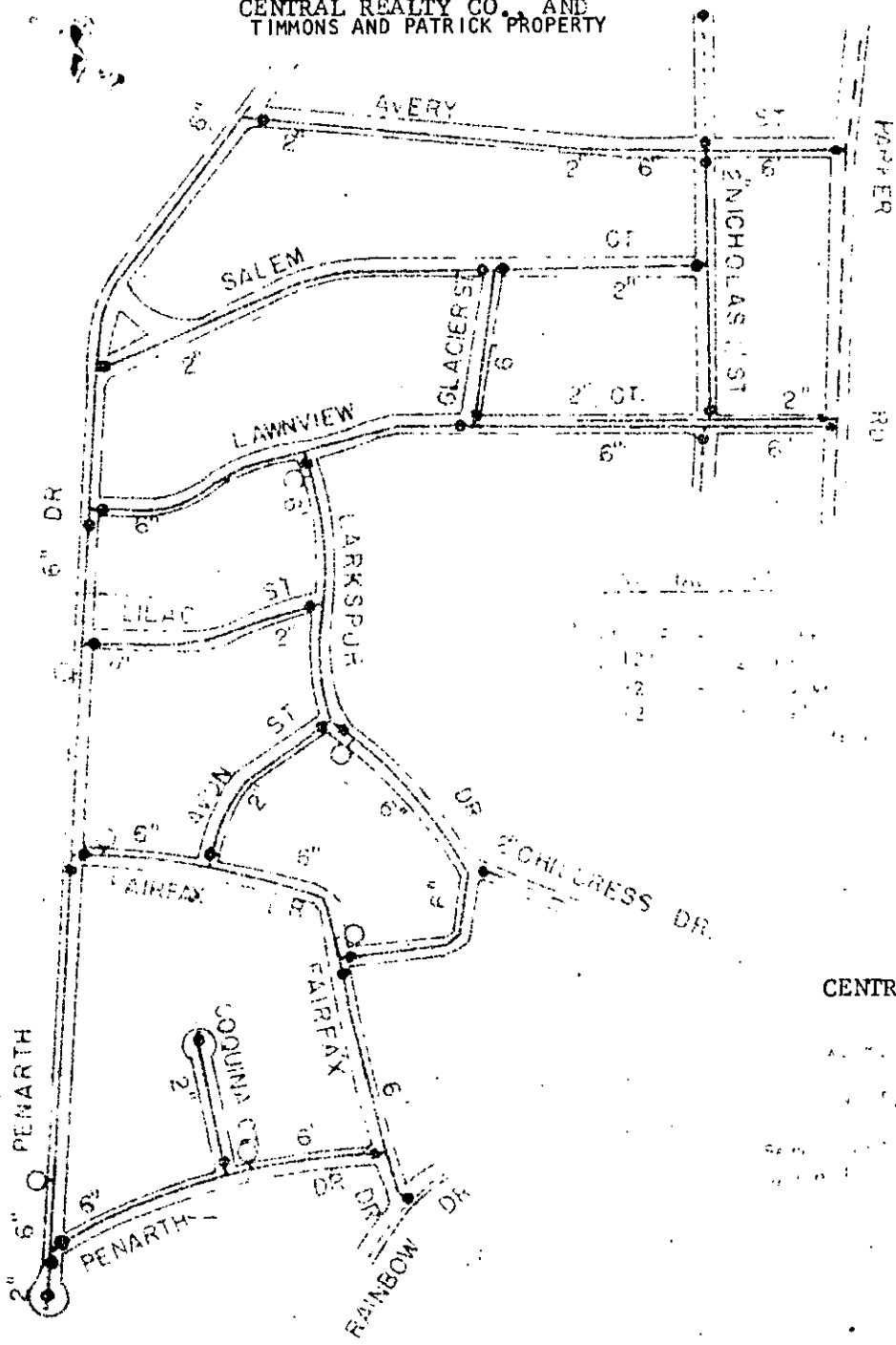

CENTRAL REALTY CO.  
&

ALVIN L. TIMMONS  
PATRICK

See Official Public District  
Map of 1967 November 1967

Recorded May 31, 1968 At 4:59 P.M. # 31138

3-12, 23, 26