

DUKE POWER COMPANY
 NORTH GREENVILLE TIE STATION
 REF DWG NO 153-137

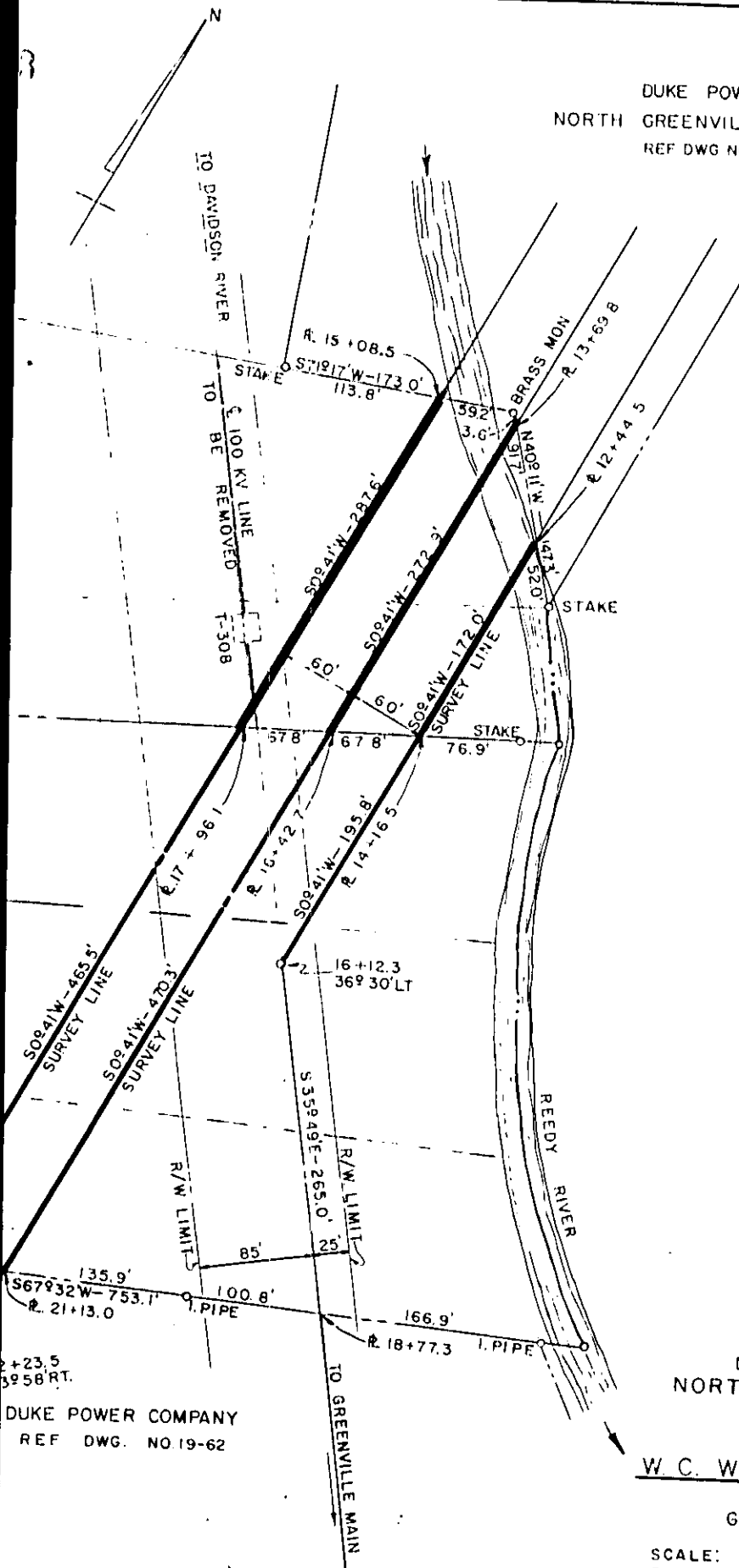

DUKE POWER COMPANY
 REF DWG. NO 19-62

DUKE POWER COMPANY
 NORTH GREENVILLE FOLD-IN
 TRANSMISSION LINES
 CROSSING PROPERTY OF
W. C. WRIGHT & L. C. CROOKS
 GREENVILLE TOWNSHIP
 GREENVILLE COUNTY, S.C.

SCALE: 1" = 100'
 BOOK NO 741
 APRIL 15, 1964
 FILE NO. 154-190

Recorded May 19, 1964 At 9:11 A.M. #32636.