

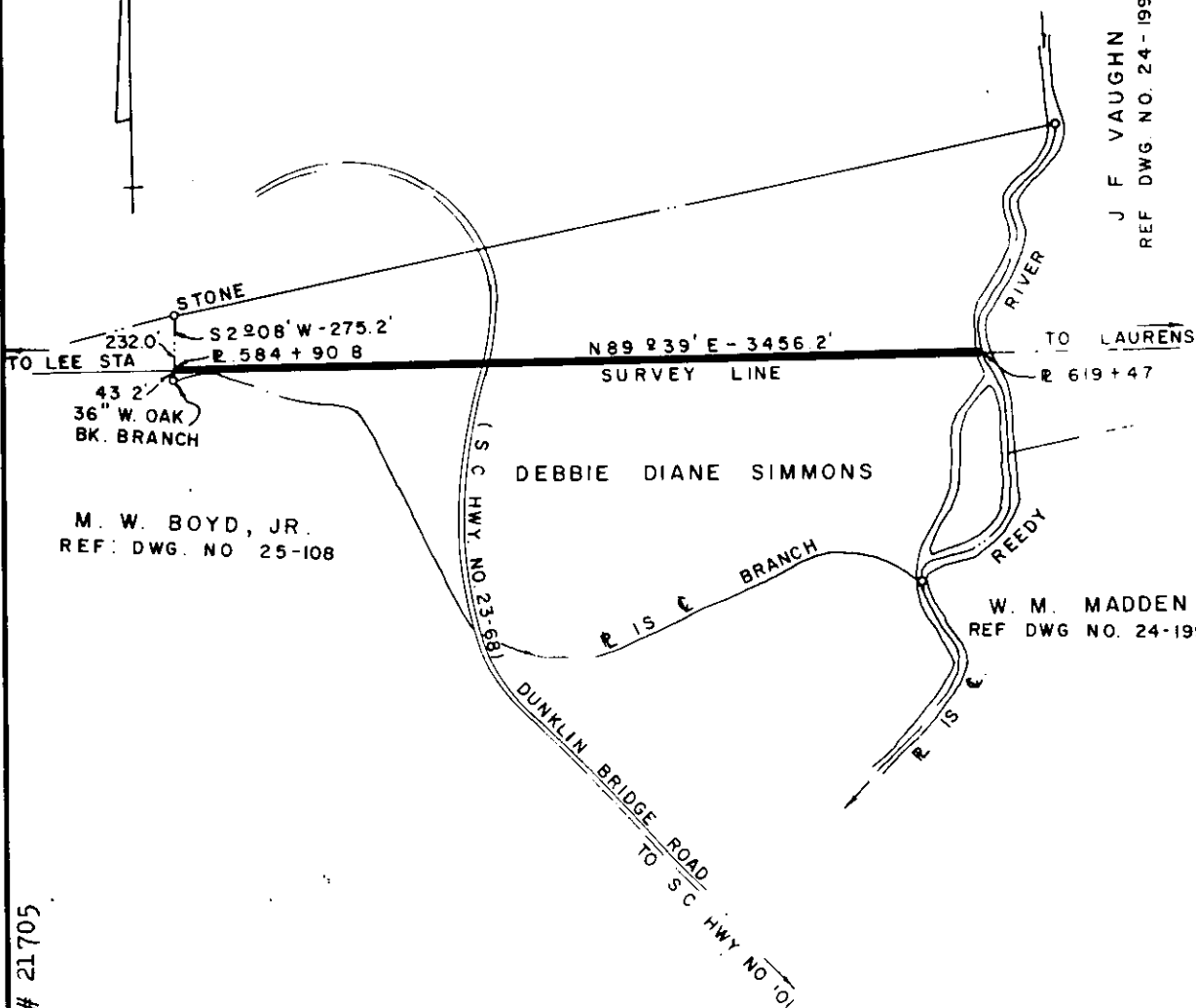

J F VAUGHN
REF DWG NO. 24-199



M. W. BOYD, JR.
REF. DWG. NO. 25-108

Recorded February 1, 1964 At 11:34 A.M. # 21705

DUKE POWER COMPANY
LEE - LAURENS
TRANSMISSION LINE
CROSSING PROPERTY OF
DEBBIE DIANE SIMMONS
DUNKLIN TOWNSHIP
GREENVILLE COUNTY, S.C.

SCALE 1" = 660'
BOOK NO 724

JANUARY 28, 1964
FILE NO. 25-159