

E. R. TAYLOR, JR.
REF DWG. NO. 154-44

PERRY W. BROWN
REF DWG. NO. 22-15

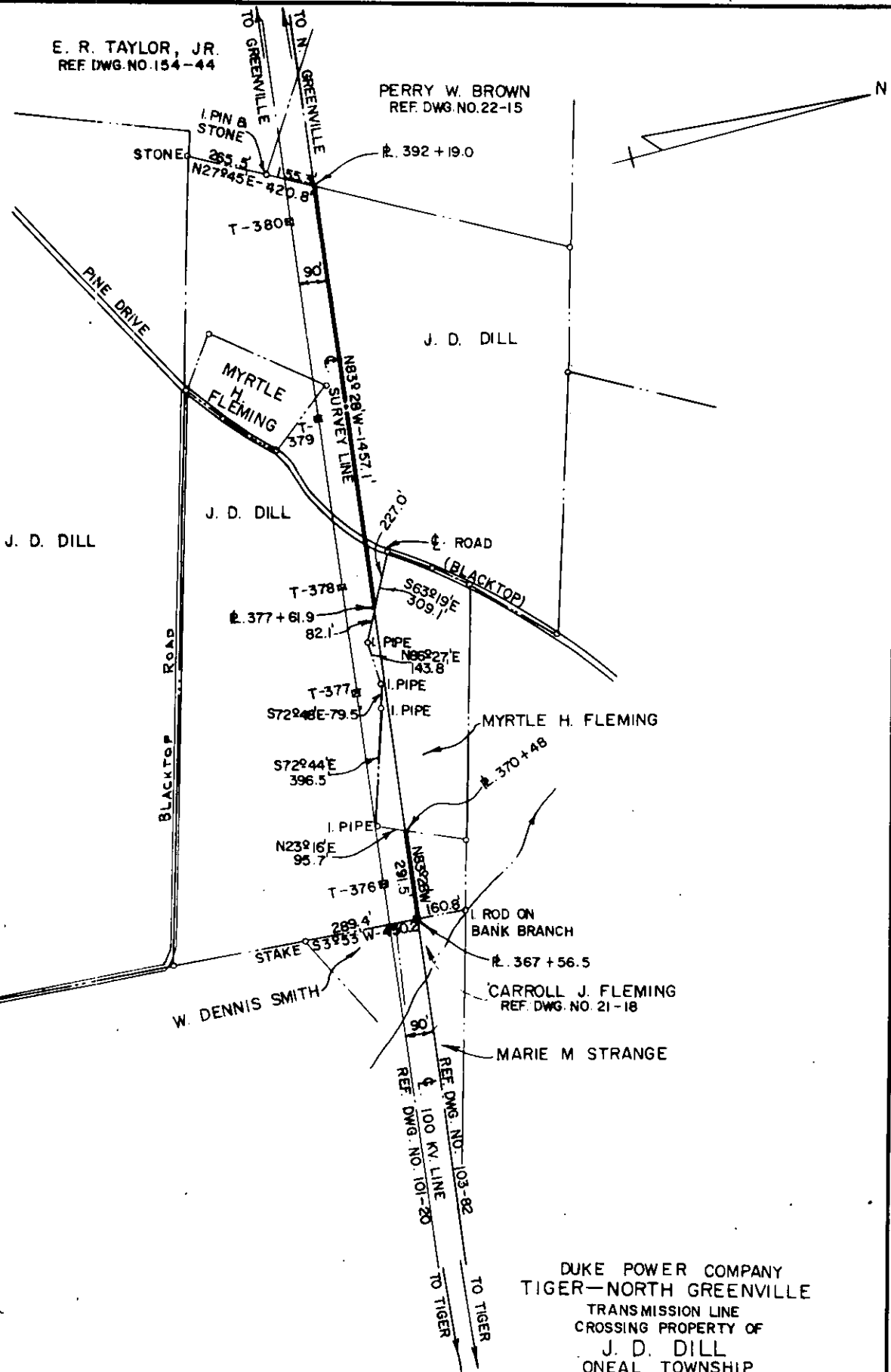

Recorded January 9, 1964 At 4:02 P.M. # 19412

DUKE POWER COMPANY
TIGER-NORTH GREENVILLE
TRANSMISSION LINE
CROSSING PROPERTY OF
J. D. DILL
ONEAL TOWNSHIP
GREENVILLE COUNTY, S.C.

SCALE: 1" = 400'
APRIL 8, 1963
BOOK NO. 627 FILE NO. 22-76