



ANSEL SCHOOL ROAD TO S.C. HWY. NO. 14

L. R. WOOD
REF. DWG. NO. 22-80

CONNIE G. MOSTELLER
REF. DWG. NO. 22-41

F. L. CHANDLER

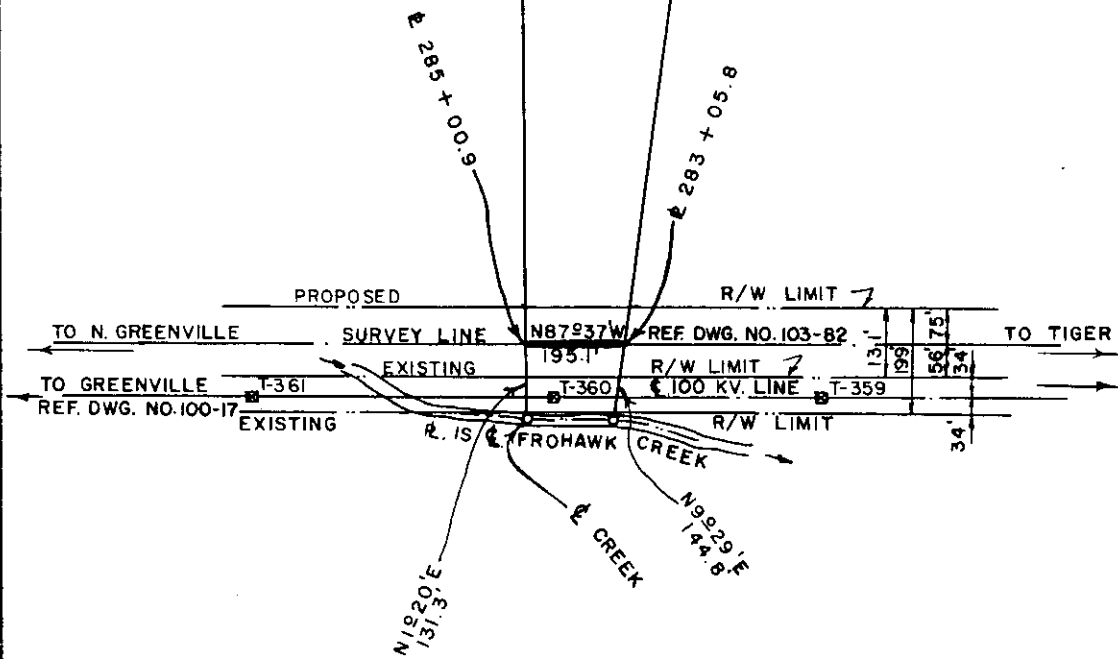

AUG 15 1963

5004

DUKE POWER COMPANY
TIGER - N. GREENVILLE
TRANSMISSION LINE
CROSSING PROPERTY OF
F. L. CHANDLER
ONEAL TOWNSHIP
GREENVILLE COUNTY, S.C.

Recorded August 15th, 1963
at 5:00 P.M. #5004

SCALE: 1" = 300'
BOOK NO. 627

JULY 17, 1963
FILE NO. 23-III